

South Coast Road, Peacehaven, BN10 7PL
Leasehold - Share of Freehold
Asking Price £229,950



Situated on the corner of Malines Avenue, this bright and well-presented two-bedroom apartment enjoys a desirable westerly-facing aspect, allowing an abundance of natural light to flood the accommodation throughout the afternoon and evening. The spacious lounge/dining room provides an excellent space for both relaxing and entertaining, while offering delightful open views across Howard Peace Park towards the English Channel.



206 South Coast Road
Peacehaven
East Sussex
BN10 8JP
01273 830 987
bnsales@localagent.co.uk

The accommodation is thoughtfully arranged and comprises a well-proportioned kitchen with ample storage and workspace, two comfortable bedrooms, a generous entrance hall with a large built-in storage cupboard, and a modern bathroom/WC fitted with a stylish white suite. The apartment's well-balanced layout creates a welcoming and practical living environment ideally suited to a range of buyers.

www.openhousebrighton.co.uk

Additional features include gas central heating, double glazing throughout, attractive and well-maintained communal gardens, and the valuable benefit of a private garage. Conveniently located close to local amenities, transport links and the seafront, this appealing property would make an excellent permanent residence, holiday home, or investment opportunity.

Lounge/Dining Room (max)
19'7" x 13'9" (5.99 x 4.21)

Kitchen
10'9" x 8'0" (3.3 x 2.46)

Bedroom One
10'9" x 9'9" (3.3 x 2.99)

Bedroom Two
8'10" x 7'7" (2.71 x 2.33)

Bathroom
6'7" x 6'1" (2.03 x 1.87)

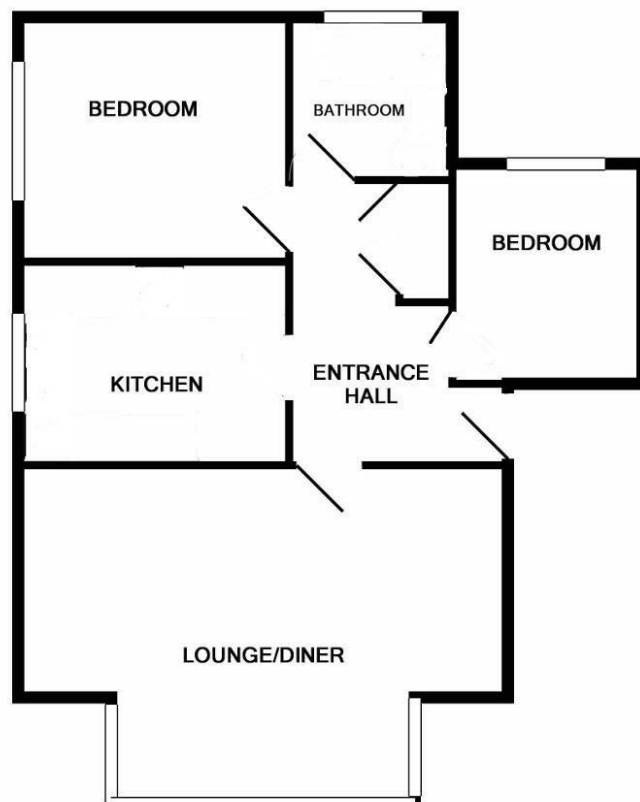

| Energy Efficiency Rating | | Current | Potential |
|---|--|-------------------------|-----------|
| Very energy efficient - lower running costs | | | |
| (92 plus) A | | | |
| (81-91) B | | | |
| (69-80) C | | | |
| (55-68) D | | 66 | 75 |
| (39-54) E | | | |
| (21-38) F | | | |
| (1-20) G | | | |
| Not energy efficient - higher running costs | | | |
| England & Wales | | EU Directive 2002/91/EC | |

