



27 CARDIFF STREET, ABERDARE, CF44 7DP

TEL: 01685 878000 FAX: 01685 878000



Fairfield Close

Cwmbach, CF44 0PF

£279,995



NO ONWARD CHAIN

Situated in the sought-after location of Fairfield Close, Cwmbach, this well presented semi-detached bungalow offers a perfect blend of comfort and tranquillity. With four spacious bedrooms, this property is ideal for families or those seeking extra space for guests or a home office. The well-appointed reception room provides a welcoming atmosphere, perfect for relaxation or entertaining with stunning mountain views.

The bungalow features a modern bathroom, ensuring convenience for all residents. One of the standout features of this property is the stunning mountain views that can be enjoyed from various vantage points, adding a touch of natural beauty to everyday living. The peaceful neighbourhood enhances the overall appeal, making it an ideal retreat from the hustle and bustle of city life.

For those with vehicles, the property offers parking for two, providing ease and accessibility. This charming bungalow is not just a home; it is a lifestyle choice, offering a serene environment while still being close to local amenities. Whether you are looking to settle down or invest in a property that promises both comfort and scenic beauty, this bungalow on Fairfield Close is a remarkable opportunity not to be missed.



Entrance Hall

UPVC Porch. UPVC Front door. Radiator x1. Storage.

Reception 15'11 x 10'10 (4.85m x 3.30m)

UPVC double glazed window to front. Radiator x1.

Kitchen 28'00 x 9'11 (8.53m x 3.02m)

UPVC double glazed patio doors and window to side. Integrated oven and gas hob. Provisions for washer and dryer. Radiator x1.

Bedroom 1 12'00 x 9'04 (3.66m x 2.84m)

UPVC double glazed window to front. Radiator x1.

Bedroom 2 9'04 x 7'11 (2.84m x 2.41m)

UPVC double glazed window to side. Radiator x1.

Bedroom 3 9'05 x 9'04 (2.87m x 2.84m)

UPVC double glazed to rear. Radiator x1.

Bathroom 6'02 x 5'05 (1.88m x 1.65m)

UPVC. Radiator x1. Vanity hand wash basin. Bath. Shower.

Landing

Skylight. Storage.

Bedroom 4 12'10 x 9'04 (3.91m x 2.84m)

Sky light. Storage. Radiator x1.

Outside

Driveway - Detached garage. Patio. Front and rear gardens. Side access.

Disclaimer

N.B Whilst these particulars are intended to give a fair description of the property concerned, their accuracy is not guaranteed and any intending purchaser must satisfy himself by inspection or otherwise, as to the correctness of statements contained herein.

The particulars do not constitute an offer or contract, and statements herein are made without responsibility, or warranty on the part of the Vendor or Manning Estate Agents, neither of whom can hold themselves responsible for expenses incurred should the property no longer be available. Items shown in photographs are NOT included unless specifically mentioned in particulars. They may however be available by separate negotiation.

The Property Misdescription Act 1991

The Agent has not tested any apparatus, equipment, fixtures and fittings or services and so cannot verify that they are in working order or fit for the purpose. A buyer is advised to obtain verification from their Solicitor or Surveyor. References to the Tenure of the property are based on information supplied by the seller. The Agent has not sight of the title documents. A Buyer is advised to obtain verification from their Solicitor.

You may download, store and use the material for your own personal use and research. You may not republish, retransmit, redistribute or otherwise make the material available to any party or make the same available on any website

These particulars, whilst believed to be accurate are set out as a general outline only for guidance and do not constitute any part of an offer or contract. Intending purchasers should not rely on them as statements of representation of fact, but must satisfy themselves by inspection or otherwise as to their accuracy. No person in this firms employment has the authority to make or give any representation or warranty in respect of the property.

27 Cardiff Street, Aberdare, CF44 7DP

Tel: 01685 878000 Email: info@manningestateagents.co.uk https://www.manningestateagents.co.uk

Area Map



Floor Plans

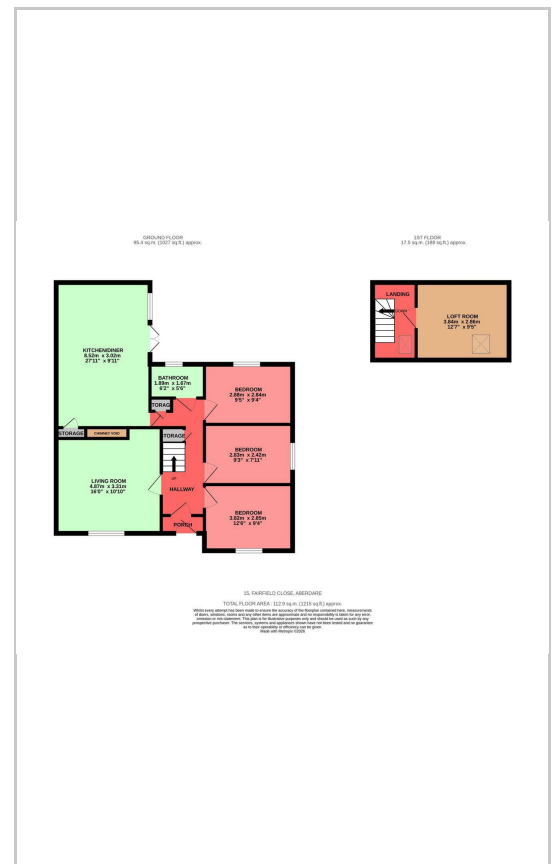

Energy Efficiency Graph

