



# ASPIRE

— TO MOVE —



## Portland Place, Bath, BA1

Three bedroom, second floor flat, located at Portland Place. Suitable for students and sharers and available 8th August 2026.

The flat is located on Portland Place, just 0.5 miles from central locations like Queens Square. Julian Rd convenience stores are just 0.1 miles away.

**£2,400 PCM**

# Portland Place, Bath, BA1

- Suitable for students or sharers
- Three double bedrooms
- Second floor flat
- Holding deposit £553
- Unfurnished
- Central location
- Council tax band D if applicable
- Available 8th August

Three bedroom, second floor flat, located at Portland Place. Suitable for students and sharers and available 8th August 2026.

The flat is located on Portland Place, just 0.5 miles from central locations like Queens Square. Julian Rd convenience stores are just 0.1 miles away.

The flat is accessed on the second floor and runs from front to back of the building. At the front of the flat is the large open plan, kitchen living room, with double aspect windows which makes it nice and bright. The kitchen is fitted with wall and base units, hob and oven and fridge. Next to the living room is bedroom number one which is a double room. Halfway down the corridor towards the rear is the bathroom. Fitted with a shower over the bath, toilet, basin and heated towel rail. Bedrooms two and three are located at the rear of the property and are also double bedrooms.

The flat is ideally suited to three sharers or students and available from the 8th August. Please note the property is offered unfurnished.

Council tax band D: £2325.27 if applicable





SECOND FLOOR  
777 sq.ft. (72.1 sq.m.) approx.

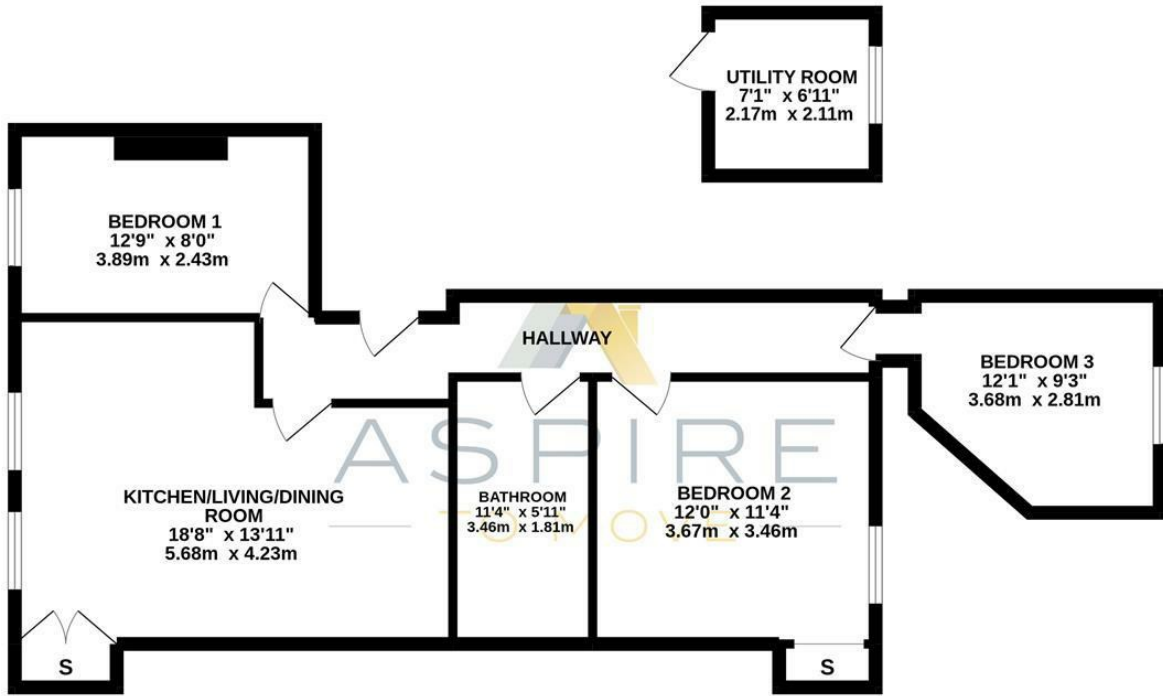

PORTLAND PLACE, BATH, BA1

TOTAL FLOOR AREA : 777 sq.ft. (72.1 sq.m.) approx.

Whilst every attempt has been made to ensure the accuracy of the floorplan contained here, measurements of doors, windows, rooms and any other items are approximate and no responsibility is taken for any error, omission or mis-statement. This plan is for illustrative purposes only and should be used as such by any prospective purchaser. The services, systems and appliances shown have not been tested and no guarantee as to their operability or efficiency can be given.  
Made with Metropix ©2022

These particulars, whilst believed to be accurate are set out as a general outline only for guidance and do not constitute any part of an offer or contract. Intending purchasers should not rely on them as statements of representation of fact, but must satisfy themselves by inspection or otherwise as to their accuracy. No person in this firm's employment has the authority to make or give any representation or warranty in respect of the property.

