



Beaufort Gardens, SW3 | £5,000 Per Month



TUCKERMAN
ESTATE AGENTS
PROPERTY PROFESSIONALS

Beaufort Gardens, Knightsbridge

An elegant two bedroom top floor apartment situated within a handsome period building on Beaufort Gardens, one of Knightsbridge's most desirable addresses.

Extending to approximately 603 sq ft, the apartment is beautifully presented and offers well arranged accommodation with a particularly bright and generous reception room. Positioned on the top floor, the property enjoys an excellent sense of light and privacy, creating a calm and comfortable home in the heart of Prime Central London.

The accommodation comprises a spacious reception room, separate kitchen, two double bedrooms and a well appointed bathroom. The layout is practical and well proportioned, making the apartment ideally suited to tenants seeking a stylish London home in an exceptional location.

Beaufort Gardens is superbly positioned moments from the world class shops, restaurants and amenities of Knightsbridge, including Harrods, Brompton Road and Sloane Street. Hyde Park, South Kensington and Chelsea are also within easy reach, offering a rare combination of convenience, elegance and lifestyle appeal.





Beaufort Gardens, Knightsbridge

Available

Per Month: £5,000 Per Month

Furnishing: Furnished

Available From: 15th May 2026

Local Authority: Royal Borough of
Kensington and Chelsea

Council Tax Band: G

Approximate Gross Internal Area:
602.78 sq ft

Energy Efficiency Rating		Current	Potential
<i>Very energy efficient - lower running costs</i>			
(92 plus) A			
(81-91) B			
(69-80) C			75
(55-68) D			
(39-54) E		51	
(21-38) F			
(1-20) G			
<i>Not energy efficient - higher running costs</i>			
England & Wales	EU Directive 2002/91/EC		

Beaufort Gardens

Approximate Gross Internal Area = 652 sq ft / 60.6 sq m

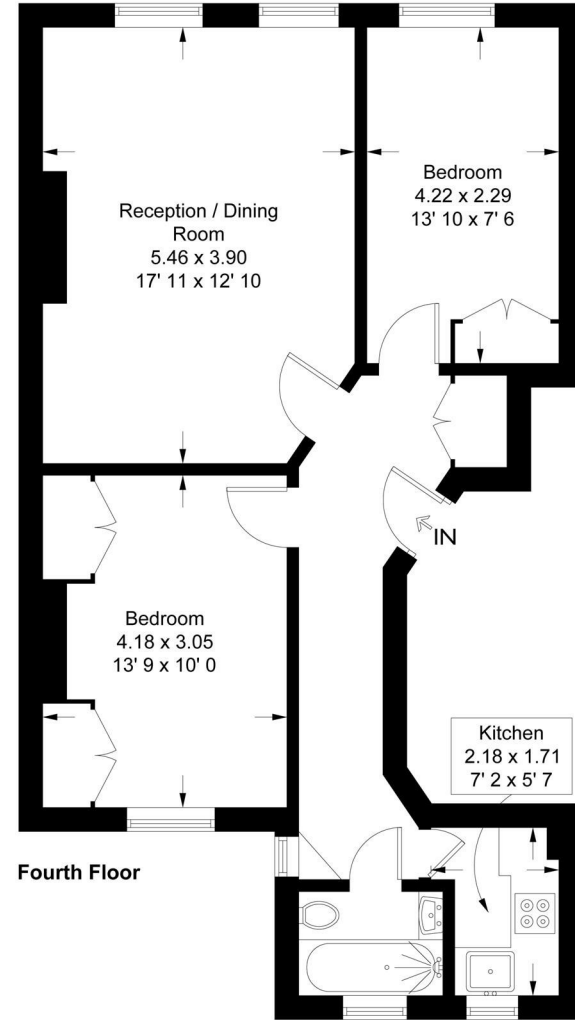

This plan is not to scale and must be used as layout guidance only. All measurements and areas are approximate and should not be relied upon to provide accurate information. This plan must not be relied upon when making property valuations, design considerations or any other such relevant decisions. We accept no responsibility or liability (whether in contract, tort or otherwise) in relation to any loss whatsoever arising from or in connection with any use of this plan or the adequacy, accuracy or completeness of it or any information within it.

020 7222 5510

info@tuckermanresidential.co.uk
52 Moreton Street, London, SW1V 2PB
www.tuckermanresidential.co.uk

Agents Note: Whilst every care has been taken to prepare these sales particulars, they are for guidance purposes only. All measurements are approximate are for general guidance purposes only and whilst every care has been taken to ensure their accuracy, they should not be relied upon and potential buyers are advised to recheck the measurements

TUCKERMAN
ESTATE AGENTS
PROPERTY PROFESSIONALS