



Barttelot Road, Horsham, West Sussex, RH12

Offers Over £225,000

🛏 1 🚿 1 🚗 1



- Virtual Tour Available
- Double bedroom
- Modern Shower Room
- Secluded Garden
- Off Street Parking
- Share Of Freehold
- Lounge/Dining Room
- Town Centre Location
- Beautifully Presented



Clickmymove.com are proud to present this beautifully presented one-bedroom ground-floor maisonette in Horsham, featuring its own private entrance, a bright and spacious living area, and a well-equipped kitchen. The property further benefits from a private rear garden with shed, a share of the freehold, and is ideally located within walking distance of Horsham railway station and the town centre.



Barttelot Road, Horsham, RH12

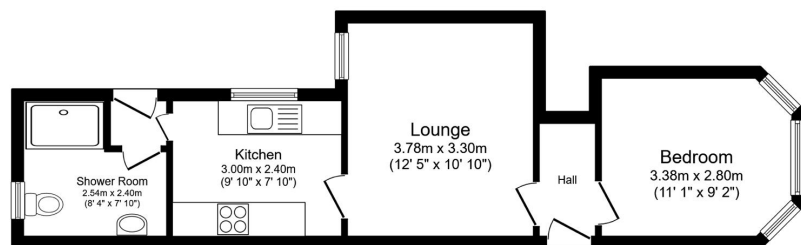

Floor Plan
Floor area 37.7 sq.m. (406 sq.ft.)

Total floor area: 37.7 sq.m. (406 sq.ft.)

This floor plan is for illustrative purposes only. It is not drawn to scale. Any measurements, floor areas (including any total floor area), openings and orientations are approximate. No details are guaranteed, they cannot be relied upon for any purpose and do not form any part of any agreement. No liability is taken for any error, omission or misstatement. A party must rely upon its own inspection(s). Powered by www.propertybox.co

Energy Efficiency Rating		
	Current	Potential
<i>Very energy efficient - lower running costs</i>		
(92 plus) A		
(81-91) B		
(69-80) C		72
(55-68) D	61	
(39-54) E		
(21-38) F		
(1-20) G		
<i>Not energy efficient - higher running costs</i>		
England & Wales	EU Directive 2002/91/EC	

01403 586012 - Horsham office
01293 365031 - Crawley office

9 Church Road, Horsham, RH12 4NN
help@Clickmymove.com

