



34 Ravensdale Road, Dronfield Woodhouse, Dronfield, Derbyshire, S18

Saxton Mee

34 Ravensdale Road

Dronfield Woodhouse

£250,000

This stylishly presented two double bedroomed semi detached house has been attractively refurbished over recent years and stands on what must be one of the largest plots on the development for this type of property having the benefit of a very good sized rear garden with new patio.

Most conveniently located only a few hundred metres from the excellent nearby park, good range of shops including doctors and pharmacy and renowned infants/junior school the property has had a brand new bathroom in 2023, brand new radiators at the same time when the wiring was also fully overhauled. Offering gas fired central heating via an Ideal combination boiler installed in 2026, uPVC double glazing the property is equally ideal for a first time buyer, couple or retired and briefly comprises: side entrance hall, superb reimagined dining kitchen, stunning living room with feature slat walling, landing with access to the partially boarded loft space, two double bedrooms and a superb new bathroom with thermostatically controlled shower over the bath.

Broad re- tarmac driveway provides ample off road parking. Very good size attractively set out garden mainly to lawn with a new patio against the back elevation.



- Stunning two double bedroomed semi detached house
- Superb corner plot with large rear garden
- Potential to extend subject to usual consents
- Stylish new bathroom in Jan/Feb 2023
- Gas fired combination boiler and uPVC double glazing
- New radiators and overhauled wiring in 2023
- Drive re-tarmaced in recent years
- Brand new flooring (wooden downstairs and carpets upstairs) Feb 2023
- Viewing highly advised
- EPC: D Tenure: Council Tax Band:



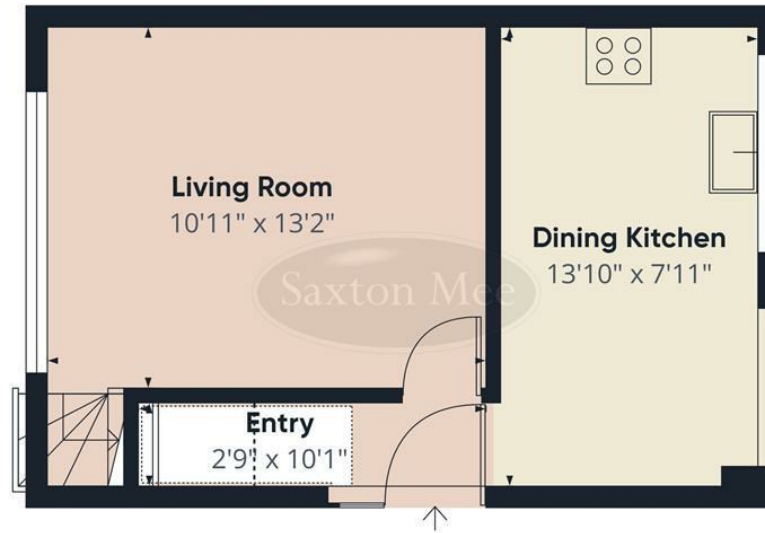

Floor 0

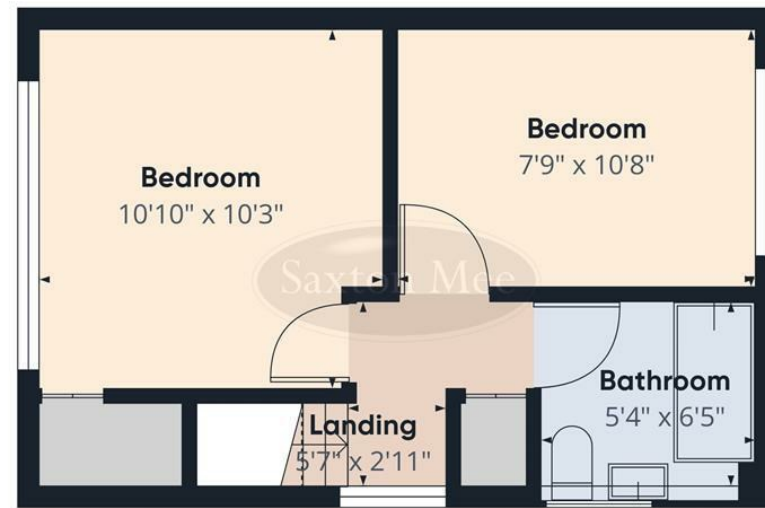

Floor 1



Approximate total area⁽¹⁾
566 ft²
Reduced headroom
9 ft²

(1) Excluding balconies and terraces

Reduced headroom
..... Below 5 ft

Calculations reference the RICS IPMS 3C standard. Measurements are approximate and not to scale. This floor plan is intended for illustration only.

GIRAFFE360

While we endeavour to make our sales particulars fair, accurate and reliable, they are only a general guide to the property and, accordingly, if there is any point, which is of particular importance to you, please contact the relevant office. The Agents have not tested any apparatus, equipment, fittings or services and so cannot verify they are in working order. The buyer is advised to obtain verification. Please note all the measurement details are approximate and should not be relied upon as exact. All plans, floor plans and maps are for guidance purposes only and are not to scale. Under no circumstances should they be relied upon as exact or for use in planning carpets and other such fixtures, fittings or furnishings. YOUR HOME IS AT RISK IF YOU DO NOT KEEP UP REPAYMENTS ON A MORTGAGE OR OTHER LOAN SECURED ON IT. *A Life Assurance policy may be requested.* *Written Quotations of credit terms available on request.*

Banner Cross
T: 0114 268 3241
E: bannercross@saxtonmee.co.uk
www.saxtonmee.co.uk

Dronfield
T: 01246 290992
E: dronfield@saxtonmee.co.uk

Hathersage
T: 01433 650009
E: hathersage@saxtonmee.co.uk

Bakewell
T: 01629 815307
E: bakewell@saxtonmee.co.uk

Matlock
T: 01629 828250
E: matlock@saxtonmee.co.uk

