

EDEN MIDCALF
— SALES & LETTINGS —

£129,000
Mill Brook Meadow

Kinver, DY7 6FD

PROPERTY SUMMARY

*** £129,000 FOR 45% SHARE *** A two bedroom shared ownership semi-detached house constructed in 2022 by Severn Homes. Pleasantly located in a sought after cul-de-sac location and just a short distance from amenities in historic Kinver village. The property offers a well proportioned and attractively appointed layout that is "ready to move into", including a spacious lounge/dining room, a kitchen with integrated appliances and two double bedrooms. The property also includes off-road parking for two cars and a patio/lawn rear garden, which enjoys an attractive open rear aspect. EPC=B

2



1



1





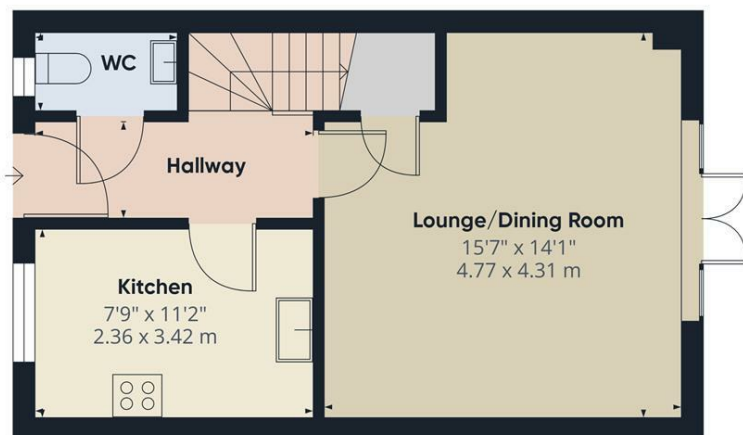

Ground Floor

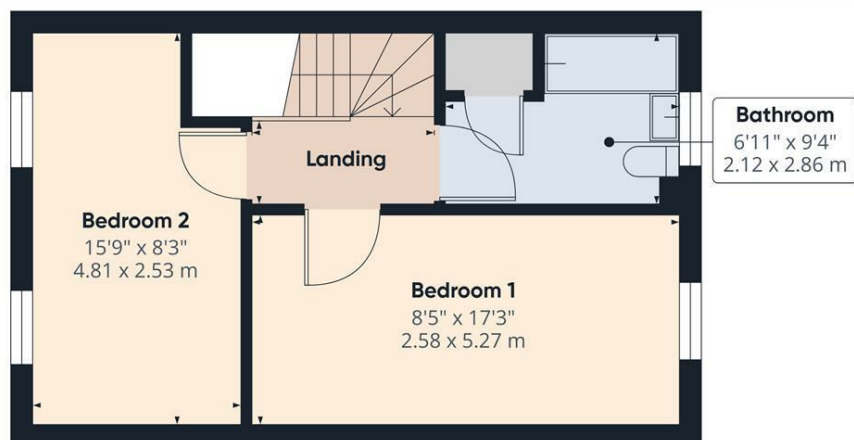

Floor 1

Approximate total area⁽¹⁾
756 ft²
70.2 m²

(1) Excluding balconies and terraces

Calculations reference the RICS IPMS 3C standard. Measurements are approximate and not to scale. This floor plan is intended for illustration only.

GIRAFFE360

LOCAL AUTHORITY

TENURE

Leasehold

COUNCIL TAX BAND

C

VIEWINGS

By prior appointment only

Energy Efficiency Rating		
	Current	Potential
Very energy efficient - lower running costs		
(92 plus) A		96
(81-91) B	84	
(69-80) C		
(55-68) D		
(39-54) E		
(21-38) F		
(1-20) G		
Not energy efficient - higher running costs		
England & Wales	EU Directive 2002/91/EC	

Agents Note: Whilst every care has been taken to prepare these particulars, they are for guidance purposes only. All measurements are approximate and are for general guidance purposes only and whilst every care has been taken to ensure their accuracy, they should not be relied upon and potential buyers/tenants are advised to recheck the measurements.

EDEN MIDCALF
— SALES & LETTINGS —

28 High Street
Kinver
DY7 6HF

01384 878000

<https://www.edenmidcalf.co.uk/us/>