



Musgrove Road, SE14

£325,000

A beautifully presented one-bedroom split-level apartment with a share of freehold, set within the sought-after Telegraph Hill Conservation Area. Boasting impressive high ceilings and a bright, spacious layout.

Situated in the highly regarded Telegraph Hill Conservation Area, the property enjoys an excellent location within easy walking distance of New Cross Gate and Brockley stations, offering convenient Overground and National Rail connections across London. Residents also benefit from the beautiful open spaces of Telegraph Hill Upper and Lower Parks, along with a great selection of independent cafés, restaurants, shops and local amenities nearby, making this a vibrant and well-connected place to call home.

Features

- One bedroom
- Conservation area
- Split level
- Share of freehold
- Excellent condition
- Close proximity to transport links

Musgrove Road, London, SE14

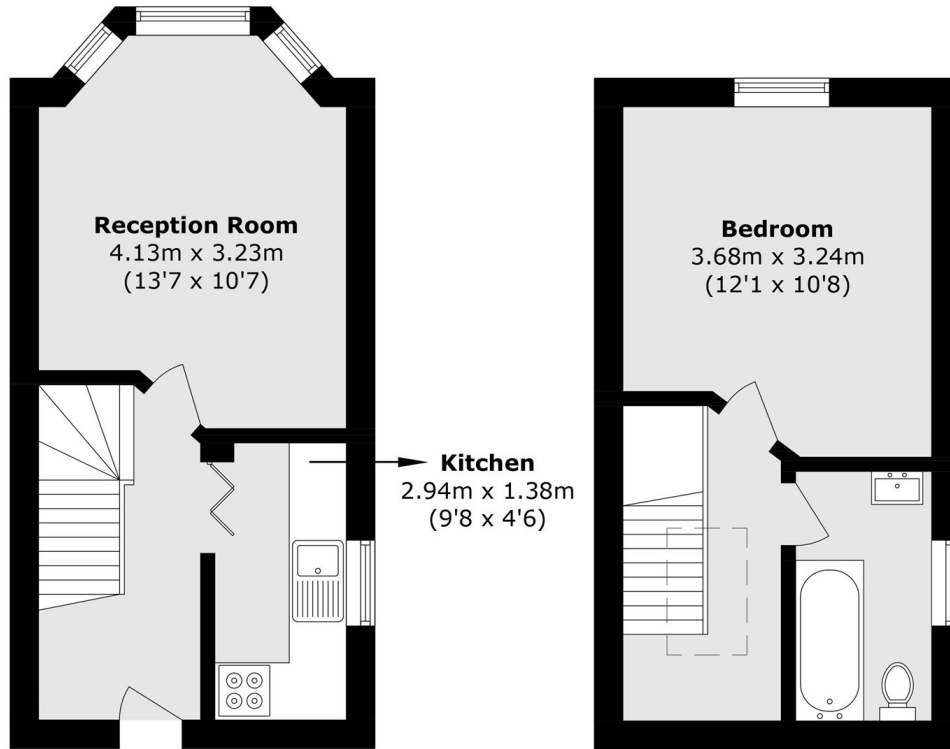

First Floor

Second Floor

Total area (approx.): 43.2 sq. m (465.0 sq. ft)