



**1 Bed  
Maisonette  
located in London**

£2,000 PCM



**Ground Floor**  
Approx. 43.5 sq. metres (467.9 sq. feet)

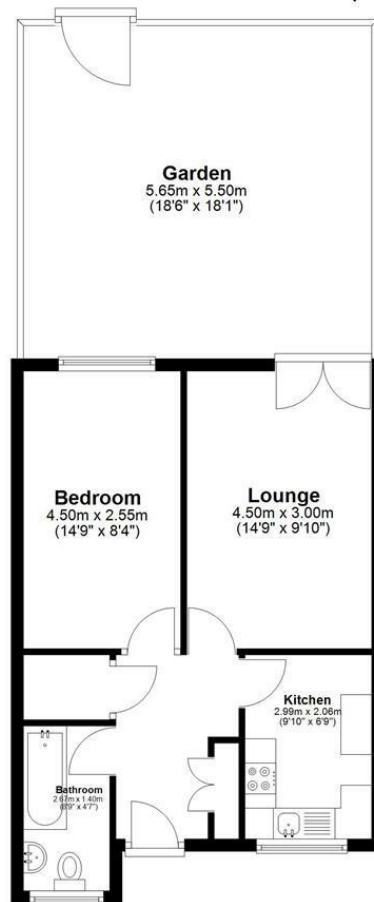

Total area: approx. 43.5 sq. metres (467.9 sq. feet)

This floor plan has been created by a third party and should be used as a general outline for guidance only. Any areas, measurements or distances quoted are approximate and any intending purchaser or lessee should satisfy themselves by inspection, searches, enquiries and/or full survey as to the correctness of each statement. We accept no responsibility or liability for any loss whatsoever that may arise as a result of this plan and the information contained within.

@modephoto.uk | www.modephoto.co.uk  
Plan produced using PlanUp.□

**Clapham Park Rd**

**DIRECTIONS**

**CONTACT**

1-3 Old Town  
Clapham  
London  
SW4 0JT

E: [lettings@orlandoreid.co.uk](mailto:lettings@orlandoreid.co.uk)  
T: 020 7627 3197  
[www.orlandoreid.co.uk](http://www.orlandoreid.co.uk)

