



THE GREEN, W5

£350,000

This well-presented, upper floor flat nestled in the heart of Ealing Broadway, an ideal purchase for a first-time buyer or investor due to its desirable location.

One bedroom
On street permit parking
Great transport links

Heart of Ealing Broadway
Close to Walpole Park
Energy rating: c

STEP INSIDE THE GREEN

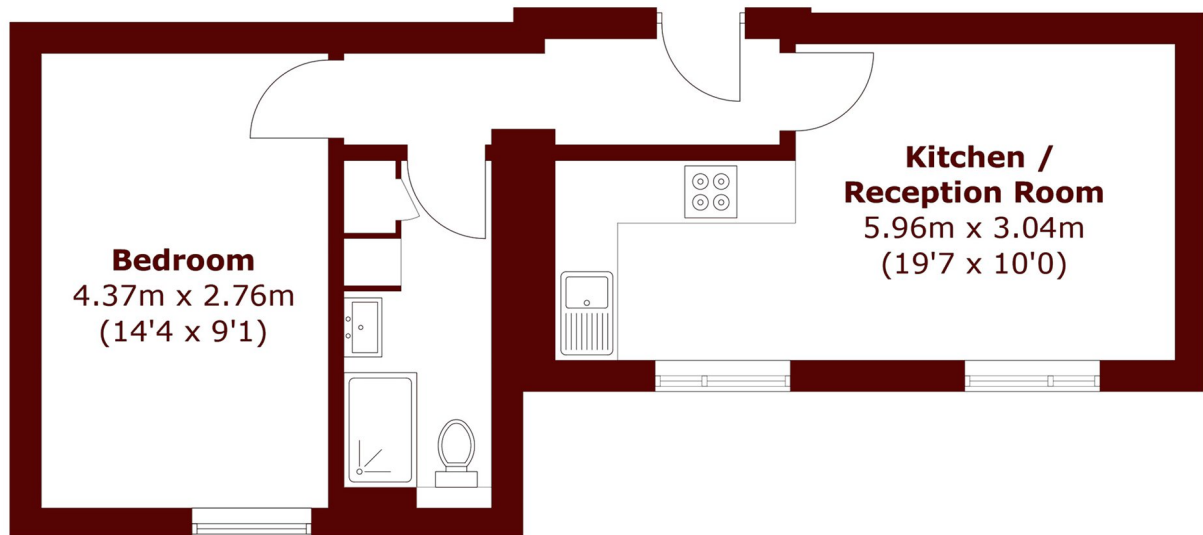

Total area (approx.): 39.1 sq. m (420.1 sq. ft)

Chiswick
020 8994 2556

Energy Rating: C We aim to make our particulars both accurate and reliable. However, they are not guaranteed; nor do they form part of an offer or contract. If you require clarification on any points then please contact us, especially if you're traveling some distance to view. Please note that appliances and heating systems have not been tested and therefore no warranties can be given as to their good working order

MARSH &
PARSONS