

BROTHERS

PROPERTY MANAGEMENT



First Floor Flat 116 Edith Road

London, W14 9AP

£2,000 Per month

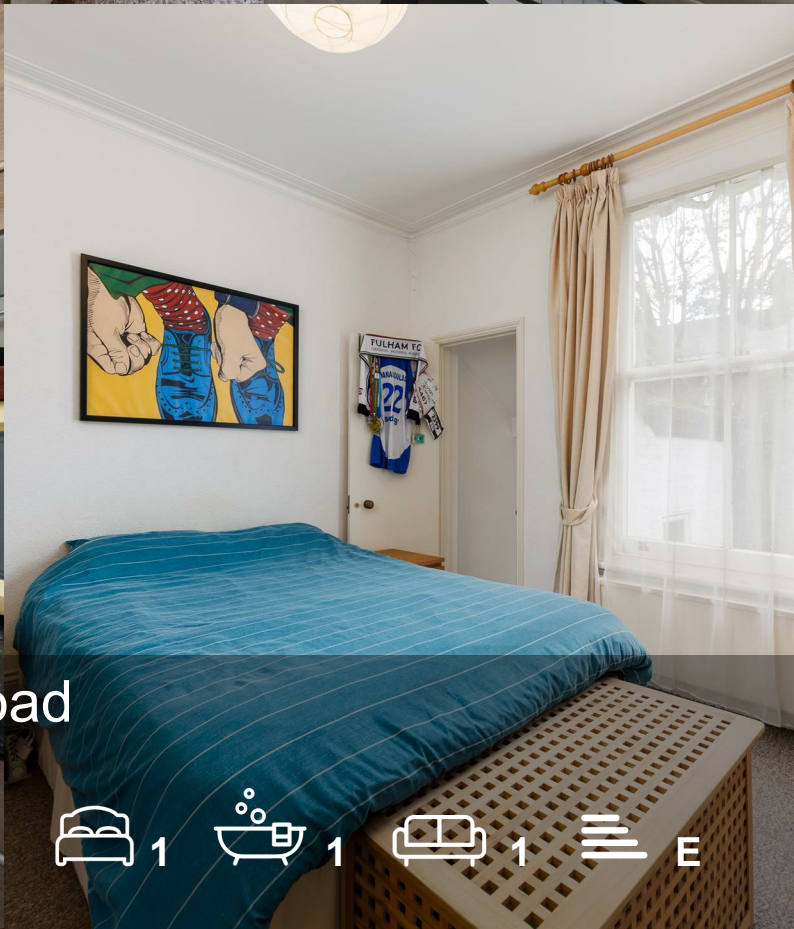

Floor Plan

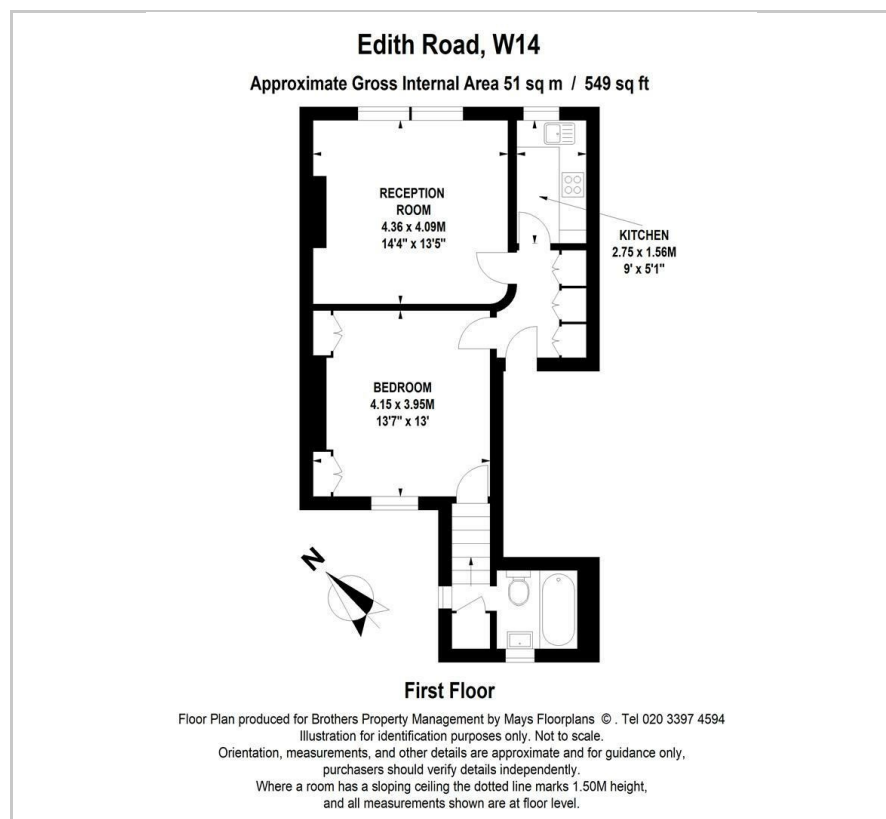

Area Map

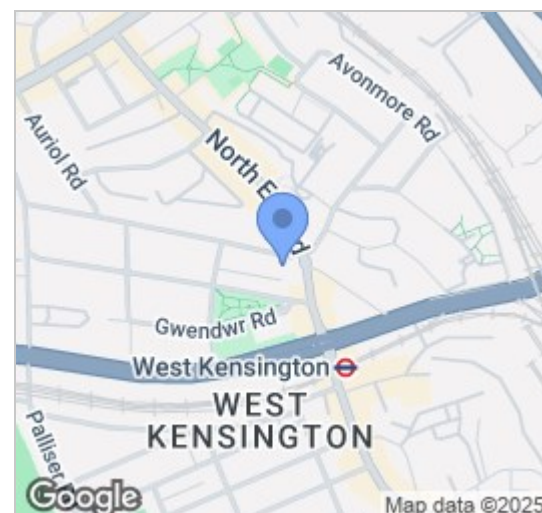

Energy Efficiency Graph

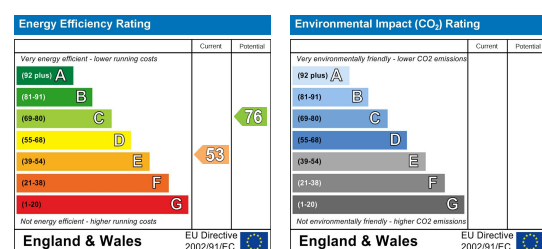

Viewing

Please contact our Brothers Property Management Office on 020 4526 6150 if you wish to arrange a viewing appointment for this property or require further information.

- First Floor Flat
- Separate Kitchen
- Large Windows
- Professionally Managed
- Very Convenient Location
- Large One Bedroom Flat
- High Ceilings
- Furnished/Part-Furnished
- Ample Fitted Storage

A spacious one bedroom flat on the first floor in a very convenient location.



These particulars, whilst believed to be accurate are set out as a general outline only for guidance and do not constitute any part of an offer or contract. Intending purchasers should not rely on them as statements of representation of fact, but must satisfy themselves by inspection or otherwise as to their accuracy. No person in this firm's employment has the authority to make or give any representation or warranty in respect of the property.