

**RUSH
WITT &
WILSON**



**27 Woodspring Close, St. Leonards-on-Sea, TN37 7LT
£250,000 Freehold**

Nestled in the charming area of Woodspring Close, this delightful two-bedroom mid-terrace house presents an excellent opportunity for first-time buyers. The property boasts a generously sized living room, providing a warm and inviting space for relaxation and entertaining. At the rear, you will find a modern kitchen/diner that is both stylish and functional, featuring French double doors that open seamlessly into the garden. The outdoor space is perfect for enjoying sunny days or hosting gatherings with friends and family. The main bedroom is a true highlight, complete with fitted wardrobes offering ample storage while maintaining a clean and contemporary feel. Additionally, the modern shower room adds a touch of comfort and practicality to this well presented home. Conveniently located, this property benefits from excellent local amenities nearby, including shops, everyday conveniences, and transport links. Families will also appreciate the close proximity to well regarded local primary schooling in the Little Ridge area, while the property is ideally positioned for easy access to Conquest Hospital, making it a practical choice for a range of buyers. With its appealing features, modern presentation, and sought after location, this lovely mid terrace home is perfectly suited to those looking to take their first step onto the property ladder or settle into a welcoming community. Early viewing is highly recommended to fully appreciate all that this home has to offer.





RUSH
WITT &
WILSON



RUSH
WITT &
WILSON



RUSH
WITT &
WILSON



RUSH
WITT &
WILSON

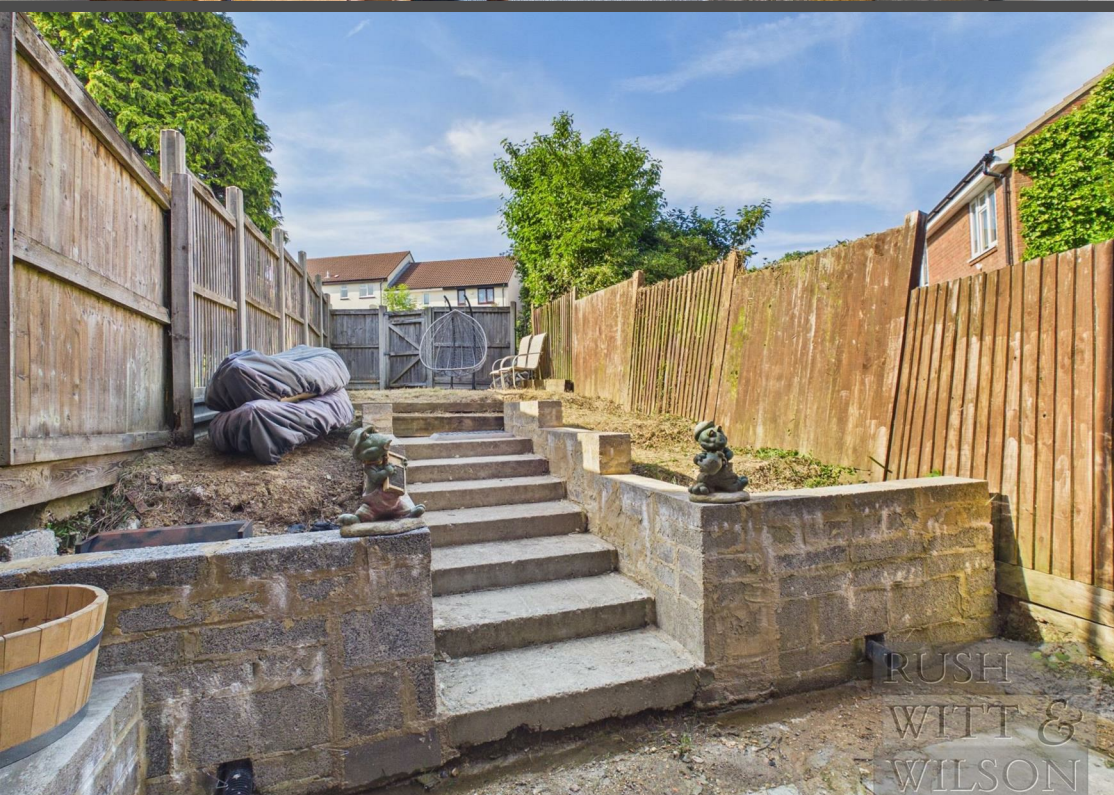

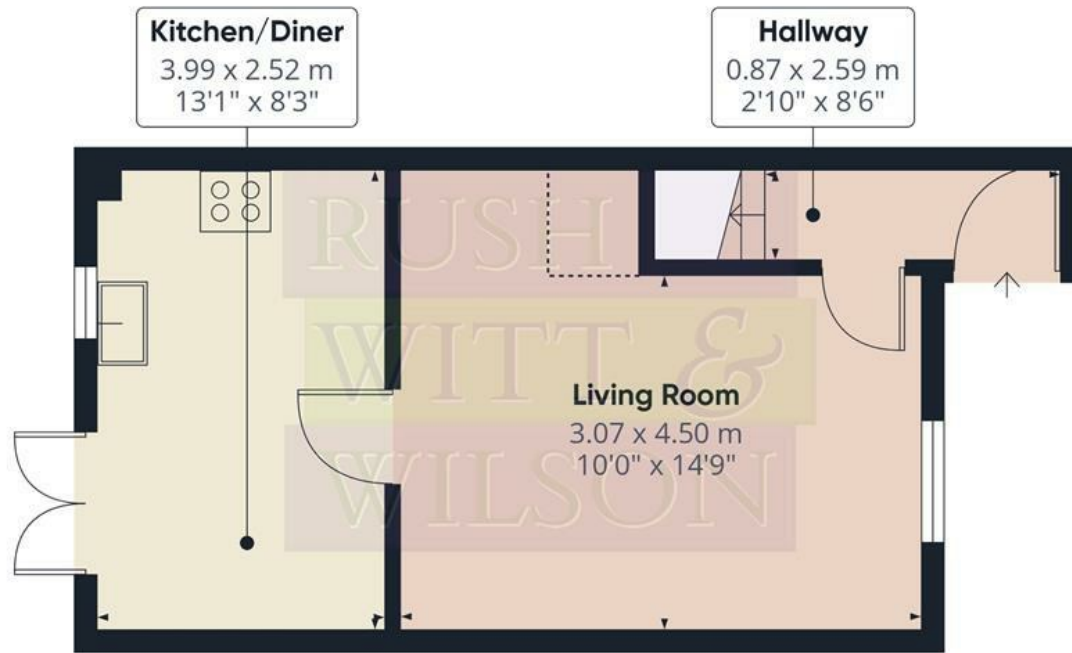

Floor 0



Floor 1



Approximate total area⁽¹⁾

54.4 m²

586 ft²

Reduced headroom

0.6 m²

6 ft²

(1) Excluding balconies and terraces

Reduced headroom

----- Below 1.5 m/5 ft

Calculations reference the RICS IPMS 3C standard. Measurements are approximate and not to scale. This floor plan is intended for illustration only.

GIRAFFE360

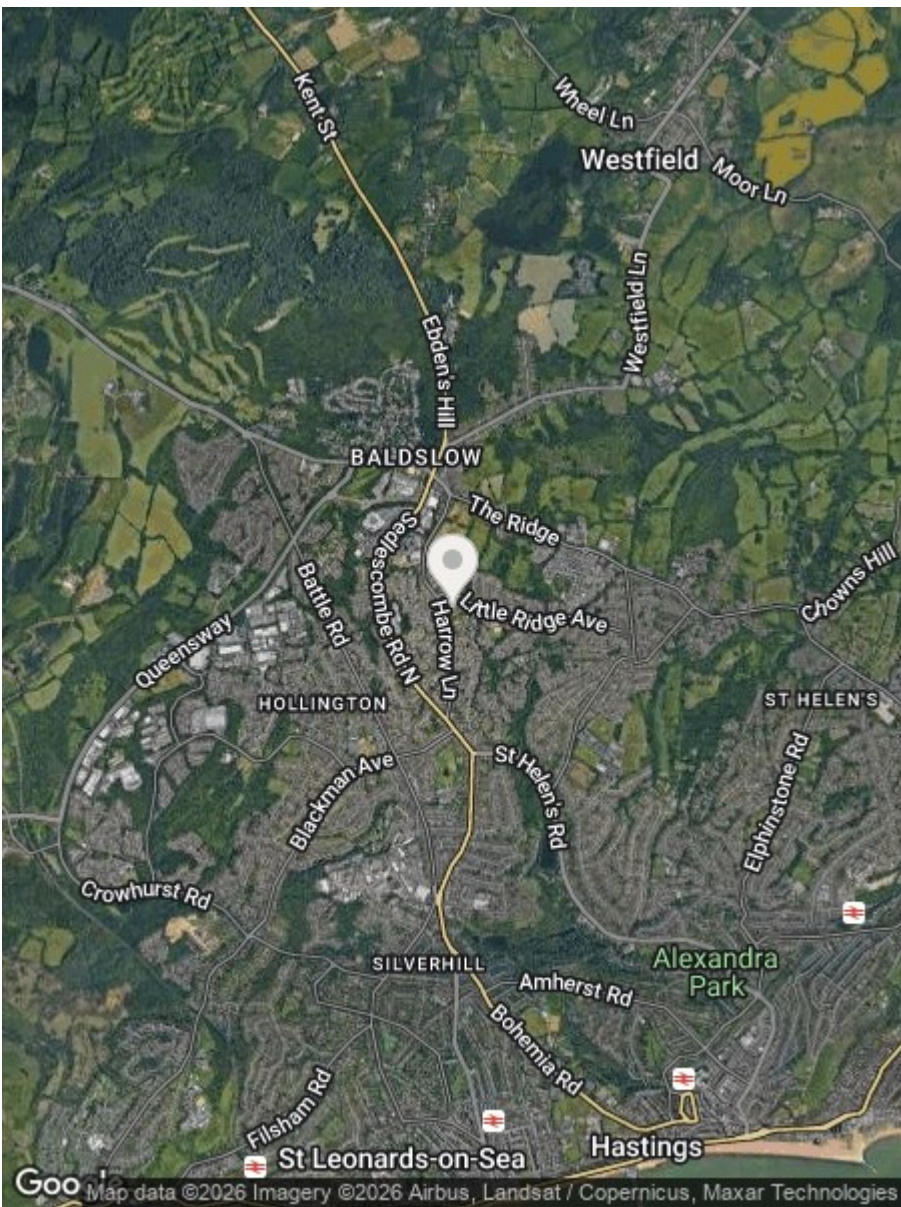

Energy Efficiency Rating		Current	Potential
Very energy efficient - lower running costs			
(92 plus) A			92
(81-91) B			
(69-80) C		75	
(55-68) D			
(39-54) E			
(21-38) F			
(1-20) G			
Not energy efficient - higher running costs			
England & Wales		EU Directive 2002/91/EC	

Environmental Impact (CO ₂) Rating		Current	Potential
Very environmentally friendly - lower CO ₂ emissions			
(92 plus) A			
(81-91) B			
(69-80) C			
(55-68) D			
(39-54) E			
(21-38) F			
(1-20) G			
Not environmentally friendly - higher CO ₂ emissions			
England & Wales		EU Directive 2002/91/EC	

Council Tax Band - B

Fixtures and fittings: A list of the fitted carpets, curtains, light fittings and other items fixed to the property which are included in the sale (or may be available by separate negotiation) will be provided by the Seller's Solicitors.

Important Notice:

1. Particulars: These particulars are not an offer or contract, nor part of one. You should not rely on statements by Rush, Witt & Wilson in the particulars or by word of mouth or in writing ("information") as being factually accurate about the property, its condition or its value. Neither Rush, Witt & Wilson nor any joint agent has any authority to make any representations about the property, and accordingly any information given is entirely without responsibility on the part of the agents, seller(s) or lessor(s).
2. Photos, Videos etc: The photographs, property videos and virtual viewings etc. show only certain parts of the property as they appeared at the time they were taken. Areas, measurements and distances given are approximate only.
3. Regulations etc: Any reference to alterations to, or use of, any part of the property does not mean that any necessary planning, building regulations or other consent has been obtained. A buyer or lessee must find out by inspection or in other ways that these matters have been properly dealt with and that all information is correct.
4. VAT: The VAT position relating to the property may change without notice.
5. To find out how we process Personal Data, please refer to our Group Privacy Statement and other notices at <https://rushwittwilson.co.uk/privacy-policy>

**RUSH
WITT &
WILSON**

Residential Estate Agents
Lettings & Property Management



Rother House Havelock Road
Hastings
East Sussex
TN34 1BP
Tel: 01424 442443
hastings@rushwittwilson.co.uk
www.rushwittwilson.co.uk