



A WELL PRESENTED fourth floor (top) ONE BEDROOM FLAT in a CONVERTED GRADE II LISTED building situated in this SOUGHT AFTER SEAFRONT SQUARE, AVAILABLE FURNISHED OR UNFURNISHED. The accommodation comprises entrance hall, 16' LOUNGE, SEA VIEWS, FITTED KITCHEN, BATHROOM, GCH, EPC D.

- CONVERTED PERIOD BUILDING
- WELL PRESENTED
- EXCELLENT SEAFRONT LOCATION
- AVAILABLE FURNISHED OR UNFURNISHED
- SITUATED ON BEAUTIFUL GARDEN SQUARE
- 16' LOUNGE WITH SEA VIEWS
- FITTED KITCHEN AREA
- DOUBLE BEDROOM
- BATHROOM
- GAS CENTRAL HEATING





THIRD FLOOR

ENTRANCE

Entrance with stairs up to fourth floor with West aspect double glazed window, roof top views to the sea.

FOURTH FLOOR

HALL

Security entry phone system, laminated wood flooring.

OPEN PLAN LOUNGE/KITCHEN

East aspect double glazed windows, views over garden square to the sea, ceiling spotlights, laminated wooden flooring, radiator.

KITCHEN

Fitted with a range of eye level wall cupboards and base cupboards and drawer units with roll edge working surfaces over, tiled surround, single bowl stainless steel sink and drainer unit with mixer tap, two ring gas hob with extractor fan over, electric oven, washing machine, fridge, ceiling spotlights, wall mounted 'Worcester' combination boiler, laminated wooden flooring, East aspect double glazed window, views over gardens to the sea..

BEDROOM

West aspect double glazed window, roof top views to the sea and Brighton Pier, laminated wooden flooring, radiator.

BATHROOM

Fitted with white suite comprising panel bath with mixer tap and shower attachment, pedestal wash hand basin, low level WC, ceiling light, laminate flooring, extractor fan and radiator.

COUNCIL TAX BAND A - £1,719.63

ADDITIONAL INFORMATION

NEW ASSURED SHORTHOLD TENANCIES (ASTs) SIGNED ON OR AFTER 1 JUNE 2019

Holding Deposit (per tenancy)

One week's rent. This is to reserve a property. Please Note: This will be withheld if any relevant person (including any guarantor(s)) withdraw from the tenancy, fail a Right-to-Rent check or provide materially significant false or misleading information. The holding deposit will be offset against the first months rent.

Security Deposit (per tenancy. Rent under £50,000 per year)

Five weeks' rent. This covers damages or defaults on the part of the tenant during the tenancy.

Security Deposit (per tenancy. Rent of £50,000 or over per year)

Six weeks' rent. This covers damages or defaults on the part of the tenant during the tenancy.

Unpaid Rent

Interest at 3% above the Bank of England Base Rate from Rent Due Date until paid in order to pursue non-payment of rent. Please Note: This will not be levied until the rent is more than 14 days in arrears.

Lost Key(s) or other Security Device(s)

Tenants are liable to the actual cost of replacing any lost key(s) or other security device(s). If the loss results in locks needing to be changed, the actual costs of a locksmith, new lock and replacement keys for the tenant, landlord any other persons requiring keys will be charged to the tenant. If extra costs are incurred there will be a charge of £15 per hour (inc. VAT) for the time taken replacing lost key(s) or other security device(s).

Variation of Contract (Tenant's Request)

£50 (inc. VAT) per agreed variation. To cover the costs associated with taking landlord's instructions as well as the preparation and execution of new legal documents.

Change of Sharer (Tenant's Request)

£50 (inc. VAT) per replacement tenant or any reasonable costs incurred if higher. To cover the costs associated with taking landlord's instructions, new tenant referencing and Right-to-Rent checks, deposit registration as well as the preparation and execution of new legal documents.

Early Termination (Tenant's Request)

Should the tenant wish to leave their contract early, they shall be liable to the landlord's costs in re-letting the property as well as all rent due under the tenancy until the start date of the replacement tenancy. These costs will be no more than the maximum amount of rent outstanding on the tenancy.

If you have any questions on our fees, please ask a member of staff.

Our Client Money Protection (CMP) scheme is with Client Money Protect and we are members of The Property Ombudsman.

FOURTH FLOOR
482 sq.ft. (44.7 sq.m.) approx.

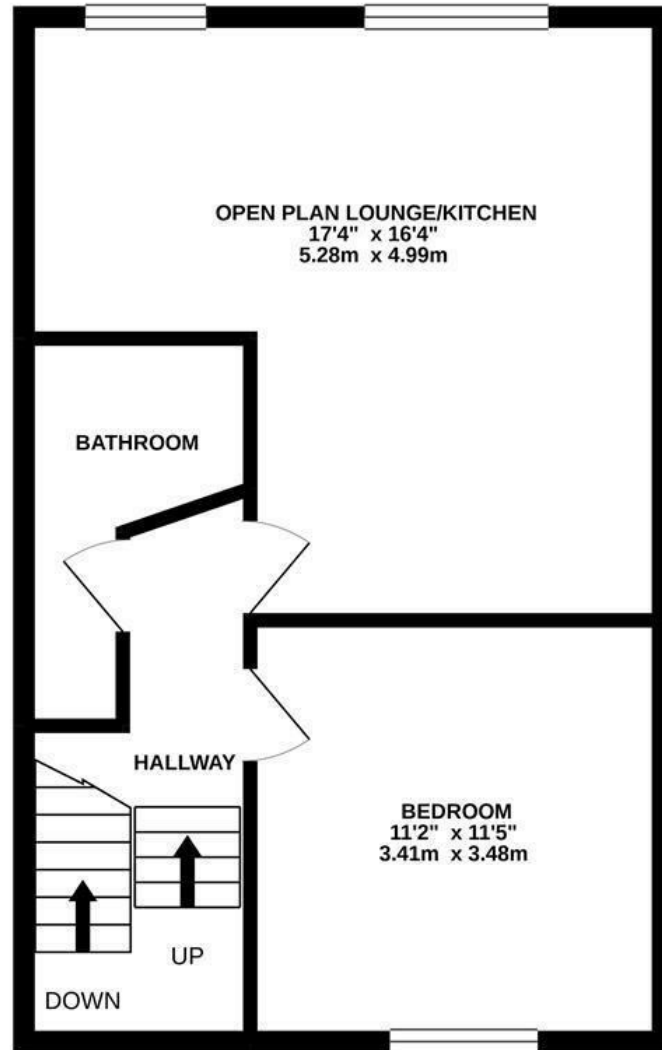

TOTAL FLOOR AREA : 482 sq.ft. (44.7 sq.m.) approx.

Whilst every attempt has been made to ensure the accuracy of the floorplan contained here, measurements of doors, windows, rooms and any other items are approximate and no responsibility is taken for any error, omission or mis-statement. This plan is for illustrative purposes only and should be used as such by any prospective purchaser. The services, systems and appliances shown have not been tested and no guarantee as to their operability or efficiency can be given.
Made with Metropix ©2021



ENERGY PERFORMANCE CERTIFICATE (EPC)

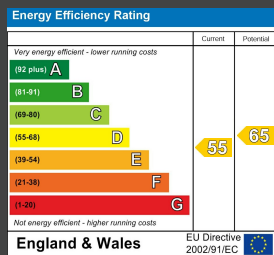

Council Tax Band: A

Maintenance: n/a

Lease Length: n/a

Ground Rent: n/a

Tel: 01273 323000

Email: sales@brices.co.uk

www.brices.co.uk

DISCLAIMER

Money Laundering Regulations 2007: Intending purchasers will be asked to produce identification documentation upon acceptance of any offer. We would ask for your cooperation in producing such in order that there will not be a delay in agreeing the sale. General: Whilst we endeavour to make our sales particulars fair, accurate and reliable they are only a general guide to the property and accordingly if there is any point which is of particular importance to you please contact the office and we will be pleased to check the position for you. Buyers must check the availability of any property and make an appointment to view, before embarking on any journey to see a property. Items shown in photographs are NOT included unless specifically mentioned within the sales particulars. They may however be available by separate negotiation. Measurements: These approximate room sizes are only intended as general guidance. You must verify the dimensions carefully before ordering carpets or any built in furniture. Services: Please note we have not tested any apparatus, equipment, fixtures and fittings or services and so cannot verify that they are in working order or fit for the purpose. A Buyer is advised to obtain verification from their Solicitor or Surveyor. References to the Tenure of a Property are based on information supplied by the Seller. The Agent has not had sight of the title documents. A Buyer is advised to obtain verification from their Solicitor. These particulars are issued in good faith but do not constitute representations of fact or form part of any offer or contract.

360°
brices
VIRTUAL VIEWINGS

brices
sales & lettings