



Beech House Broad Street, Gloucester GL19 3BN

£595,000



Beech House Broad Street, Gloucester GL19 3BN

• Five bedroom detached family home • Ample off road parking and a garage • Located in sought after village of Hartpury • Three bathrooms including Ensuite to main bedroom • 70 ft rear garden • EPC D58 • Forest of Dean District Council tax band F - £3397.77 (2026/2027)



1 High Street, Newent, GL18 1AN

01531 828970

newent@naylorpowell.com

www.naylorpowell.com

£595,000

Entrance Hall

Accessed from the porch the entrance hall which has slate tiled flooring throughout, open under stairs area and stairs leading to first floor landing plus doors off to ground floor accommodation.

Living Room

A generously sized living room boasting a feature fireplace with a cast iron stove, a brick surround and a hearth. Window overlooking the front aspect.

Study

Study to provide access to dining area via an arched opening, the kitchen and the living room via French doors.

Dining Room

Accessed from the study, the dining room is to include French doors leading out to both the sitting room and the rear garden along with a window looking out.

Kitchen

A well appointed kitchen boasting a range of base and wall mounted units with a breakfast bar area along with integrated appliances to include Rangemaster electric oven with five ring induction hob and an extractor fan over, dishwasher, integrated wine rack and space for a fridge/freezer. Window overlooking the rear and side aspect with a door leading out.

Sitting Room

Sitting room to include a cast iron log burning stove with a tiled surround and a hearth. Sliding doors leading into the conservatory.

Conservatory

A UPVC built conservatory with a polycarbonate roof and a door leading out to the rear garden.



WC

WC to include a white suite comprising hand wash basin and WC. Frosted window facing into the Porch.

Bedroom One

Double bedroom with an ensuite and a window overlooking the front aspect.

A modern ensuite to include a white suite comprising enclosed shower cubicle, WC and a hand wash basin with mixer tap.

Bedroom Two

Double bedroom with window overlooking the rear aspect.

Bedroom Three

Double bedroom with built in wardrobes. Window overlooking the side aspect.

Bedroom Four

Double bedroom with built in wardrobes. Window overlooking the front aspect.

Bedroom Five

Window overlooking the rear aspect

Shower Room

Shower room to include a white suite comprising enclosed corner shower cubicle, WC and hand wash basin.

Family Bathroom

Bathroom to include a white suite comprising a panelled bath with mixer tap

and shower detachment, WC and hand wash basin. Frosted window facing the front aspect.

Outside

To the front of the property boasts a large gravelled driveway with parking for several vehicles, a gated side access, a gravelled pathway leading to the front porch and a lawned area with a range of mature shrubs and bushes.

The rear of the property has a patioed area suitable for alfresco dining and a lawned area with raised flower beds and mature shrubs and bushes at the border.

Location

Hartpury, located approximately 5 miles north of the historic city of Gloucester, provides various amenities including primary schooling, weekly post office service, public house and active community with various social groups and clubs. Popular with both young families and working professionals due to easily accessible commuting links, the village is known for the prestigious Hartpury College with its extensive equestrian and sporting facilities.

Material Information

Tenure: Freehold

Council tax band: F

Local Authority & rates: Forest of Dean



District Council - £3397.77 (2026/2027)

Electricity supply: Mains

Water supply: Mains

Sewerage: Mains

Heating: Oil

Broadband speed: Basic 17 Mbps Superfast

52 Mbps

Mobile phone coverage: EE, Vodafone, O2



GROUND FLOOR

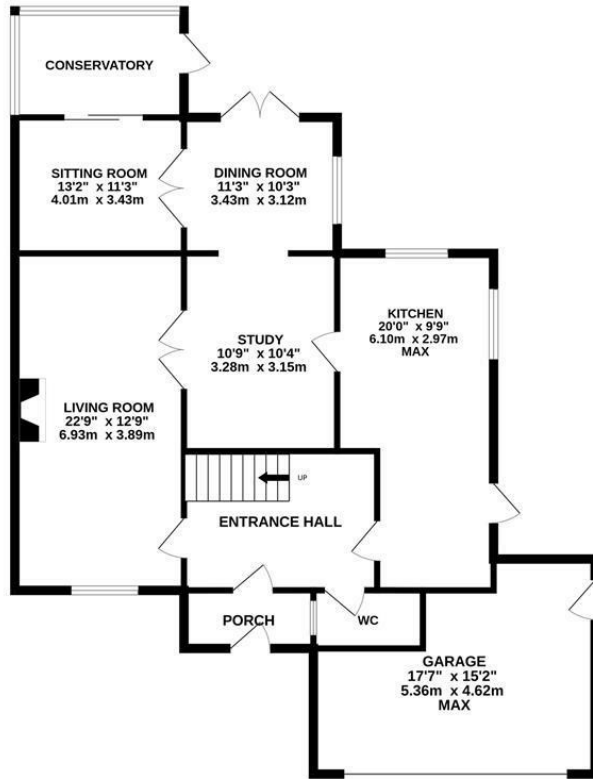

1ST FLOOR

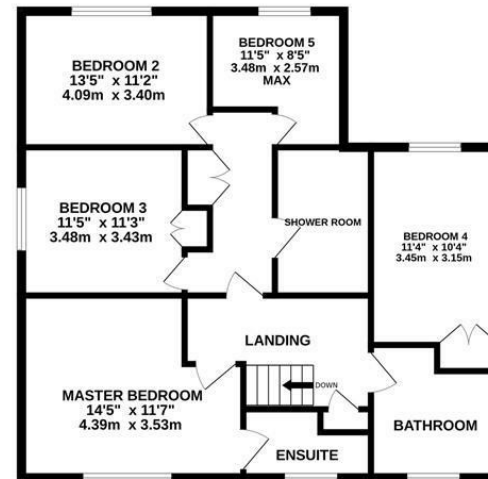

Whilst every attempt has been made to ensure the accuracy of the floorplan contained here, measurements of doors, windows, rooms and any other items are approximate and no responsibility is taken for any error, omission or mis-statement. This plan is for illustrative purposes only and should be used as such by any prospective purchaser. The services, systems and appliances shown have not been tested and no guarantee as to their operability or efficiency can be given.
Made with Metropix ©2025

1 High Street, Newent, GL18 1AN | Tel: 01531 828970 | Email: newent@naylorpowell.com | www.naylorpowell.com

Disclaimer: These particulars do not form part of any contract and no responsibility is accepted for any errors or omissions in any statement made, whether verbally or written for or on behalf of Naylor Powell.

Floorplans have been prepared for identification purposes only, they are not to scale and no guarantee can be given as to their accuracy.

Prospective purchasers please be aware none of the appliances, boiler, heaters etc. which may have been mentioned in these particulars have been tested and no guarantee can be given that they are in working order. Prospective purchasers should arrange for such items to be tested at their own expense.

