



Fountain Park Way

, London

Asking Price £1,000,000



Floor Plan

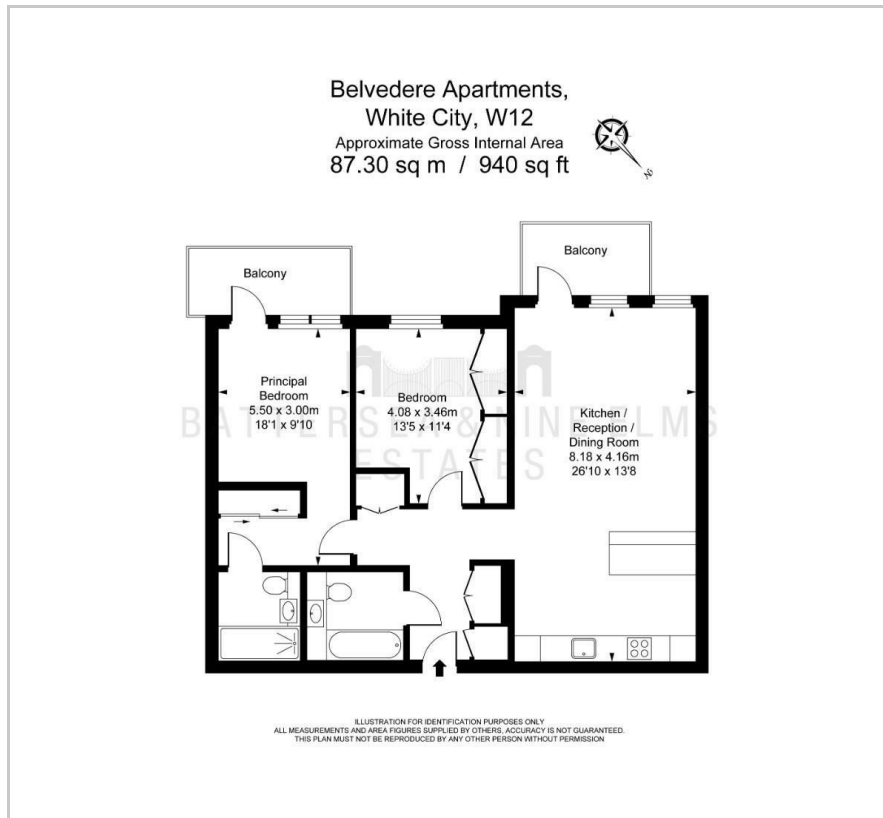

Area Map

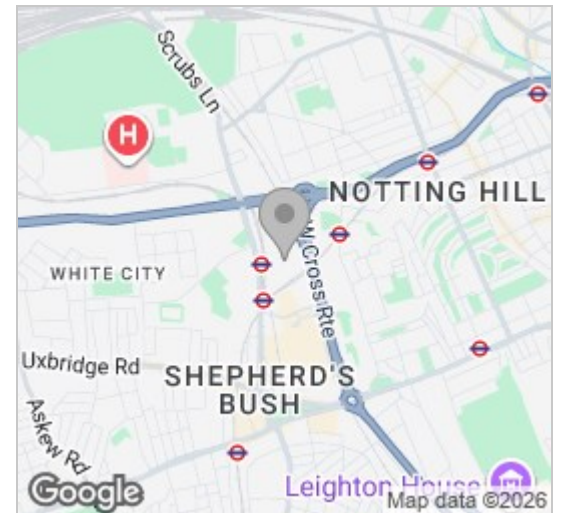

Energy Efficiency Graph

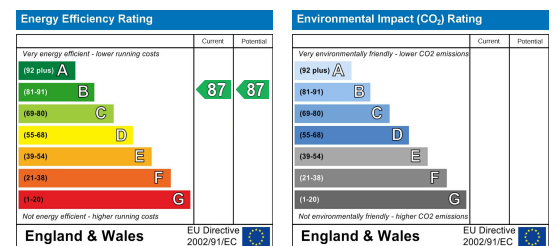

Viewing

Please contact our Battersea & Nine Elms Estates Office on +44 (0)207 720 6089 if you wish to arrange a viewing appointment for this property or require further information.

- Two double bedrooms
- Two bathrooms
- 24 Hour concierge
- Excellent transport links

Welcome to this splendid apartment located on Belvedere Row in the sought-after White City Living development. Spanning an impressive 940 square feet, this residence offers a harmonious blend of comfort and modern living.

Upon entering, you are greeted by a spacious reception room that serves as the heart of the home, perfect for both relaxation and entertaining guests. The apartment features two well-proportioned bedrooms, providing ample space for rest and privacy. Each bedroom is thoughtfully designed to maximise natural light, creating a warm and inviting atmosphere.

The property boasts two contemporary bathrooms, ensuring convenience for both residents and visitors. The stylish fixtures and fittings add a touch of luxury, making daily routines a pleasure.

Situated in the vibrant White City Living community, this apartment benefits from excellent transport links and a variety of local amenities, including shops, restaurants, and parks. The area is known for its dynamic atmosphere and community spirit, making it an ideal choice for families and professionals alike.

This apartment is not just a place to live; it is a lifestyle choice that offers comfort, convenience, and a sense of belonging. Do not miss the opportunity to make this exceptional property your new home.



These particulars, whilst believed to be accurate are set out as a general outline only for guidance and do not constitute any part of an offer or contract. Intending purchasers should not rely on them as statements of representation of fact, but must satisfy themselves by inspection or otherwise as to their accuracy. No person in this firm's employment has the authority to make or give any representation or warranty in respect of the property.