



Finchley Road

Hampstead, NW3

Asking Price £550,000

A well-presented two-bedroom first floor flat comprising over 600 square feet, offering stylish living with the added benefit of a private rear-facing terrace.

The property features a generous 14'6 x 14' reception room, enhanced by attractive wood flooring and excellent proportions for both relaxing and entertaining. The reception room flows seamlessly out to the private terrace, creating a wonderful indoor-outdoor living space, ideal for al-fresco dining.

Both bedrooms are complemented by built in wardrobes and the property is well located for local bus links and shops.



Finchley Road

Hampstead, NW3

- Two bedroom flat
- Period conversion
- Private roof terrace
- High ceilings
- Allocated parking space



Tenure: Leasehold 146 years remaining
Service Charge: £3,200 per annum
Ground Rent: £0
Local Authority: Camden
Council Tax Band: E

| Score | Energy rating | Current | Potential |
|-------|---------------|---------|-----------|
| 92+ | A | | |
| 81-91 | B | | |
| 69-80 | C | 78 C | 82 B |
| 55-68 | D | | |
| 39-54 | E | | |
| 21-38 | F | | |
| 1-20 | G | | |

Chestertons Hampstead Sales

55-56 Hampstead High Street
 Hampstead
 NW3 1QH
 hampstead@chestertons.co.uk
 020 7794 3311
 chestertons.co.uk

Finchley Road, London, NW3
Approximate Gross Internal Floor Area = 56.0 sq m / 603 sq ft

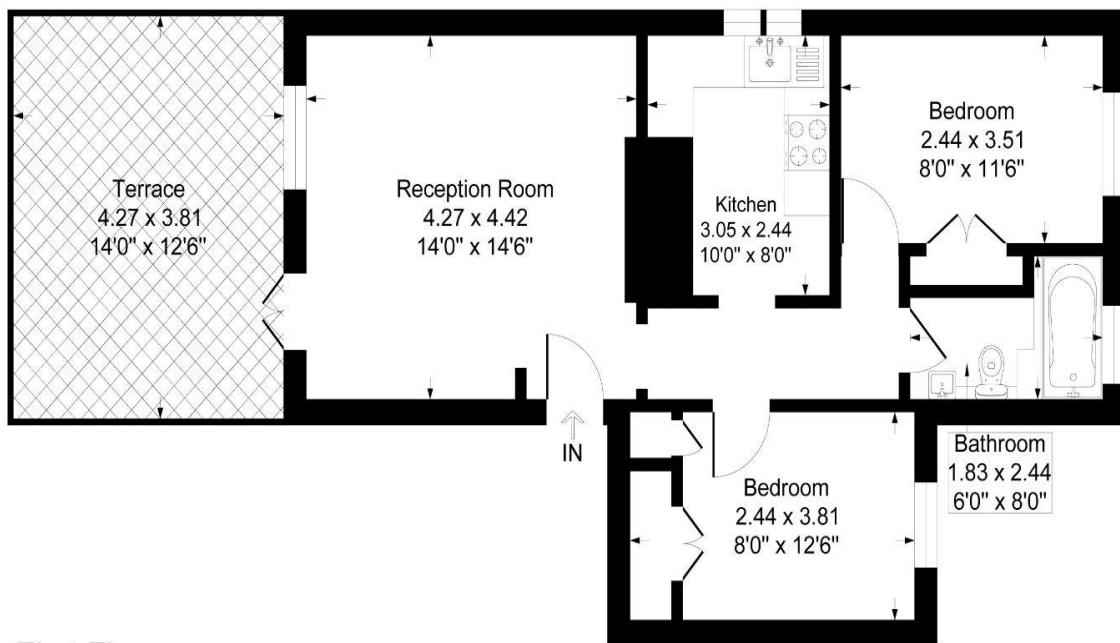

First Floor

Illustration for identification purposes only, measurements are approximate, not to scale.