



GUILDCREST ESTATES



1 Willow Drive, Littlebourne, Canterbury CT3 1FX





GUILDCREST ESTATES

Willow Drive, Littlebourne,
Canterbury CT3 1FX

Guide price £425,000

*** Guide Price £425,000 - £450,000 ***

Situated in the sought-after village of Littlebourne, Canterbury, this three-bedroom detached house on Willow Drive was built in 2021 and offers 1,098 sq. ft. of well-planned accommodation.

To the front of the property is a comfortable sitting room with a log-burning stove, creating a focal point for the room and a welcoming space to relax. To the rear, a generous kitchen/dining room provides an excellent area for everyday living and entertaining, fitted with integrated appliances including a dishwasher, washing machine and fridge freezer.

On the first floor, there are two good-sized double bedrooms and a further single bedroom. The principal bedroom benefits from its own ensuite shower room, with the remaining bedrooms served by the family bathroom.

The ground floor is laid with contemporary LVT flooring, adding both style and practicality. Outside, the property offers driveway parking for two cars and gated side access leading to the rear garden, providing a pleasant private outdoor space.

Willow Drive enjoys a convenient position within Littlebourne, with access to local amenities, countryside walks and Canterbury city centre within easy reach, making this an appealing home for buyers seeking modern living in a village setting.





Living Room
15'7 x 10'9 (4.74 x 3.28)

Kitchen / Dining Room
18'5 x 13'10 (5.60 x 4.21)

Cloakroom

Hallway

Bedroom 1
14'0 x 9'5 (4.26 x 2.88)

Bedroom 2
13'3 x 10'2 (4.03 x 3.10)

Bedroom 3
9'5 x 8'10 (2.88 x 2.70)

Bathroom

Landing

Rear Garden

Front Exterior





GUILDCREST ESTATES

Key Features

- 3 bedroom detached house
- Beautiful kitchen dining room
- Cosy lounge with log burning stove
- Integrated modern appliances
- Master with en-suite shower
- LVT flooring downstairs
- Driveway for 2 cars
- Side access to rear garden
- Built in 2021

Important Information

Freehold
House - Detached
1097.93 sq ft
Council Tax Band E
EPC Rating B

£425,000

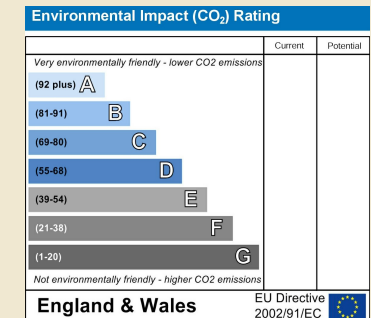
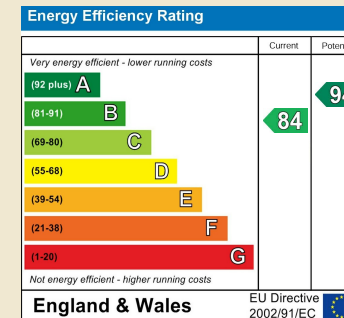
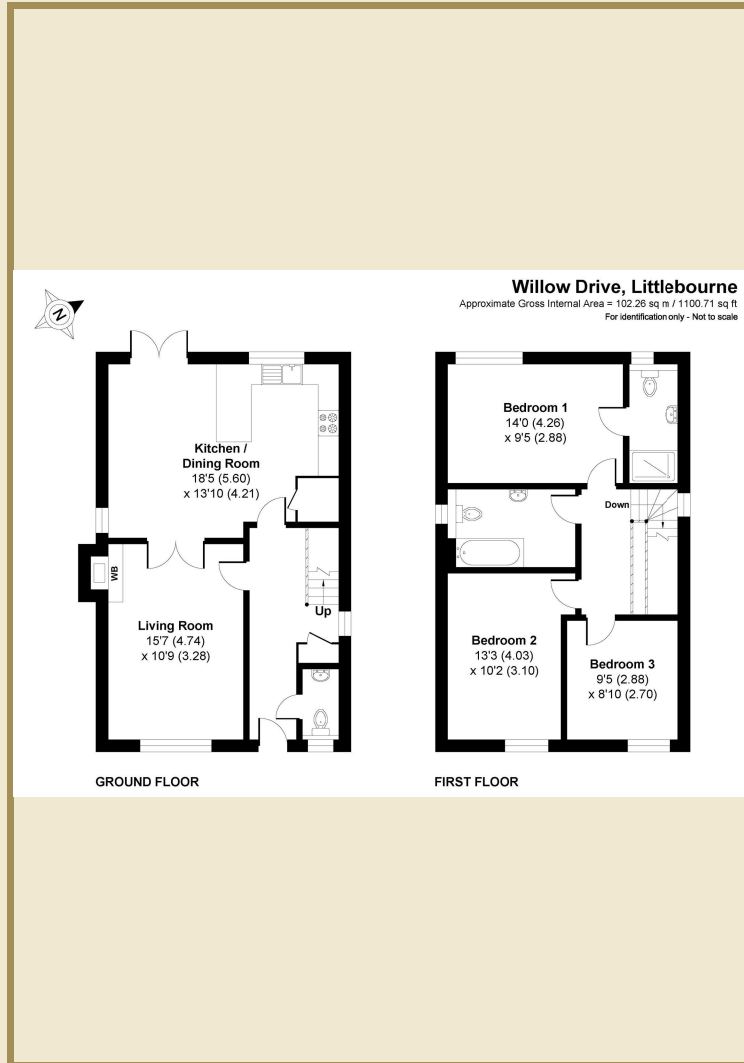

01227 696000 www.guildcrestestates.co.uk

24 Lower Bridge Street, Canterbury, Kent CT1 2LG



Guildcrest Estates Ltd. Registered Office 1 Percy Road, Broadstairs, Kent CT10 3LB Company Number: 13135084 Registered In England & Wales | VAT Number: 374 4288 71

Disclaimer These particulars, whilst believed to be accurate are set out as a general outline only for guidance and do not constitute any part of an offer or contract. Intending purchasers should not rely on them as statements of representation of fact, but must satisfy themselves by inspection or otherwise as to their accuracy. No person in this firm's employment has the authority to make or give any representation or warranty in respect of the property.