



Coverdale Road
Stockton-On-Tees

£185,000
ENERGY RATING: D-63

Welcome to this deceptively spacious semi-detached bungalow located in this highly desirable location in Fairfield, off Whitton Road. The accommodation comprises; spacious entrance hall, a through lounge/dining room, two double bedrooms, a modern shower room and a kitchen extension to the rear. This property boasts a large South-Westerly facing rear garden perfect for enjoying sunny afternoons or hosting summer barbecues. Additionally there is an extensive block paved drive to the side with a carport and leads to a detached garage. Offered with the benefit of no onward chain! Energy Rating: D-63. Council Tax Band: B (£1906.46)



- Very Spacious Semi-Detached Bungalow
- Two Double Bedrooms
- Kitchen Extension to the Rear
- Large South-West Facing Rear Garden

Entrance Hallway

Composite entrance door with leaded feature lights which opens to a spacious hallway with access to lounge, bedrooms and shower room.

Lounge/Dining Room

7.85m x 3.61m (at widest) (25'9" x 11'10" (at widest))

Front aspect UPVC double glazed leaded bow windows, feature stone fireplace with stripped wooden plinths & a gas fire, large storage cupboard, coving to ceiling and two radiators.

Kitchen

4.29m x 2.33m (14'0" x 7'7")

Side & rear aspect UPVC double glazed windows and a side aspect UPVC door leading to the garden.

A range of base & wall units with rolled worksurfaces and tiled splashbacks incorporating a 1½ bowl stainless steel sink unit & mixer tap, electric hob with double oven below & extractor hood over. Free-standing washing machine, dishwasher & fridge/freezer and a cupboard housing central heating boiler.



- Extensive Block Paved Drive, Carport & Garage • Quiet, Highly Sought After Location • Energy Rating: D-63 • Council Tax Band: B (£1904.46)



Bedroom One

3.75m x 3.63m (12'3" x 11'10")

Front aspect UPVC double glazed bow window, fitted wardrobes & cupboards and a radiator.

Bedroom Two

3.62m x 3.00m (11'10" x 9'10")

Rear aspect UPVC double glazed window overlooking the garden, exposed & painted floorboards and a radiator.



Shower Room

2.38m x 2.63m (7'9" x 8'7")

Rear aspect UPVC double glazed window, modern white vanity unit housing wash basin, low level WC, walk-in, floor-level double enclosure with electric shower, fully tiled walls and a heated towel rail.

Externally

There is a very well stocked garden to the front of the property with a range of plants, shrubs & bushes. To the side is an extensive block paved driveway providing parking for a number of vehicles and leads to a carport and detached garage with up & over door, attached storage shed and lean-to potting shed. There is a large South-Westerly facing garden to the rear where the block paving extends around the property.







Additional Information

Local Authority - Stockton-on-Tees
Council Tax - Band B
Viewings - By Appointment Only

Floor Area - 830.00 sq ft
Tenure - Freehold

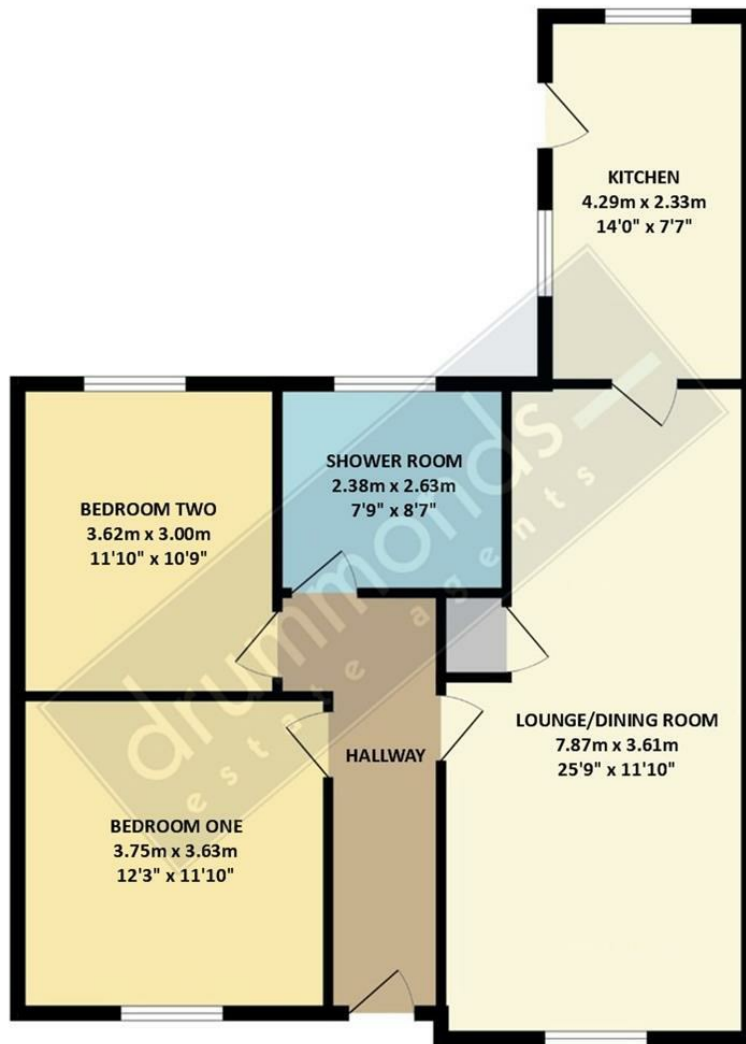

MEASUREMENTS ARE APPROXIMATE. NOT TO SCALE. FOR ILLUSTRATIVE PURPOSES ONLY.

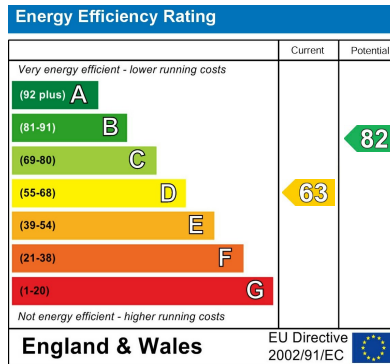

Agents Note: Whilst every care has been taken to prepare these particulars, they are for guidance purposes only. All measurements are approximate and are for general guidance purposes only and whilst every care has been taken to ensure their accuracy, they should not be relied upon and potential buyers/tenants are advised to recheck the measurements

Billingham Sales
63 Queensway
Billingham
TS23 2LU

01642530919
info@drummondstates.co.uk
www.drummondstates.co.uk

drummonds
estate agents