



69 Onslow Road, Endcliffe Park, Sheffield, S11 7AG

Saxton Mee

69 Onslow Road

Endcliffe Park

Guide Price

£330,000

Guide Price £330,000-£350,000

Situated on one of the most popular roads in this location, a four bedroom bay windowed villa mid-terrace offering spacious accommodation and for sale with early vacant possession and no chain. The property is in an excellent catchment area for schools and is well placed for first class amenities on Ecclesall Road and Hunters Bar and very close to Endcliffe Park and the Hallamshire Squash and Tennis Club.

The accommodation comprises, side entrance lobby, bay windowed lounge with a lovely original marble fireplace, separate dining room, off-shot kitchen. On the first floor double bedroom one with recess wardrobe area, good sized bedroom two, bathroom with full suite. On the second floor two further bedrooms with Velux roof lights. In the basement, cellar.

Outside, forecourt to the front. To the rear, courtyard garden area with raised border, south easterly facing and a useful storage outhouse.



- Great location within short walk of Endcliffe Park
- Great restaurants and shops on Ecclesall Road and Hunters Bar
- Excellent local schools
- Larger style four bedroom bay windowed Villa Terrace
- Original marble fireplace to the sitting room
- For sale with early vacant possession and no chain
- Rear south easterly facing courtyard garden and useful brick built storage outhouse



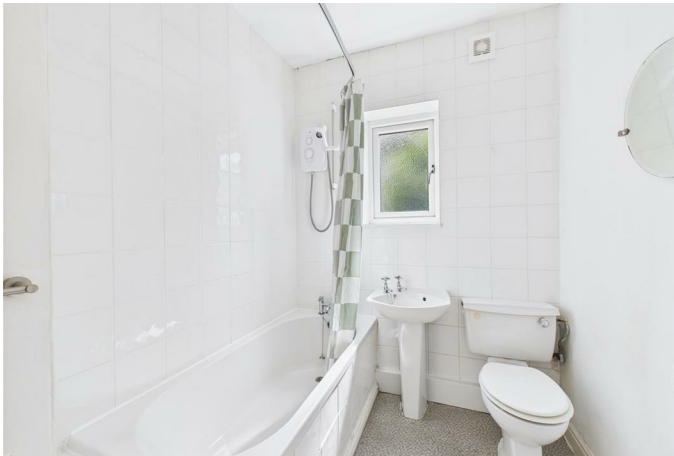

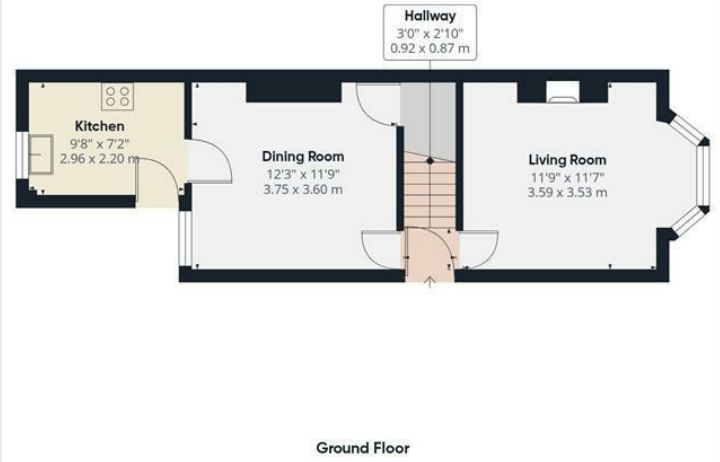

Approximate total area⁽¹⁾
966 ft²
89.8 m²

Reduced headroom
53 ft²
4.9 m²

(1) Excluding balconies and terraces

Reduced headroom
..... Below 5 ft/1.5 m

Calculations reference the RICS IPMS 3C standard. Measurements are approximate and not to scale. This floor plan is intended for illustration only.

GIRAFFE360

While we endeavour to make our sales particulars fair, accurate and reliable, they are only a general guide to the property and, accordingly, if there is any point, which is of particular importance to you, please contact the relevant office. The Agents have not tested any apparatus, equipment, fittings or services and so cannot verify they are in working order. The buyer is advised to obtain verification. Please note all the measurement details are approximate and should not be relied upon as exact. All plans, floor plans and maps are for guidance purposes only and are not to scale. Under no circumstances should they be relied upon as exact or for use in planning carpets and other such fixtures, fittings or furnishings. YOUR HOME IS AT RISK IF YOU DO NOT KEEP UP REPAYMENTS ON A MORTGAGE OR OTHER LOAN SECURED ON IT. 'A Life Assurance policy may be requested.' 'Written Quotations of credit terms available on request.'

Banner Cross
T: 0114 268 3241
E: bannercross@saxtonmee.co.uk
www.saxtonmee.co.uk

Hathersage
T: 01433 650009
E: hathersage@saxtonmee.co.uk

Bakewell
T: 01629 815307
E: bakewell@saxtonmee.co.uk

Matlock
T: 01629 828250
E: matlock@saxtonmee.co.uk

