



Chichele Road, NW2

Leasehold - Share of Freehold - £399,950

A bright and airy one-bedroom apartment comprised on the first floor of a coveted purpose-built block in Cricklewood.

The apartment boasts superb ceiling heights throughout, sizeable rooms, lift access, and includes off-street parking in a gated car park to the rear of the block. There's scope for a purchaser to make their mark throughout.

The apartment is situated close to the varied amenities of Kilburn High Road and Willesden Green. Local transport links include Cricklewood railway station and Willesden Green station (Jubilee Line, Zone 2).

Viewing is highly recommended.



020 7328 2828

enquiries@cameronsstiff.co.uk

cameronsstiff.co.uk

Chichele Road, London, NW2

Approximate Area = 730 sq ft / 67.8 sq m

For identification only - Not to scale



EPC: C
Ref: 19692965

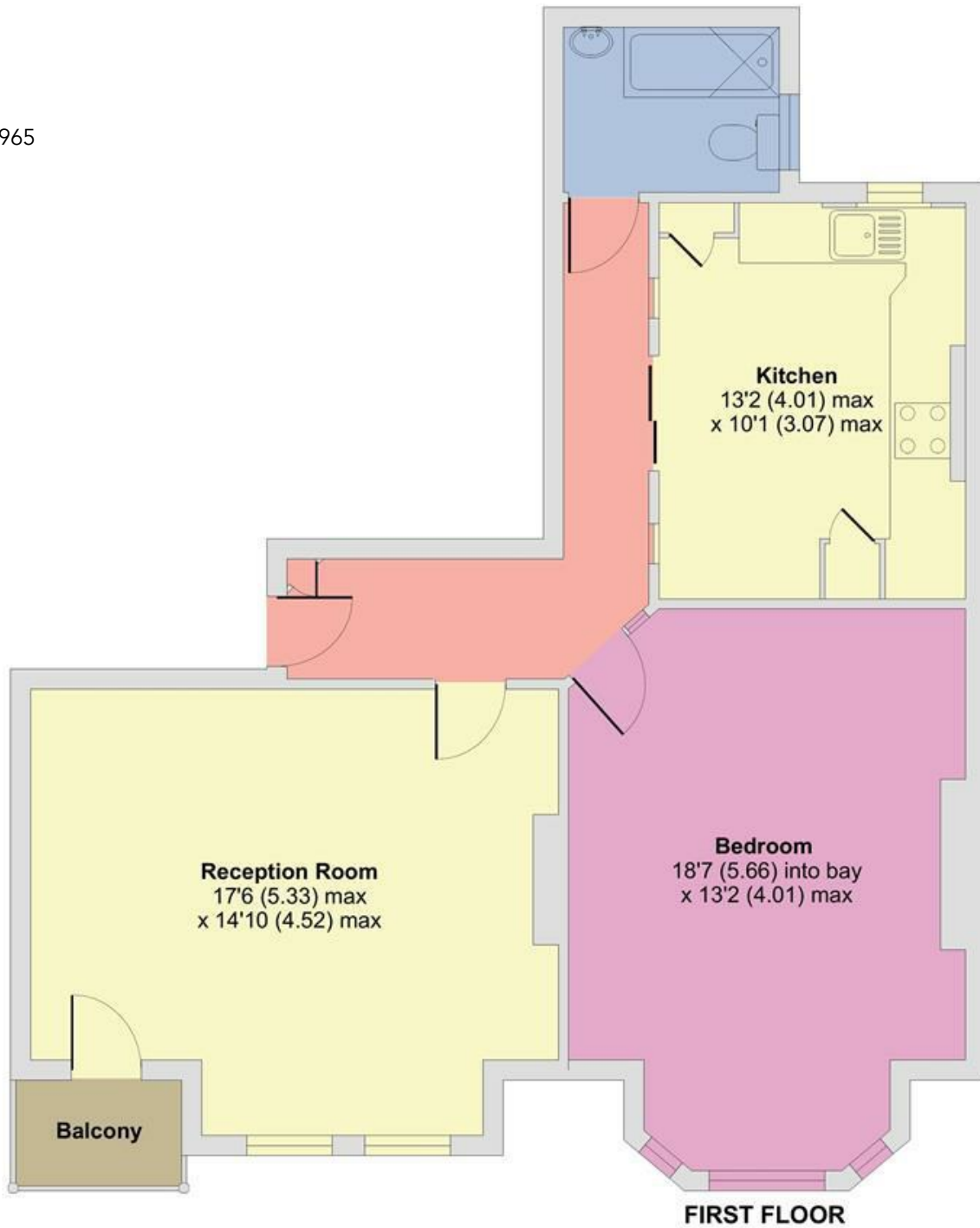

Floor plan produced in accordance with RICS Property Measurement 2nd Edition, Incorporating International Property Measurement Standards (IPMS2 Residential). © nchecom 2026. Produced for Camerons Stiff & Co. REF: 725255

