



Barnsley Road, Dodworth, S75 3JX

Offers Over £225,000

3 1 1



- Modernised 3 bedroom Semi Detached
- Long Distance Views
- Private Position
- Local Services & Amenities
- M1 Access
- Generous Plot with South Facing Gardens
- Off Road Parking
- Exceptional Throughout
- Bus & Rail Services
- Home Office / Studio



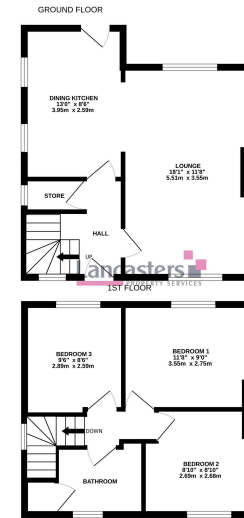

While every effort has been made to ensure the accuracy of the floor plan, the measurements of these, including, rooms and any other parts are approximate and no responsibility is taken for any error, omission or misstatement. The floor plan is for general information only and should not be used for any purpose other than that intended. The information, figures and descriptions shown here have been based on the general information available to the agent at the time of the visit. Measurements are not guaranteed. Make your own measurements.

An exceptional 3 bedroom semi detached home, occupying a generous plot with gardens to three sides, benefitting from off road parking, south facing gardens and stunning long distance views.

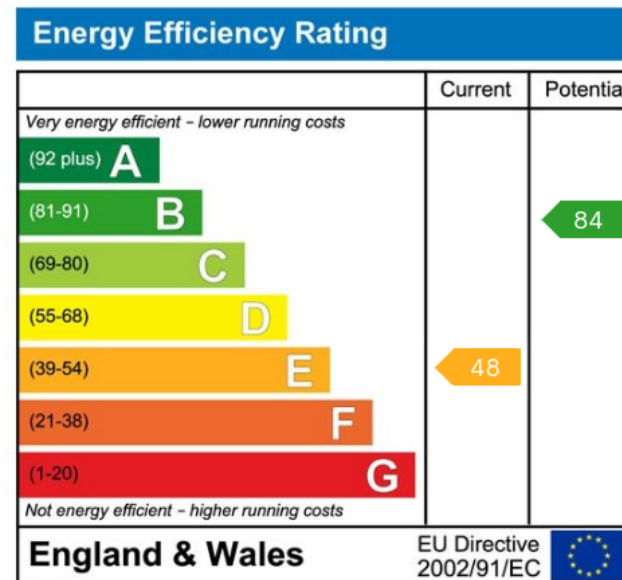

Lancasters Property Services
 Property Professionals For Over 230 Years
 Independent Estate Agents, Surveyors & Property Management
 Email: mail@lancasters-property.co.uk
 In association with Lancasters Property Management Ltd.

Lancaster House, 20 Market St.
 Penistone S36 6BZ
 Tel: (01226) 763307