



**Taylor's**  
Est. 1992

**May Drive, Glenfield, LE3 8HT**  
Leicester

Shared Ownership  
**£104,000**

Tucked into a quiet residential enclave in the ever-popular village of Glenfield, this beautifully presented two-bedroom end-of-terrace house combines clean contemporary lines with thoughtful modern living. Constructed in 2015, the house has been carefully maintained and offers bright, efficient spaces arranged across two floors, alongside a private garden and off-street parking.

Set behind a neat frontage, the house opens into a welcoming kitchen which is arranged with modern cabinetry, which then leads through to an airy open-plan living and dining room. Generous glazing draws natural light deep into the plan, while neutral finishes and well-proportioned interiors create a calm and adaptable atmosphere throughout.

Upstairs are two well-balanced double bedrooms, both quietly positioned and finished in a restrained contemporary palette. A sleek family bathroom sits centrally, fitted with modern fixtures and understated detailing.

Outside, the rear garden has been landscaped for low-maintenance living, offering a private setting for outdoor dining and entertaining. As an end-of-terrace home, the house enjoys an enhanced sense of privacy and additional side access.

May Drive is ideally positioned for access to the amenities of Leicester and the surrounding Leicestershire countryside. Glenfield itself is known for its strong community feel, independent shops, cafés and excellent transport connections, with Leicester city centre and major road links all within easy reach.

**40% SHARED OWNERSHIP - Buyers must meet shared ownership eligibility criteria and be approved by the housing association.**

Comments from the owner:

*'This has been a great house as a first time buyer and only selling due to having a growing family. It is modern, good location and the estate is lovely and feels safe. There are shops within walking distance of the property as well as the golf course to the rear of the estate where if you have dogs (or not) is a great place to go for a walk and also the Ivanhoe trail. It is close to get onto the M1 but you can't hear any noise from it and a short distance from Fosse Park and also the city centre with a bus route to the city which comes*





### 40% SHARED OWNERSHIP

Contemporary two-bedroom end-of-terrace home built in 2015, with bright open-plan living, private garden and parking, set within a quiet residential development in popular Glenfield.

- **\*\*40% SHARED OWNERSHIP\*\***
- Contemporary two-bedroom end-of-terrace home
- Built in 2015 with modern finishes throughout
- Bright open-plan living and dining space
- Stylish fitted kitchen
- Two well-proportioned double bedrooms
- Modern family bathroom suite
- Driveway for two cars
- Private low-maintenance rear garden
- Quiet Glenfield location close to amenities and transport links

**Council Tax Band: B**

**Property Type: End of Terrace House**



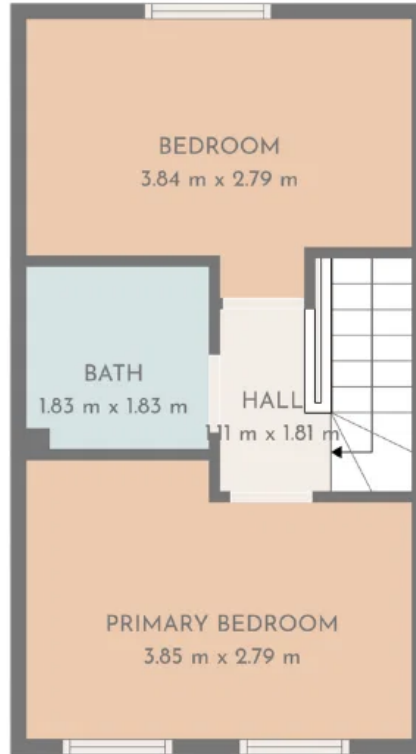

Score	Energy rating	Current	Potential
92+	A		
81-91	B		91 B
69-80	C	77 C	
55-68	D		
39-54	E		
21-38	F		
1-20	G		

## Taylor's Estate Agency

4 Woodgate Rothley Leicester, Rothley Leicester, Leicester

0116 326 6464

hello@taylorsestate.agency

https://taylorsestate.agency/