



Harrowdene Gardens, TW11

£329,950

A really well presented fully refurbished one double bedroom apartment, situated on the first floor, on the edges of Bushy Park. The property offers a light and bright space throughout, with plenty of parking available, it is also being sold chain free and also comes with a garage.



You enter on to a generous hallway leading onto a large and bright reception space. Off the reception there is a fully integrated kitchen complete with dishwasher, fridge freezer and washing machine. There is also a brand new boiler.

Towards the middle of the property there is a generous family bathroom, which is newly fitted with a good sized bath and overhead shower. Towards the back of the property there is a large family bedroom, with built in storage and plenty of natural light. The entire property is newly refurbished to a high standard complete with, plumbing and electrics. There is also plenty to parking and garage.

Harrowdene Gardens is off Sandy Lane, an excellent spot for transport, with a well-lit private footpath directly leading to Teddington mainline station and Teddington High Street within minutes. Kingston town centre is within easy reach, along with the River Thames.

- One Double Bedroom • Parking • New Lease on Completion •
- Great Location • Fully Refurbished • Chain Free •



SNELLERS

ESTATE AGENTS

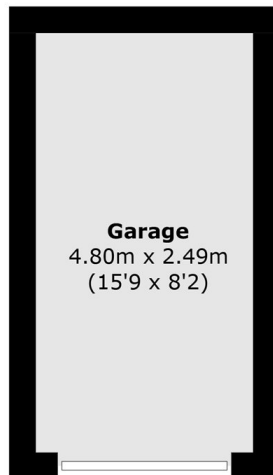

(Not Shown In Actual
Location / Orientation)

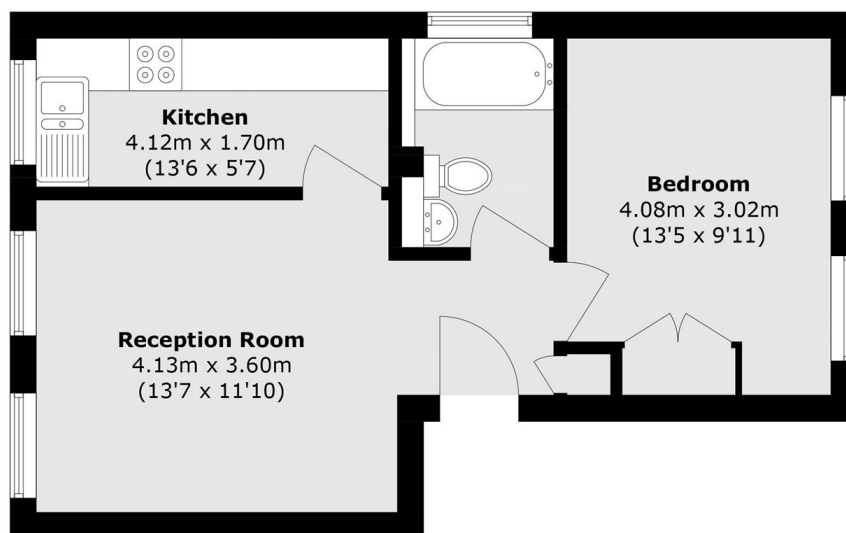

Total area (approx.): 42.6 sq. m (458.5 sq. ft)

Garage area (approx.): 11.9 sq. m (128.0 sq. ft)

Snellers Teddington Sales
74 Broad Street
Teddington
TW11 8QX
020 8408 8040
teddingtonsales@snellers.co.uk

Energy Rating: C We aim to make our particulars both accurate and reliable. However they are not guaranteed; nor do they form part of an offer or contract. If you require clarification on any points then please contact us, especially if you're traveling some distance to view. Please note that appliances and heating systems have not been tested and therefore no warranties can be given as to their good working order