



Apartment

27 THE ANCHORAGE, 23 KINGSWAY, SOUTHPORT, SOUTHPORT, PR8 1ND

PCM

£600 PCM

FEATURES



Wainwright and Edwards

Estate Agents - Letting Agents - Property Management

1 Bedroom Apartment located in Southport

Call us on

01772-814863

lettings@wainwrightandedwards.co.uk

<http://www.we-estateagents.com/>

Council Tax Band

B

A well presented purpose built apartment, the apartment is on the 4th Floor. Situated close to the amenities and transport links of Southport town center. The apartment briefly comprises of entrance hallway with intercom entry system, open plan kitchen diner with integrated oven and hob and Juliette balcony, double bedroom and bathroom with modern white suite. The property also benefits from gas central heating, double glazing and lift and stairs to all floors. UNFURNISHED. No parking.

GROUND FLOOR
361 sq.ft. (33.6 sq.m.) approx.

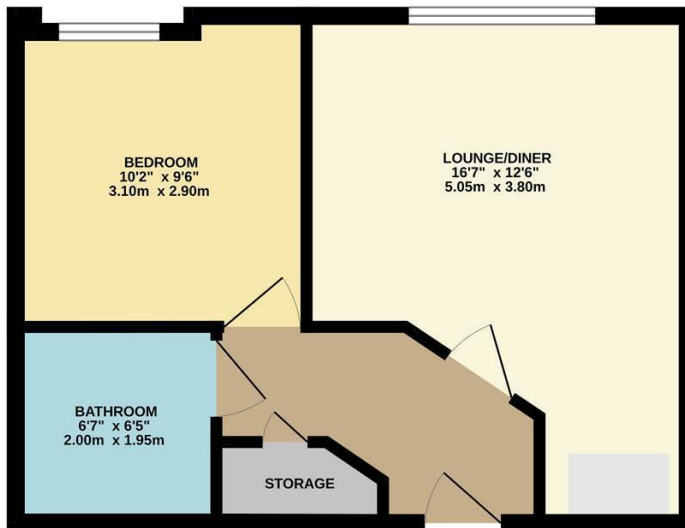

TOTAL FLOOR AREA: 361 sq.ft. (33.6 sq.m.) approx.
Whilst every attempt has been made to ensure the accuracy of the floorplan contained herein, measurements of doors, windows, rooms and any other items are approximate and no responsibility is taken for any error, omission or misstatement. This plan is for illustrative purposes only and should be used as such by any prospective purchaser. The services, systems and appliances shown have not been tested and no guarantee as to their operability or efficiency can be given.
Made with Metropix ©2023

Energy Efficiency Rating		Current	Potential
<i>Very energy efficient - lower running costs</i>			
(92 plus) A		88	88
(81-91) B			
(69-80) C			
(55-68) D			
(39-54) E			
(21-38) F			
(1-20) G			
<i>Not energy efficient - higher running costs</i>			
England & Wales		EU Directive 2002/91/EC	

Agents Note: Whilst every care has been taken to prepare these particulars, they are for guidance purposes only. All measurements are approximate and are for general guidance purposes only and whilst every care has been taken to ensure their accuracy, they should not be relied upon and potential buyers are advised to recheck the measurements.

