



## Heathcote Street, WC1N

£2,300 Per calendar month

A well presented, one bedroom apartment with open plan kitchen/reception and floor to ceiling windows leading to a shared garden. The apartment is modernised throughout with contemporary bath with shower and double bedroom.

Heathcote street is located a short walk away from the Brunswick Centre and Russell Square tube station therefore giving you an array of shops, restaurants, bars and local transport on your doorstep.

### Features

- One Bedroom
- Open Plan
- Shared Garden
- Great Location
- Recently Refurbished
- Furnished

# Heathcote Street, London, WC1N

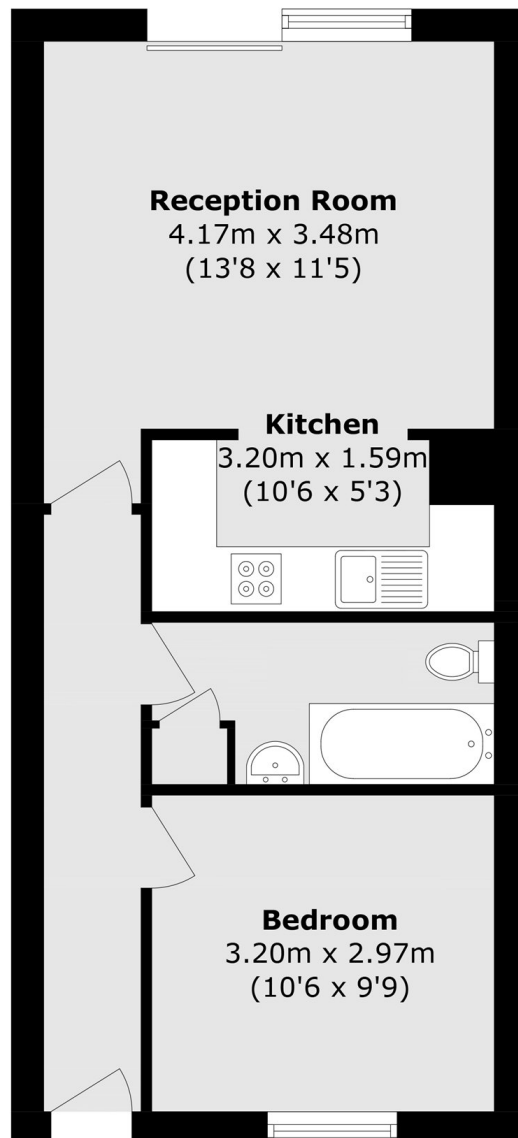

Total area (approx.): 41.3 sq. m (444.6 sq. ft)