



NEW PARK ROAD, SW2

£3,400 PCM

- Three double bedrooms
- Large reception room
- Two bathrooms
- Balcony
- Furnished
- Energy rating: B





ABOUT THE HOME

A well-presented three double bedroom apartment with two bathrooms, a spacious reception and a private balcony with skyline views across London. The property further benefits from bike storage, off-street parking and a communal roof terrace.

Courtenay House is a modern development situated within easy reach of Brixton (Victoria line) Underground station and Streatham Hill mainline station offering rail links to London Victoria via Clapham Junction. The shops, bars and restaurants of Brixton Hill are also close at hand, along with numerous regular routes.





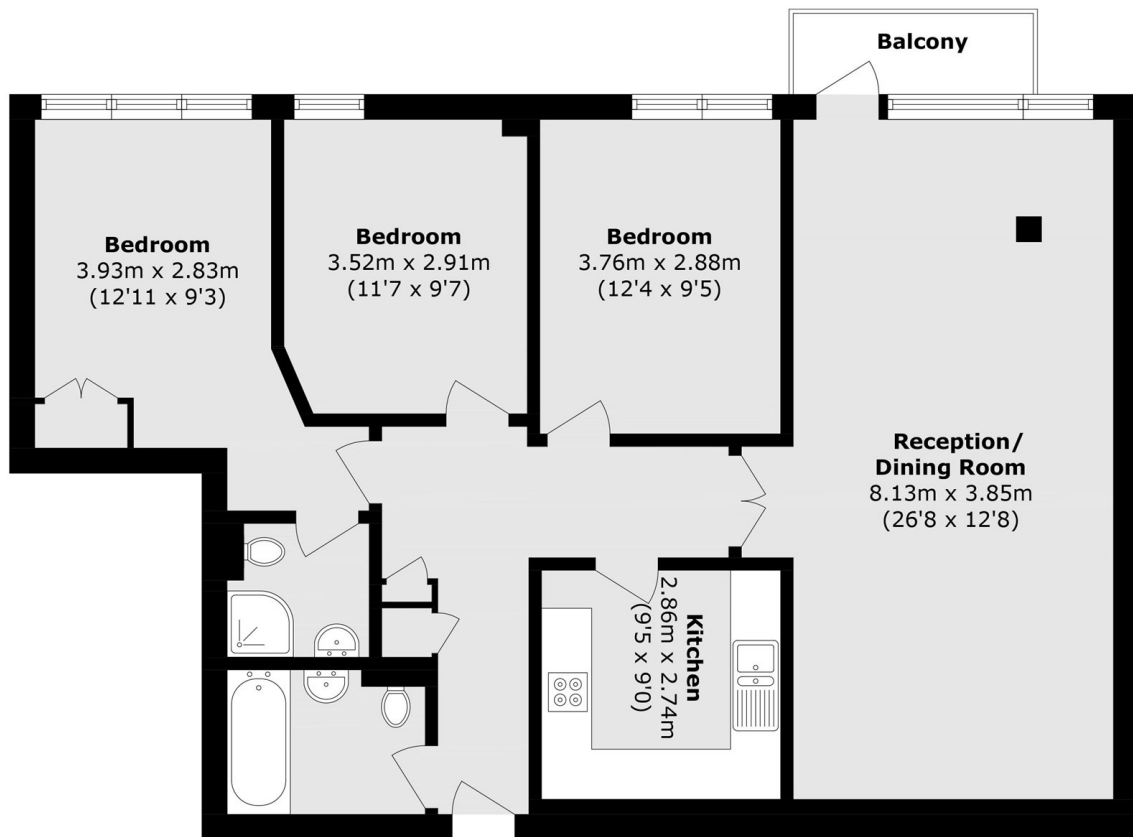

Total area (approx): 97.1 sq. m (1045.1 sq. ft)
Balcony area (approx): 2.7 sq. m (29.0 sq. ft)

JACKSONS CLAPHAM

73 Abbeville Road, London,
SW4 9JN
Sales: 020 8487 3177
Lettings: 020 8487 3178

Energy Rating: B We aim to make our particulars both accurate and reliable. However they are not guaranteed; nor do they form part of an offer or contract. If you require clarification on any points then please contact us, especially if you're traveling some distance to view. Please note that appliances and heating systems have not been tested and therefore no warranties can be given as to their good working order.