

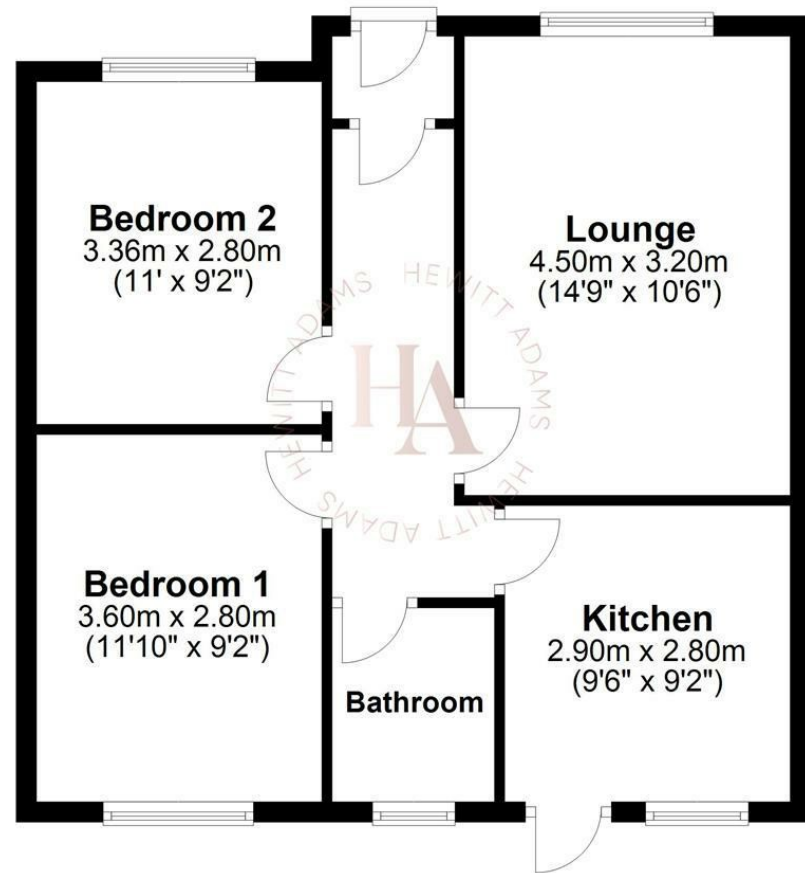

Ground Floor

Approx. 54.3 sq. metres (584.0 sq. feet)



Total area: approx. 54.3 sq. metres (584.0 sq. feet)
For illustration purposes only - not to scale

Northridge Road, Pensby, CH61 8RH

Offers Over £250,000

 2 Bedroom  1 Reception  1 Bathroom  C

****Two Bedroom Detached Bungalow - Excellent Condition - Popular Pensby Location!****

Hewitt Adams is delighted to offer to the market this two bedroom DETACHED bungalow located on Northridge Road in Pensby.

The property is in IMMACULATE CONDITION.

The property has been a LONG-TERM INVESTMENT for the current owner, and the property is currently RENTED OUT to a longstanding, happy tenant who would love to remain in the property. Making this a PERFECT INVESTMENT opportunity.

In brief the accommodation affords; entrance hall, lounge, two bedrooms, bathroom and a kitchen.

With a DETACHED GARAGE and a landscaped rear garden.

Call Hewitt Adams on 0151 342 8200 to view.

Front Entrance

Into;

Hall

Radiator, power points

Lounge

14'9" x 10'5" (4.5 x 3.2)

Double glazed window, radiator

Bedroom One

11'9" x 9'2" (3.6 x 2.8)

Double glazed window, radiator, power points, wardrobes

Bedroom Two

11'0" x 9'2" (3.36 x 2.80)

Double glazed window, radiator, power point

Kitchen

9'6" x 9'2" (2.9 x 2.8)

Wall and base units, integrated appliances, inset sink, double glazed window, rear door

Bathroom

Comprising bath with shower above, low level w.c, wash hand basin, double glazed window

EXTERNALLY

With a DETACHED GARAGE and a landscaped rear garden.

