



**POOLE
TOWNSEND**

Greenodd, Ulverston

£375,000

🛏 3 🚿 1 🚗 1



- Detached Bungalow
- Lounge, Dining room And Conservatory
- Gardens To Front And Rear
- Views To Distant Fells
- Council Tax Band D
- 3 Bedrooms
- Driveway And Single Garage
- Peaceful Rural Location
- Freehold



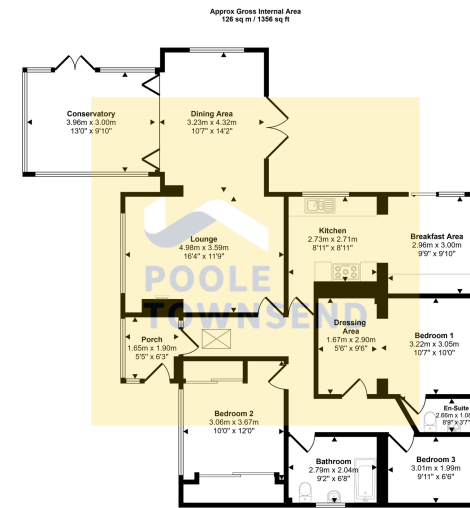

Floorplan

This floorplan is only for illustrative purposes and is not to scale. Measurements of rooms, doors, windows, and any items are approximate and no responsibility is taken for any error, omission or mis-statement. Sizes of items such as bathroom fixtures are representations only and may not look like the real items. Made with Make Snappy 360.

Set in an elevated position within the village of Greenodd on the edge of the Lake District National Park, this substantially extended detached bungalow offers spacious and versatile accommodation alongside beautifully landscaped wraparound gardens featuring ponds, shaped lawns, colourful borders, a roof terrace and a covered deck with a stone fireplace, ideal for outdoor living and entertaining. The interior includes a central hallway leading to a bright open plan lounge/dining room with far-reaching valley views and access to a conservatory, a generously sized fitted kitchen with dining space and garden access, three bedrooms including two doubles with the principal benefiting from a dressing area and en-suite, and a well-appointed family bathroom, all complemented by off-road parking and a convenient village setting with a range of local amenities nearby.

Visit us at
www.pooletownsend.co.uk
enquiries@pooletownsend.co.uk

We are open
 Monday – Friday 9.00 – 5.00
 Saturday 9.00 – 1.00

Barrow 01229 811811
 Ulverston 01229 588111
 Grange 015395 33316
 Kendal 01539 734455
 Milnthorpe 015395 62044