



## Queensville Road, SW12

£4,500 Per week

A well-presented end of terraced house that offers four double bedrooms over two floors, a spacious living room and a separate kitchen with direct access to a private garden.

Queensville is located on a residential road with access to both Balham and Clapham South high streets, both offer a selection of supermarkets, independent shops, bars and restaurants.

### Features

- Victorian House
- Four Double Bedrooms
- Separate Kitchen
- Good Sized Reception
- Wood Flooring
- Large Private Garden



## Queensville Road, SW12

On the ground floor you'll find a large reception room, double bedroom and kitchen with access to the rear garden.

Whilst the first floor provides a further three double bedrooms and a family bathroom.



Queensville Road,  
London, SW12

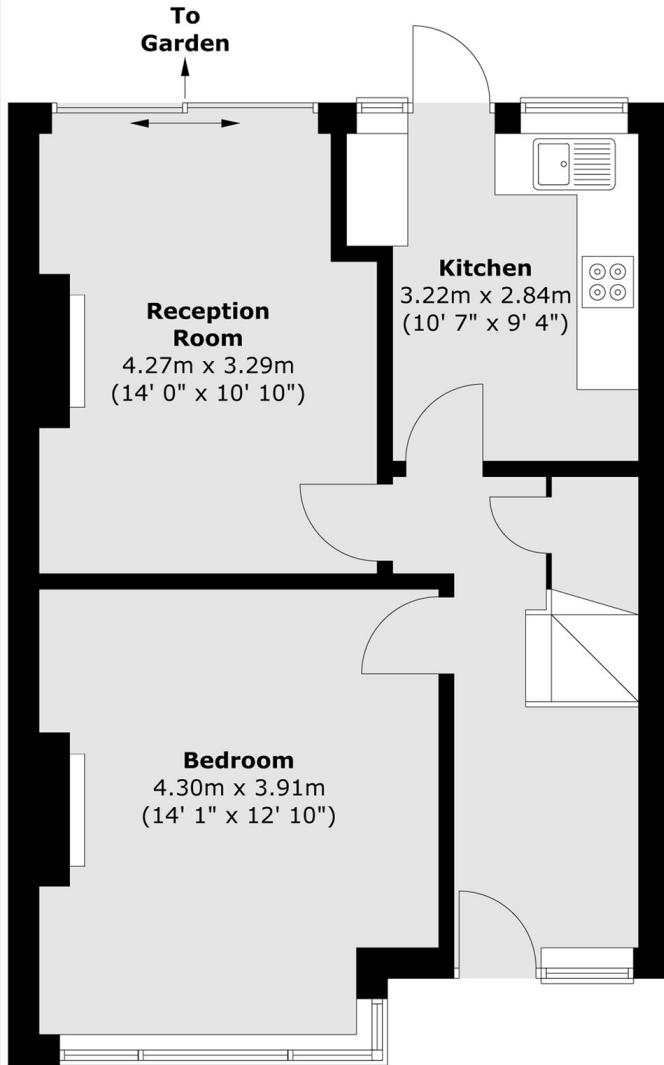

**Ground Floor**

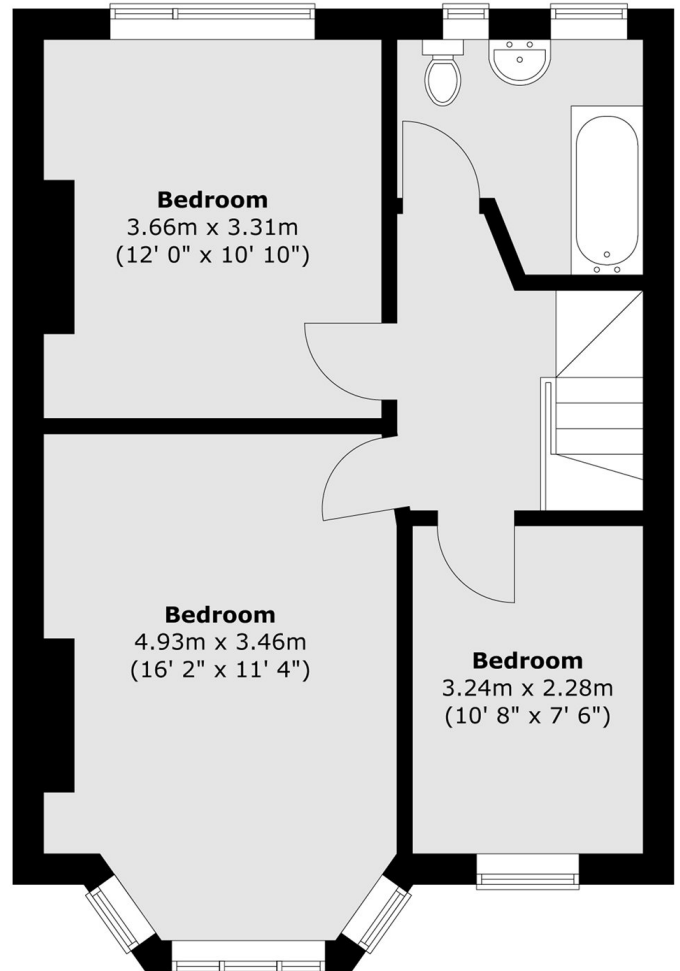

**First Floor**

Total area (approx.) : 98.5 sq. m (1060 sq. ft)