

77 Hythe Road - Offers In Excess Of £180,000

Methwold Thetford IP26 4PX

chilterns

Estate & Letting Agents



"Consistently providing outstanding service to our clients"

Offers In Excess Of £180,000

The Property

Nestled on Hythe Road in the charming village of Methwold, Thetford, this delightful mid-terrace house offers a perfect blend of comfort and convenience. With three well-proportioned bedrooms, this property is ideal for families or those seeking extra space. The two inviting reception rooms provide ample opportunity for relaxation and entertaining, making it easy to host friends and family.

The house features a well-appointed bathroom, ensuring that daily routines are both practical and pleasant. Although the property does not boast extensive square footage, its layout maximises the available space, creating a warm and welcoming atmosphere throughout.

Situated in a peaceful area, this home benefits from the tranquillity of village life while still being within easy reach of local amenities. Methwold offers a sense of community and charm, making it an attractive place to live.

This property presents an excellent opportunity for those looking to settle in a serene environment without sacrificing accessibility to nearby towns and services. Whether you are a first-time buyer or seeking a new family home, this mid-terrace house on Hythe Road is certainly worth considering.

Agent's Note:

Please be aware that images of the property may have been digitally enhanced, edited, or staged using artificial intelligence, and may not reflect the current presentation or furnishings.

AGENTS NOTE

Please be advised that the sale of this property is subject to Grant of Probate being granted.

Features

- 3 COSY BEDROOMS
- SPACIOUS RECEPTION ROOMS
- MID-TERRACE HOUSE
- CHARMING VILLAGE LOCATION
- LOVELY GARDEN SPACE
- EX-LOCAL AUTHORITY PROPERTY
- FAIR CONDITION
- NEAR LOCAL AMENITIES
- IDEAL FOR FAMILIES
- VIEWING RECOMMENDED





These sales particulars have been produced as a general guide only and we would draw to your attention that we have not carried out a detailed Survey of the property nor have we tested services, appliances or specific fittings. Whilst measurements and statements given within the details are provided in good faith, their accuracy should not be relied upon. If there are any points about which you may be uncertain or would like further clarification, we would suggest that you telephone this office and speak to our staff who will endeavour to assist you.

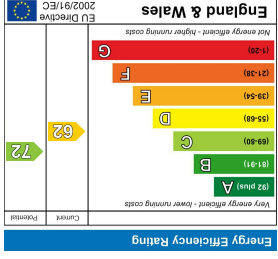

Ground Floor

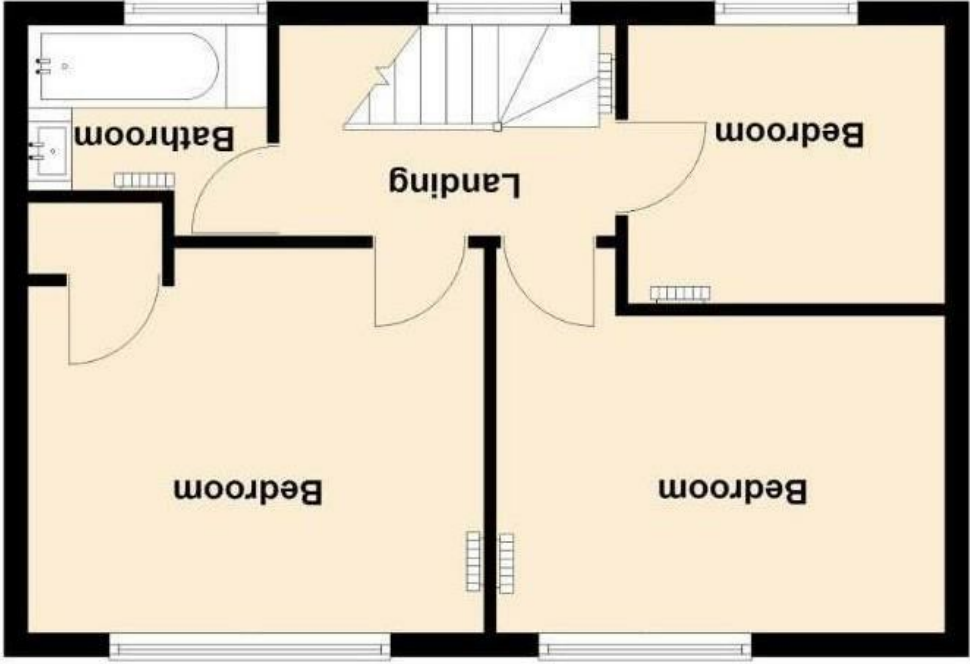

First Floor

36 High Street, Brandon, Suffolk, IP27 0AQ
 T: 01842 813466
 E: brandon@chilternsestateagents.co.uk