



Wheatsheaf Way, Linton Cambridge **Freehold**



Kevin
Henry

Key Features

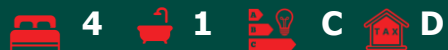

- Four bedroom semi-detached house
- Chain free
- Living room and dining room
- Good size kitchen
- Private, enclosed rear garden

This four-bedroom semi-detached house offers generous living accommodation and excellent potential for a growing family. The ground floor comprises a spacious lounge and separate dining room, along with a well-equipped kitchen and a convenient downstairs cloakroom.

Upstairs, the property features four well-proportioned bedrooms and a family shower room. Externally, there is a private rear garden, ideal for outdoor relaxation, as well as a garage en-bloc providing additional storage or parking.

While the property is in need of modernisation, it presents a fantastic opportunity to create a beautiful, personalised family home in a desirable



setting.

Linton is one of the most popular villages in south Cambridgeshire. It has an excellent range of facilities, including primary school, secondary school with outstanding sports facilities, recreation ground, village church, inns / restaurants, village store and numerous shops. It is a very vibrant village. The fine old market town of Saffron Walden is six miles to the south, whilst the university city of Cambridge is to the north-west. The M11 access points and rail links to Liverpool Street are within easy reach.

Front door to:

Porch

Hallway

Downstairs Cloakroom

Living Room

4.70m x 3.90m 15'5" x 12'10"

Dining Room

4.70m x 2.74m 15'5" x 9'0"

Kitchen

4.00m x 3.00m 13'1" x 9'10"

Conservatory

2.90m x 1.80m 9'6" x 5'11"



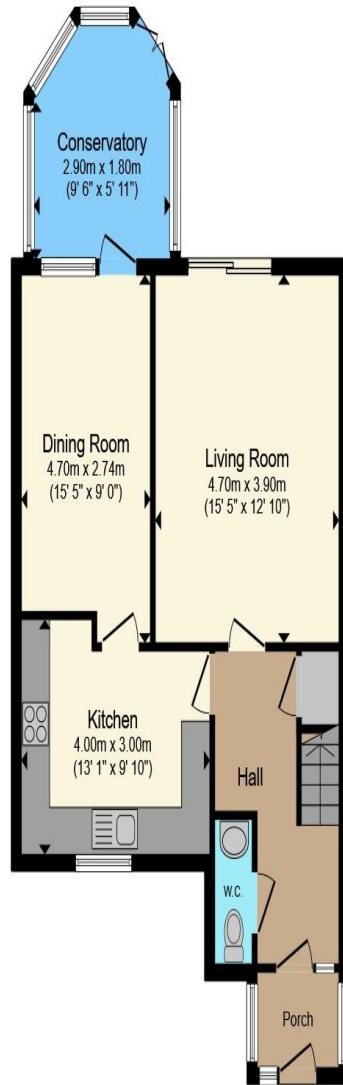

Ground Floor

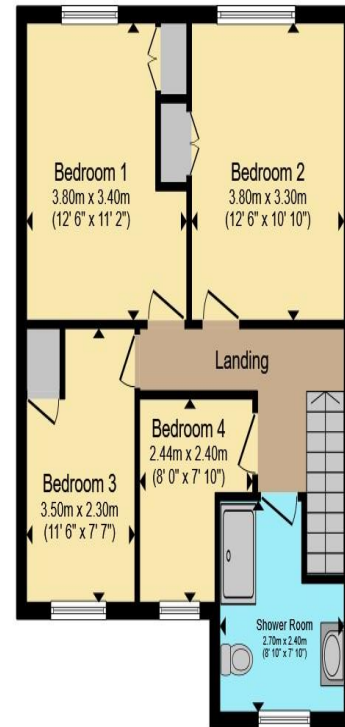

First Floor

Total floor area 117.9 sq.m. (1,269 sq.ft.) approx

This floor plan is for illustrative purposes only. It is not drawn to scale. Any measurements, floor areas (including any total floor area), openings and orientation are approximate. No details are guaranteed, they cannot be relied upon for any purpose and they do not form part of any agreement. No liability is taken for any error, omission or misstatement. A party must rely upon its own inspection(s). Powered by www.propertybox.io



Landing
Bedroom One
3.80m x 3.40m 12'6" x 11'2"
Built in cupboard.

Bedroom Two
3.80m x 3.30m 12'6" x 10'10"
Built in cupboard.
Bedroom Three
3.50m x 2.30m 11'6" x 7'7"
Built in cupboard

Bedroom Four
2.44m max x 2.40m max 8'0" max x 7'10"
max

Shower Room
Garden
Private fully enclosed rear garden.

Garage En-Bloc

Agents Note: The sale of this property is subject to receipt of Grant of Probate. Please obtain an update from the branch with regards to the potential timeframes involved.

To view this property call Kevin Henry on:
01799 513632

Selling your property?

Contact us to arrange a FREE home valuation.

 01799 513632

 1 Market Street, SAFFRON WALDEN, Essex, CB10 1JB

 sales@kevinhenry.co.uk

 www.Kevinhenry.co.uk



 SCAN ME



Kevin Henry is a trading name of Sharman Quinney Holdings Limited which is registered in England and Wales under company number 4174227, Registered Office is Cumbria House, 16-20 Hockliffe Street, Leighton Buzzard, Bedfordshire, LU7 1GN. VAT Registration Number is 500 2481 05.

1: These particulars do not constitute part or all of an offer or contract. 2: The measurements indicated are supplied for guidance only and as such must be considered incorrect. 3: Potential buyers are advised to recheck the measurements before committing to any expense. 4: Kevin Henry has not tested any apparatus, equipment, fixtures, fittings or services and it is the buyers interests to check the working condition of any appliances. 5: Kevin Henry has not sought to verify the legal title of the property and buyers must obtain verification from their legal representative. 6: Intending purchasers will be asked to produce identification documentation at a later stage and we would ask your co-operation in order that there will be no delay in agreeing the sale. Ref: SAF102909 - 0003

