



Fairfield Street, SW18

£310,000

A bright and spacious, two double bedroom purpose built apartment. It has a large reception room, separate kitchen, family bathroom and private balcony. The property further benefits from being offered chain free.

Fairfield Street is moments from Wandsworth Town. Transport nearby includes Wandsworth Town station, Earlsfield station and East Putney/Southfields on the district tube line. Also in close proximity are the gastropubs and coffee shops of Old York Road as well as Garratt Lane's selection of shops, restaurants and bars

Features

- Large Reception Room
- Two Double Bedrooms
- Family Bathroom
- Superb Location
- Private Balcony
- Chain Free

Fairfield Street, London, SW18

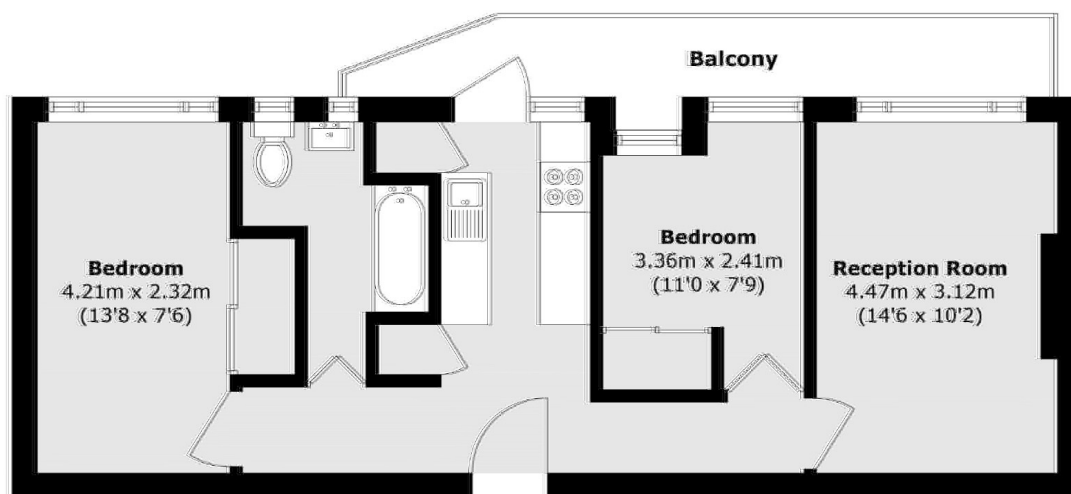

Total area (approx.): 51.4 sq. m (553.2 sq. ft)
Balcony area (approx.): 7.4 sq. m (79.6 sq. ft)