

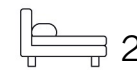

Living
made
better

Jackson Tower
Canary Wharf, E14 9BD



2



1



1



C

£2,850 PCM

Jackson Tower, Canary Wharf, E14 9BD

Madison Brook

Property Summary

Located on the thirteenth floor of the sought-after Lincoln Plaza development, this stylish two-bedroom apartment offers approximately 738 sq.ft. of modern living space in the heart of Canary Wharf. The property features a bright open-plan reception, kitchen and dining area with a bespoke fitted kitchen and integrated appliances. Both bedrooms are well-proportioned doubles, complemented by a contemporary bathroom and ample storage throughout. Residents benefit from excellent on-site facilities including a cinema, wellness centre, and gymnasium. Ideally positioned close to South Quay DLR and Canary Wharf stations, with a wide range of shops, restaurants, and local amenities nearby.

Floorplan

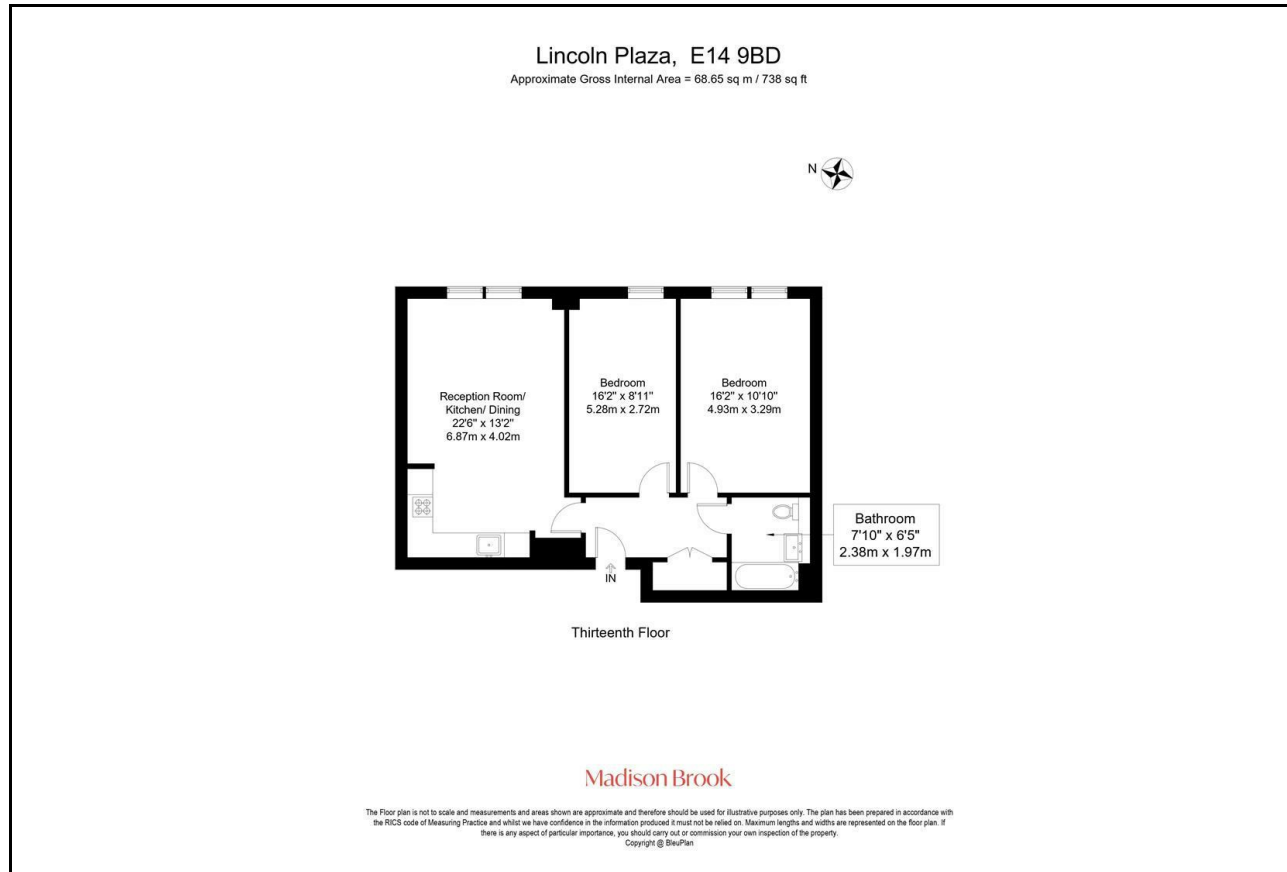

Area Map



Energy Efficiency Graph

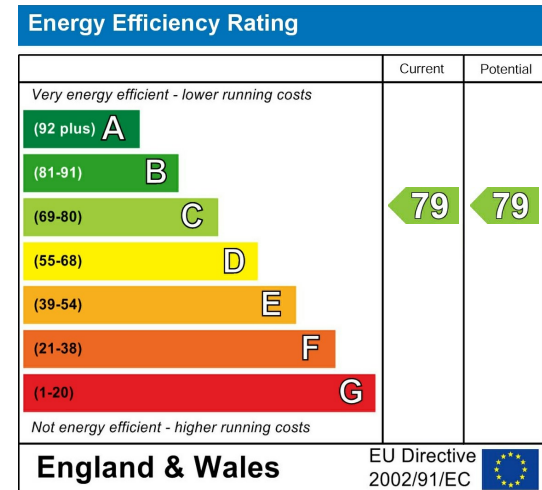

These particulars, whilst believed to be accurate are set out as a general outline only for guidance and do not constitute any part of an offer or contract. Intending purchasers should not rely on them as statements of representation of fact, but must satisfy themselves by inspection or otherwise as to their accuracy. No person in this firm's employment has the authority to make or give any representation or warranty in respect of the property.

Unit B 20 Western Gateway, Royal Victoria
Dock, London, E16 1BS
Tel: 020 3946 6000 Email:
docklands@madisonbrook.com
<https://madisonbrook.com/>