



Olympia Avenue, Choppington, NE62 5DU

£170,000

Harpers | POWERED BY **exp** UK
property people

Bedrooms: 2 | Bathrooms: 2 | Receptions: 1

Prepare to be captivated by this beautifully presented two-bedroom semi-detached home on Olympia Avenue, offering a complete one-off living experience. This exceptional residence boasts an open plan living, kitchen and dining area, highlighted by exposed brick walls and a charming log burner, creating an inviting atmosphere perfect for modern living and entertaining. The lounge room further enhances the spacious feel with French doors opening to both the front and rear of the property, providing seamless indoor-outdoor flow. Upstairs, the home continues to impress with a master bedroom featuring a luxurious freestanding bath, offering a unique and tranquil retreat. The second bedroom comes complete with fitted wardrobes, providing practical storage solutions. A modern family bathroom serves the needs of the household. Externally, the property occupies a generous plot, benefiting from ample off-street parking. The South-facing rear garden offers a delightful outdoor space for relaxation and enjoyment. Please note, this property features steel frame construction; buyers are advised to consult their lender regarding this.

- Stunning Semi Detached House
- Exceptional Open Plan Living/Kitchen/Dining
- Exposed Brick Walls & Log Burner
- Lounge Room With French Doors to Front & Rear
- Generous Plot With Off Street Parking
- Master Bedroom With Free Standing Bath
- Second Bedroom With Fitted Wardrobes
- Modern Family Bathroom
- South Facing Rear Garden
- *Steel Frame Construction* Consult Your Lender





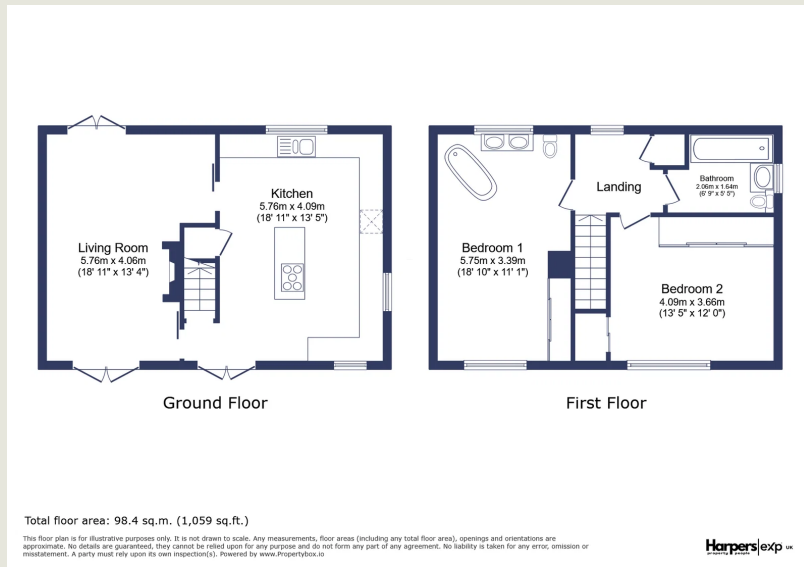

Harpers Property People

80 Windsor Gardens, Bedlington, NE22 5SY

07813 673 606

ali@harpersproperty.com

<https://harpersproperty.com>

Harpers POWERED BY exp UK
property people