

3 2 2

O/H



Gainsborough Drive, Ascot

OSBORNE HEATH

A three bedroom, two bathroom detached family home with a garage and driveway.

On the ground floor there is a living room, kitchen, spacious dining room with vaulted ceiling, downstairs shower room with a WC.

The first floor there has three bedrooms with built-in wardrobes and a family bathroom.

To the front of the property there is a front garden and driveway, access to the garage and side access to the garden

Gainsborough Drive is in the popular Blythwood development. Nearby schools include Ascot Heath, Charters, Cheapside, Heathfield, LVS, Papplewick and St. Francis. The nearest train station is Ascot where services run to London Waterloo, Reading and Guildford. By road Ascot is convenient for the M3, M4, M25 and Heathrow Airport. Nearby points of interest include Ascot Racecourse, Guards Polo Club, Legoland, The Lexicon, Sunningdale Golf Club, Wentworth Club and Windsor Great Park.

EPC rating C. Council Tax band F.





APPROXIMATE FLOOR AREA

House - 111.93 sq m - 1205 sq ft
Garage - 12.97 sq m - 140 sq ft
Total - 124.90 sq m - 1345 sq ft
(Gross Internal Area)

NOT TO SCALE

This plan is for illustration purposes only

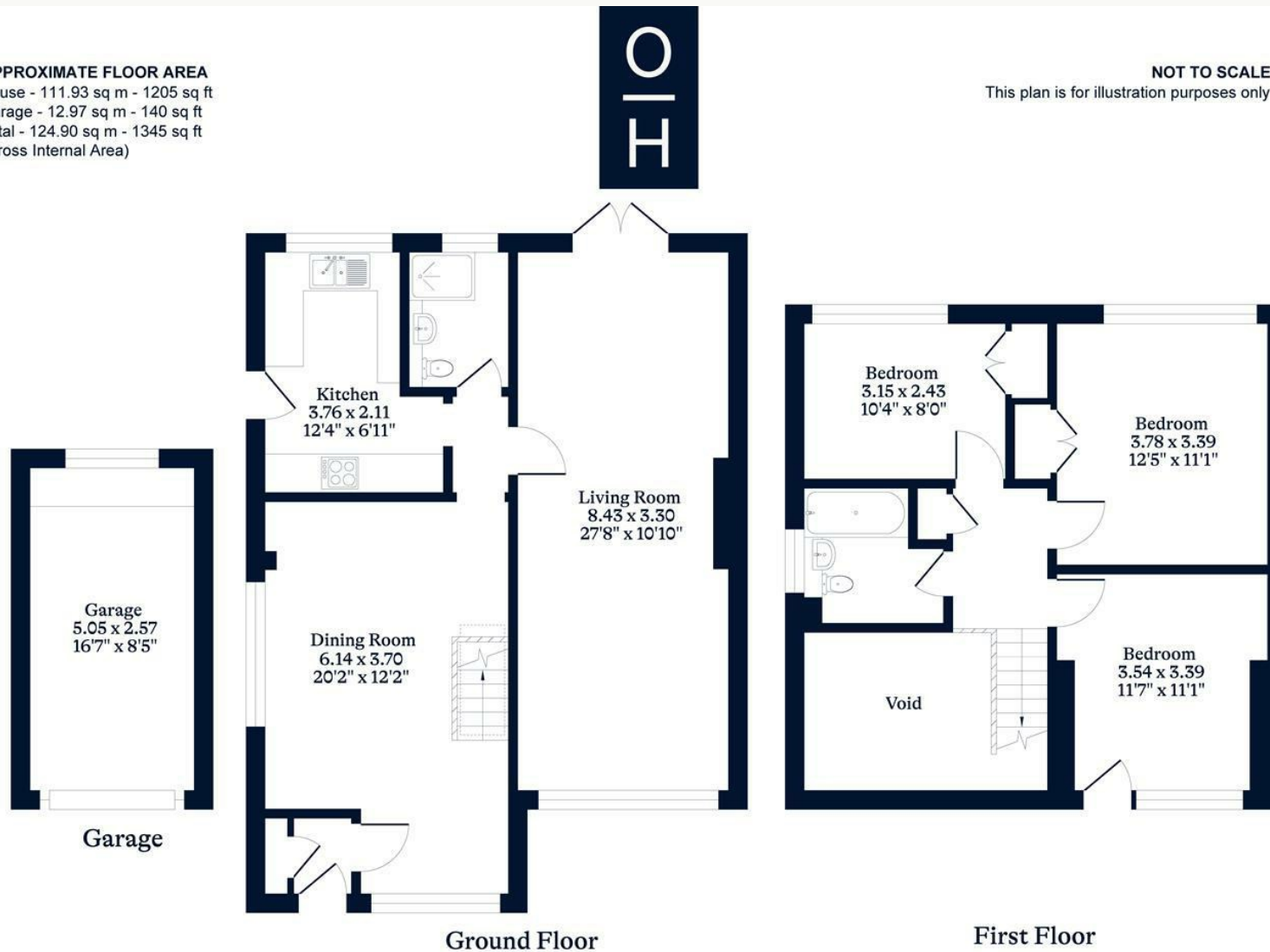

OSBORNEHEATH.CO.UK

This floor plan has been created by Property Shoot Ltd following the RICS code of measuring and is for indicative guidance only. Whilst every attempt has been made to ensure the accuracy of the floor plan contained here, measurements of doors, windows and rooms are approximate and no responsibility is taken for any error, omission or misstatement. Details shown on this floorplan, including all measurements, areas and proportions cannot be guaranteed by either the provider or estate agency and should not be relied upon.

©PROPERTYSHOOT