



1 Tregea Terrace

Portreath

St Michaels, 1 Treglea Terrace, Portreath, TR16 4NG

This attractive period cottage offers four-bedroom, two bath/shower room accommodation, combining a wealth of character features with comfortable modern living, together with a south-facing garden and private parking, all within a short, level walk of the village amenities and beautiful beach.

The location

St Michael's enjoys a discreet setting within this popular period terrace, forming part of Portreath's historic harbour village and the wider Cornwall Mining Landscape World Heritage Site. It is ideally positioned for village life, being within a level walk of the beach, harbour, local shops and cafés.

Portreath is one of the north coast's most accessible and well-loved seaside villages, with a sandy beach popular with families, surfers and bodyboarders, together with a characterful harbour and dramatic coastal scenery. The harbour wall is one of Cornwall's most distinctive coastal landmarks, while the surrounding cliffs and coastal paths provide excellent walking and far-reaching sea views.

The village offers a good range of everyday amenities, including a local supermarket, Post Office, bakery, tearoom, surf shop, cafés and public houses, one of which enjoys views over the harbour and Smuggler's Cove. The Beach Café and Atlantic Café Bar provide relaxed places to eat and drink close to the water.

Portreath is also exceptionally well placed for exploring the wider area. The Mineral Tramways and Coast to Coast routes provide superb walking and cycling opportunities, linking the village with Cornwall's historic mining landscape and the south coast at Devoran. Tehidy Country Park, Gwithian, Godrevy, St Agnes and Truro are all within easy reach, making this an appealing base for those seeking coastal living, outdoor pursuits and access to some of Cornwall's most celebrated countryside and coastline.





The property

- Beautifully presented period home
- Level walk to the beach
- Currently used as a successful holiday let
- Full width sitting room
- Contemporary kitchen / dining room
- Utility and downstairs cloakroom
- Principal bedroom with en suite shower room
- Three further bedrooms
- Family bathroom
- No onward chain

The Garden and Parking

- Deep front garden and terrace
- Low maintenance south facing garden
- Two parking spaces



Distances

Portreath beach and harbour – 350 yards;
Tehidy woods golf club – 1.8;
Redruth (mainline rail) – 4.5; Porthtowan – 4.5;
Gwithian beach – 7.5; Chapel Porth (St Agnes) – 7.5;
Truro – 13.5; Cornwall Airport (Newquay) – 28

(All distances are approximate and in miles)

Tenure, services and general information

Freehold. Mains electricity, water and drainage.
Comprehensive inventory of furnishings available by separate negotiation
Council Tax: band C (currently benefitting from small business relief)
Broadband: FTTP (source: www.openreach.com/broadband-network/fibre-availability)

Directions

Travel into Portreath on the B3301. Turn left into Glenfeadon Terrace. Go over the bridge and turn right into Tregrea Terrace. The property's parking spaces are immediately on the left.

What 3 Words

/// refills.safe.sunset



Tregea Terrace, Portreath, TR15

Main House = 926 sq ft / 86 sq m

For identification only - Not to scale

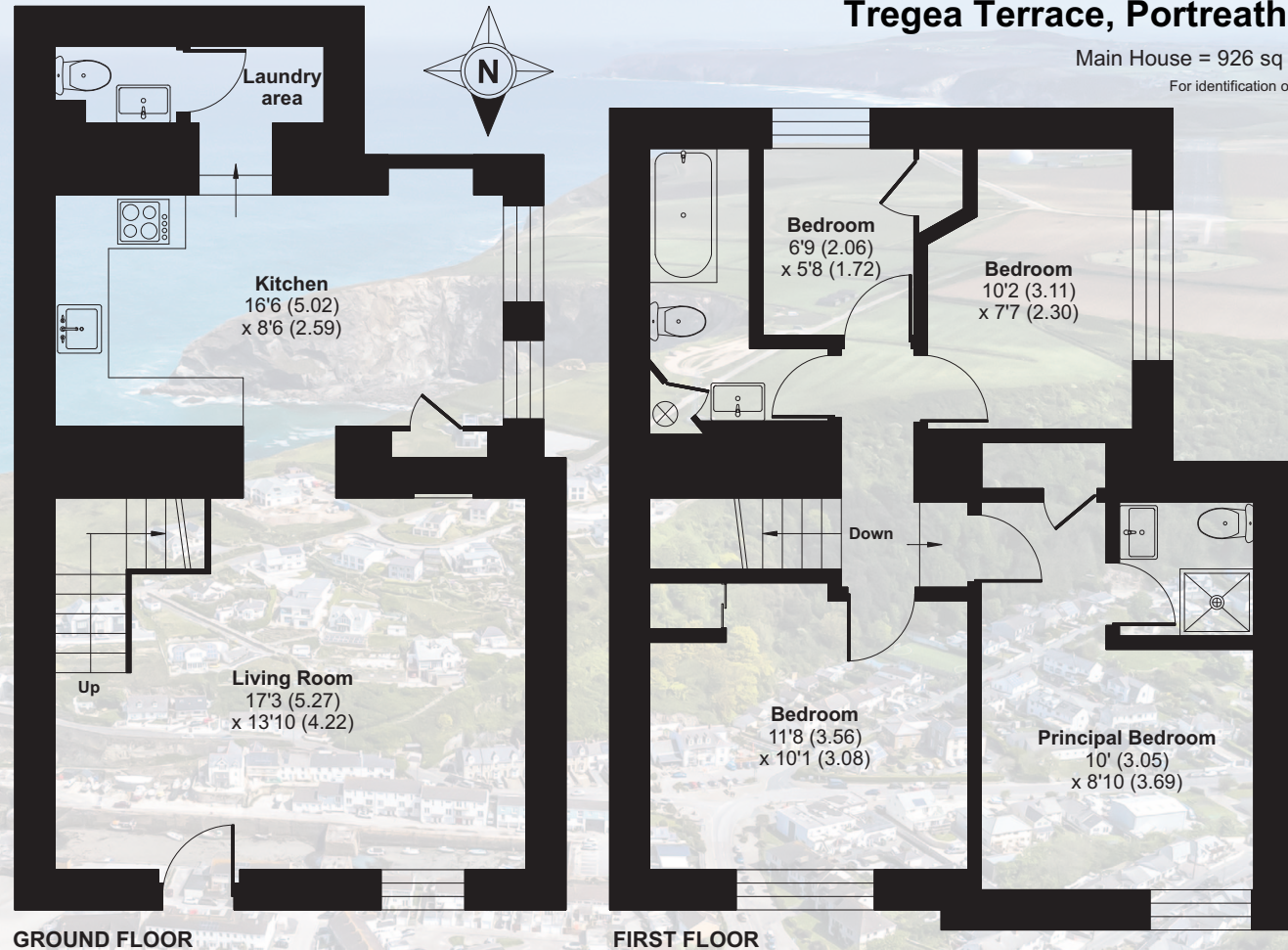

Score	Energy rating	Current	Potential
92+	A		
81-91	B		
69-80	C		72 C
55-68	D		
39-54	E		
21-38	F	33 F	
1-20	G		

Floor plan produced in accordance with RICS Property Measurement 2nd Edition, Incorporating International Property Measurement Standards (IPMS2 Residential). © nitchecom 2026. Produced for Shore Partnership Limited. REF: 1463122

FIXTURES AND FITTINGS Only those fixtures and fittings mentioned specifically in the sales particulars are to be included in the sale. All others (including light fittings not mentioned, furniture, garden furniture, garden ornaments etc) are not included but may be available by separate negotiation.

IMPORTANT NOTICE Shore Partnership, their clients and any joint agents give notice that: 1. They are not authorised to make or give any representations or warranties in relation to the property either here or elsewhere, either on their own behalf or on behalf of their client or otherwise. They assume no responsibility for any statement that may be made in these particulars. These particulars do not form part of any offer or contract and must not be relied upon as statements or representations of fact. 2. Any areas, measurements or distances are approximate. The text, images and plans are for guidance only and are not necessarily comprehensive. It should not be assumed that the property has all necessary planning, building regulation or other consents and Shore Partnership has not tested any services, equipment or facilities. Purchasers must satisfy themselves by inspection or otherwise.



Ben Standen
Consultant



Tim May
Director



Ben Davies
Director

WHERE YOU LIVE MATTERS

Telephone: 01872 484484
Email: contact@shorepartnership.com

School House Office, Market Street,
Devoran, Truro, Cornwall, TR3 6QA

