



Kilburn Park Road

London, NW6

£1,750 per month
(£403.85 per week)

Lovely one bedroom flat situated on the ground floor of a lovely period conversion. The property is bright with a modern kitchen and bathroom and available fully furnished.

CHESTERTONS



Kilburn Park Road

London, NW6

- One bedroom
- Furnished
- Separate kitchen
- 507 SQFT
- EPC D



Lovely one bedroom flat situated on the ground floor of a lovely period conversion. The property is bright with a modern kitchen and bathroom and available fully furnished.

Kilburn Park Road is ideally situated moments away from Kilburn Park underground station and close to all the local amenities of Kilburn.

Minimum Term: 12 months
Deposit Required: 5 weeks
Local Authority: Westminster
Council Tax Band: C
EPC Rating: D
Furnished

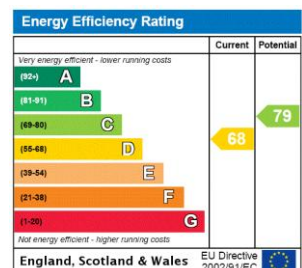

Chestertons Little Venice Lettings

26 Clifton Road
 Maida Vale
 London
 W9 1SX
 littlevenicelettingsusers@chestertons.co.uk
 02072662369
 chestertons.co.uk

Additional tenant charges apply (fees apply to non-AST tenancies only)
 Tenancy Agreement Fee: £300
 References per Tenant/Guarantor: £60
 Inventory check (approx. £100 – £250 inc. VAT)
chestertons.co.uk/property-to-rent/applicable-fees



Kilburn Park Rd, NW6

CAPTURE DATE 15/03/2023 LASER SCAN POINTS 22,163,881

GROSS INTERNAL AREA

47.15 sqm / 507.52 sqft

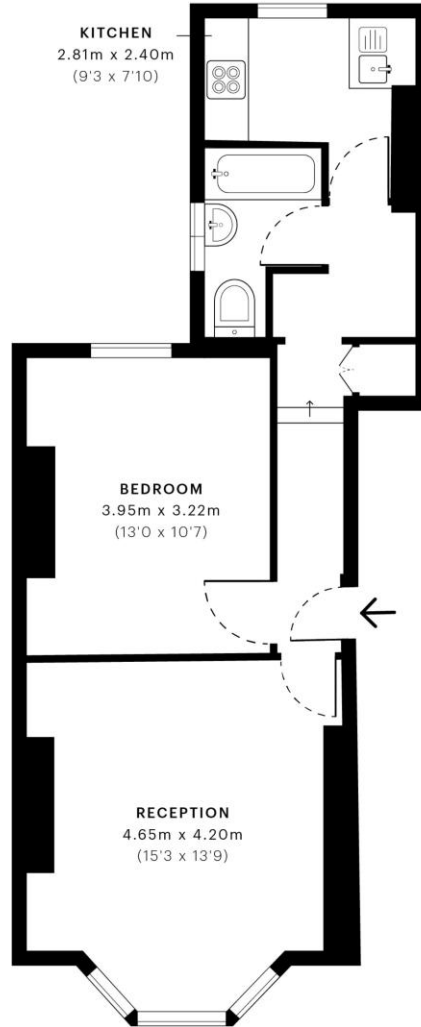

— First Floor

 **GROSS INTERNAL AREA (GIA)**
The footprint of the property
47.15 sqm / 507.52 sqft

 **NET INTERNAL AREA (NIA)**
Excludes walls and external features
Includes walkrooms, restricted head height
43.47 sqm / 467.91 sqft

 **EXTERNAL STRUCTURAL FEATURES**
Balconies, terraces, verandas etc.
0.00 sqm / 0.00 sqft

 **RESTRICTED HEAD HEIGHT**
Limited use area under 1.5 m.
0.00 sqm / 0.00 sqft



Spec Verified floor plans are produced in accordance with Royal Institution of Chartered Surveyors' Property Measurement Standards. Plans and gardens are illustrative only and excluded from all area calculations. Due to rounding, numbers may not add up precisely. All measurements shown for the individual room lengths and widths are the maximum points of measurements captured in the scan.

IPMS 2B RESIDENTIAL 43.90 sqm / 470.04 sqft
IPMS 3C RESIDENTIAL 43.83 sqm / 470.94 sqft

SPEC ID 5640f098975a13a0dcea19bcc

Chesterton UK Services Limited trading as Chestertons for themselves and for the vendor of this property whose agents they are, give notice that (i) these particulars do not constitute any part of an offer or contract, (ii) all statements contained within these particulars are made without responsibility on the part of Chestertons or the vendor, (iii) whilst made in good faith, none of the statements contained within these particulars are to be relied upon as a statement or representation of fact, (iv) any intending purchasers must satisfy themselves by inspection or otherwise as to the correctness of each of the statements contained within these particulars, (v) the vendor does not make or give either Chestertons or any person in their employment any authority to make or give representation or warranty whatsoever in relation to this property. Wide angle lenses may be used. ©Copyright Chestertons | Chesterton Global Ltd | Registered Office 5th Floor, The Lantern, 75 Hampstead Road, London, NW1 2PL Registered Company Number 05334580.



This paper is 100% recyclable