



288 St. Helens Road

, Leigh, WN7 3PD

Offers in excess of £195,000

JonesPottsTaylor are delighted to present FOR SALE this deceptively spacious two bedroom end terraced property. Situated in a popular residential location in Leigh, central to transport and network links, within walking distance to Pennington Flash Nature Reserve, schools, shops and amenities. The property briefly comprises of; entrance porch, living room, an open plan style kitchen / dining room / reception room, utility and downstairs W.C / cloakroom. To the first floor are two double bedrooms, master with ensuite shower room, and a further family bathroom with four piece suite. Outside to the front and rear are enclosed low maintenance gardens, with the rear benefitting from double gates providing off road parking..

Viewings for this property are a must to appreciate its sought after location and high refurbishment / decor standard.

- Extended Two Bedroom End Terrace
- Close To Transport & Network Links
- Within Walking Distance To Pennington Flash Nature Reserve
- Two Reception Rooms
- Off Road Parking
- Gas Central Heating & UPVC Double Glazing

Viewing

Please contact our Jones Potts Taylor Office on 01942 368600 if you wish to arrange a viewing appointment for this property or require further information.

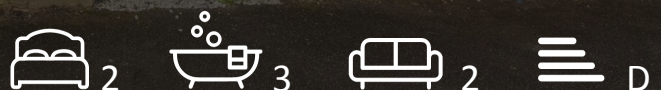

Floor Plan

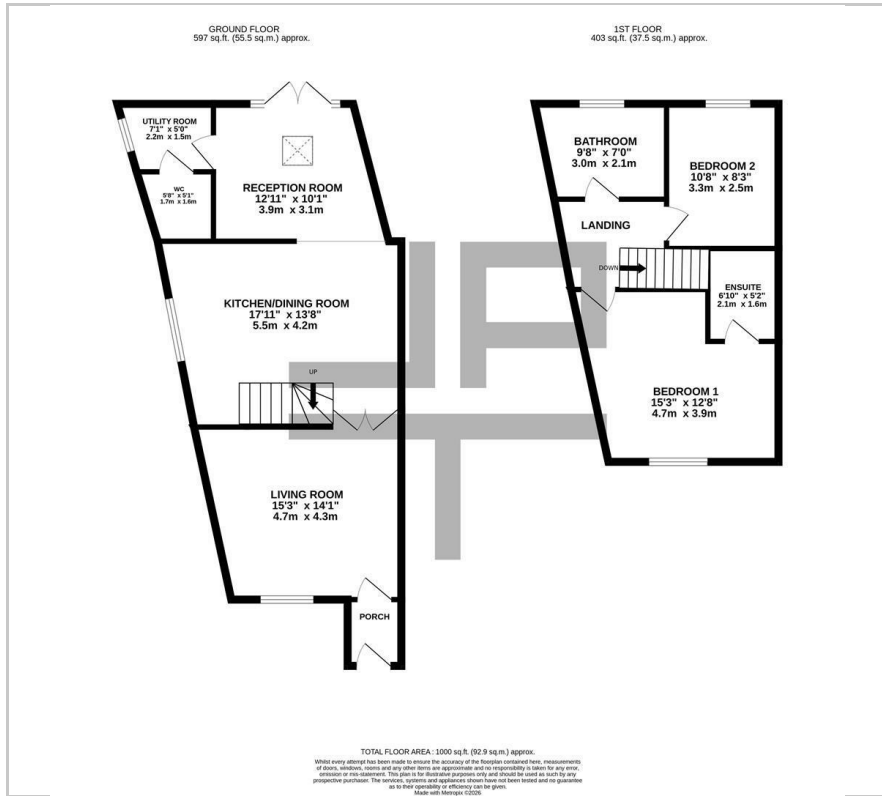

Area Map

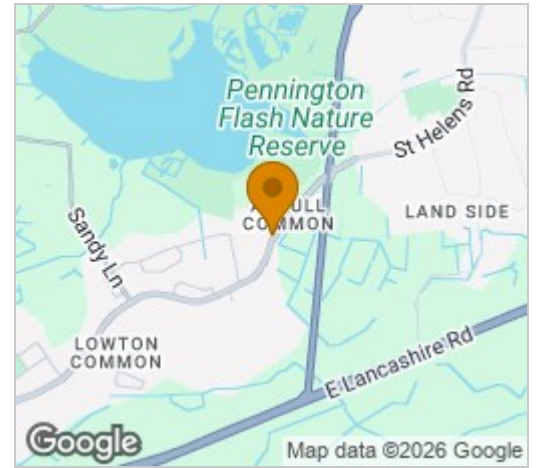

Energy Efficiency Graph

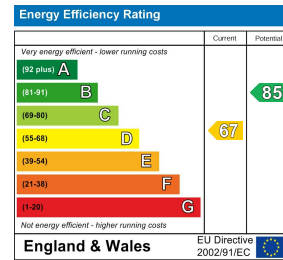

These particulars, whilst believed to be accurate are set out as a general outline only for guidance and do not constitute any part of an offer or contract. Intending purchasers should not rely on them as statements of representation of fact, but must satisfy themselves by inspection or otherwise as to their accuracy. No person in this firm's employment has the authority to make or give any representation or warranty in respect of the property.