

Cecil Close, W5

£550,000

Set within a sought-after 1930s mansion block, this three-bedroom ground floor flat is offered chain free and in good condition. Offering over 860 sq ft of living space, it feels bright and well-proportioned, with comfortably sized rooms that are easy to live in. Added benefits include an allocated parking space and access to well-kept communal gardens, giving a nice sense of space and convenience.

Features

Three Double Bedrooms
Share of Freehold
No Onward Chain

Cecil Close, London, W5

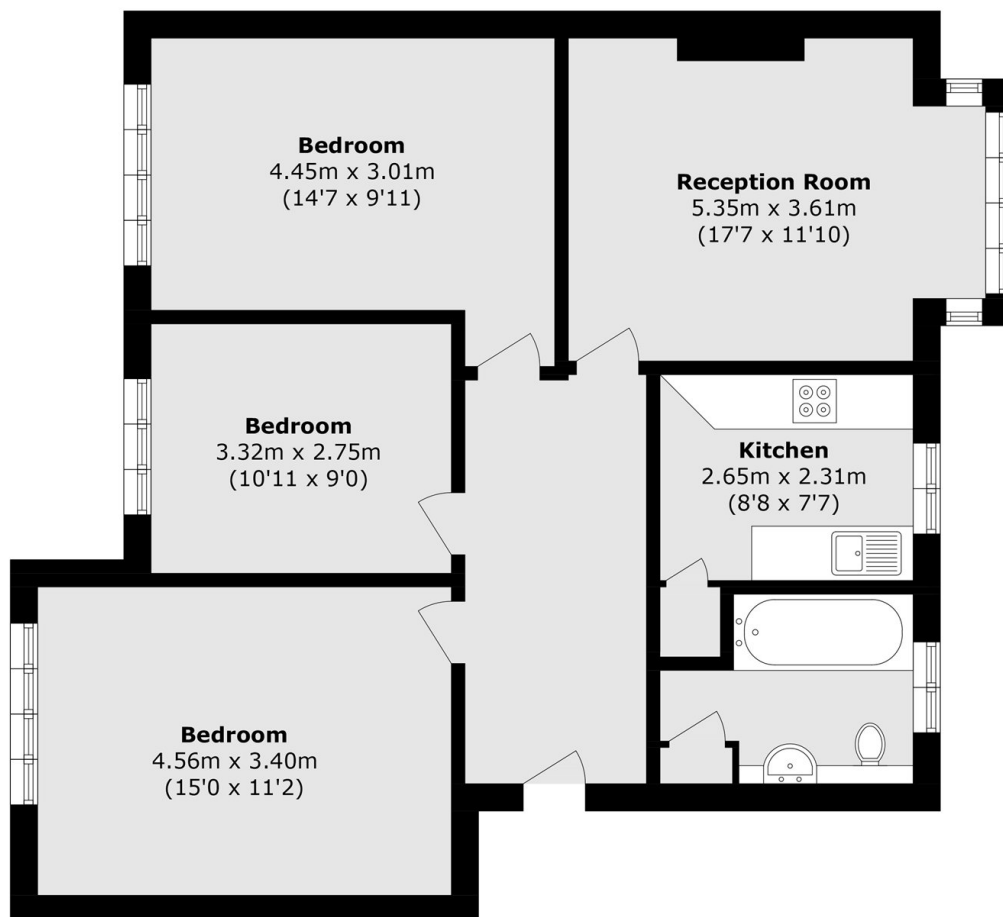

Total area (approx.): 79 sq. m (850.3 sq. ft)