



St Andrews Road, Warminster



£310,000



Key Features

- Detached Garage
- Private Garden
- Driveway
- EPC rating D
- Freehold



Charming semi-detached home in sought-after Warminster, featuring sunny garden, garage, parking, and excellent transport links—perfect for comfortable, convenient living.

The ground floor comprises a bright and welcoming reception room, featuring large windows that allow plenty of natural light and a charming fireplace, with pleasant views over the garden. The kitchen is well-equipped with built-in pantries, wooden worktops, and a dedicated breakfast area, creating an ideal space for everyday dining.

Upstairs, the property offers two generously sized double bedrooms and a third single bedroom, suitable as a child's room, home office, or guest space. The bathroom is fitted with a heated towel rail for added comfort.

Externally, the home benefits from a south-facing garden—perfect for enjoying sunny days—as well as off-road parking and a single garage, providing valuable storage and convenience.

The property is conveniently located close to local schools and parks, with a variety of scenic walking routes nearby. Warminster town centre offers a range of shops, cafés, and everyday amenities, all within easy reach.

Transport links are excellent, with Warminster railway station providing regular services to Salisbury, Bath, and Bristol. Typical journey times are approximately 25–35 minutes to Salisbury and 35–45 minutes to Bath. The nearby A36 also offers convenient road connections to surrounding areas.

The property has an EPC rating of D and falls within Council Tax Band B.







Approx Gross Internal Area
71 sq m / 769 sq ft

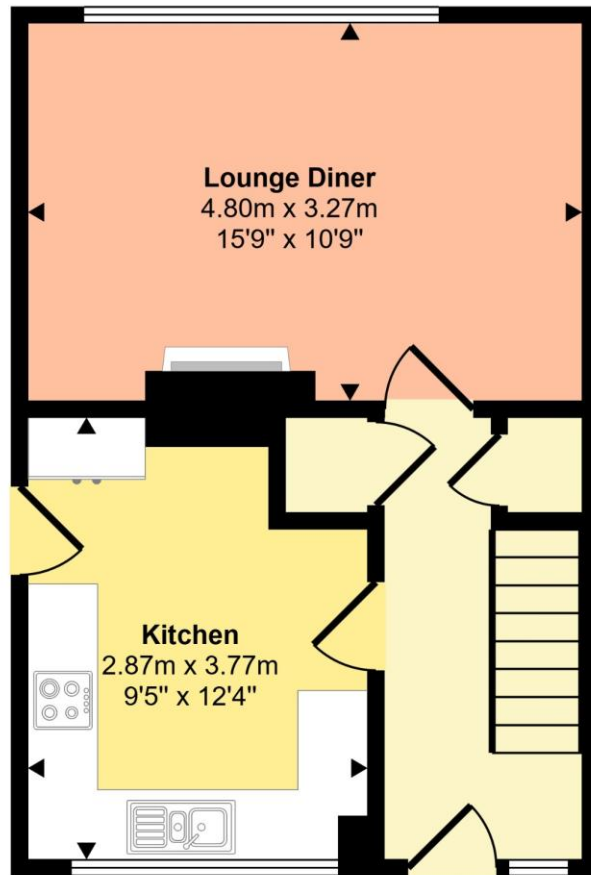

Ground Floor

Approx 34 sq m / 370 sq ft

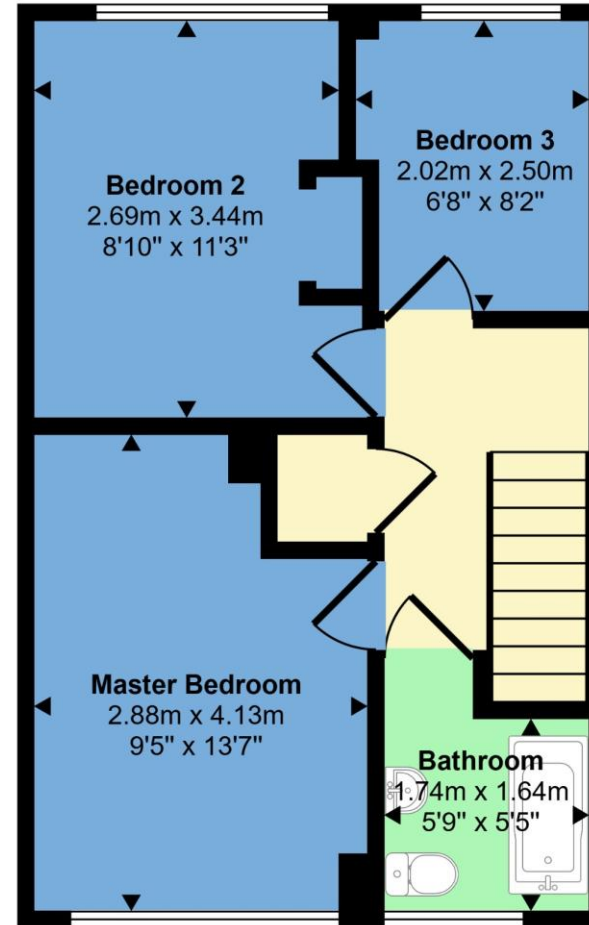

First Floor

Approx 37 sq m / 399 sq ft

This floorplan is only for illustrative purposes and is not to scale. Measurements of rooms, doors, windows, and any items are approximate and no responsibility is taken for any error, omission or mis-statement. Icons of items such as bathroom suites are representations only and may not look like the real items. Made with Made Snappy 360.

