

Broadlands, TW13

£510,000

This is a fantastic two bedroom bungalow that falls within the Richmond Borough. There is a large garage with rear access, a large wrap around garden and and further potential to extend (STPP).

Located near the A316, Broadlands is on the border of Twickenham and is close to the local leisure centre, shops and a range of primary and secondary schools.

Features

- Two Bedrooms
- Good Condition
- Semi-Detached
- Potential To Extend (STPP)
- Private Garden
- Garage

Broadlands, Hanworth, TW13

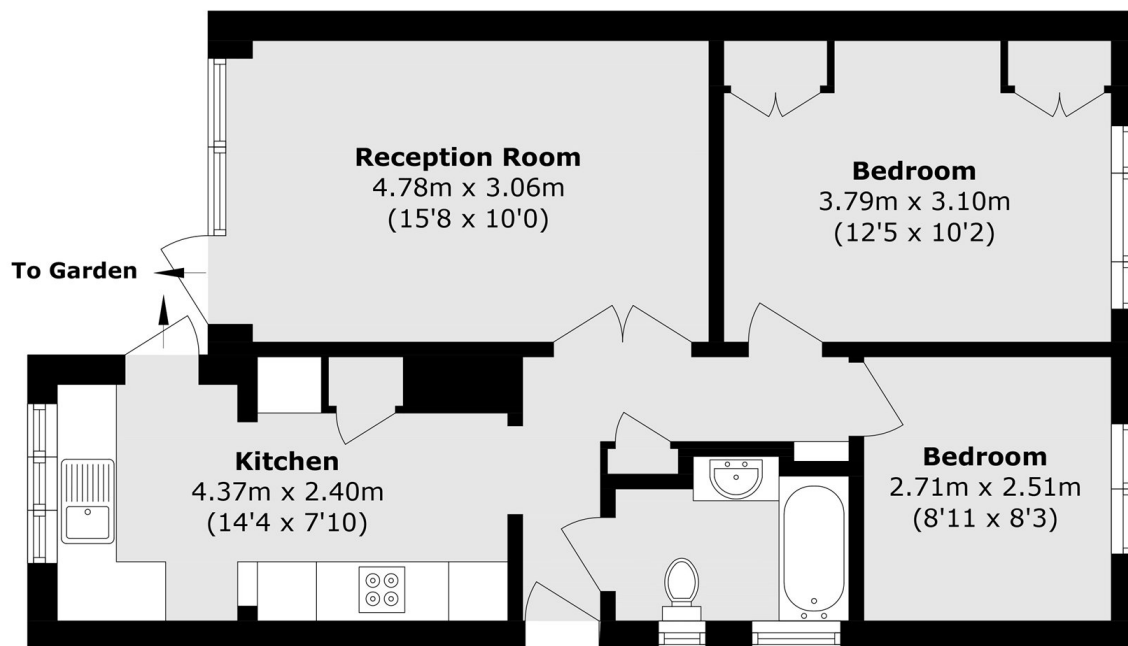

Total area (approx.): 56.6 sq. m (609.2 sq. ft)