



# 89 Mansfield Crescent

Armthorpe, DN3 2AR

## Asking Price £180,000

A fantastic opportunity to purchase a recently renovated and substantially extended three bedroom semi-detached house offering a modern and stylish living space in the sought after village of Armthorpe.

The property in brief comprises; entrance hallway, stunning extended open plan kitchen/dining room, lounge, office/playroom, cloaks/WC, three bedrooms and family bathroom.

Outside, you will find a double width driveway along with a detached garage, providing additional storage or workshop space. The private enclosed rear garden is predominantly laid to lawn with patio seating area. Ideally located close to local amenities, reputable schools and motorway connections and offered for sale with NO ONWARD CHAIN early viewing is highly recommended.

- Semi detached house
- Three bedrooms
- Recently renovated and substantially extended
- Stunning open plan kitchen/dining room
- Lounge and office/playroom
- Downstairs WC
- Double width driveway and detached garage
- Private rear enclosed garden
- Close to local amenities, reputable schools and transport links
- No onward chain

### Viewing

Please contact our Office on 01302 751616 if you wish to arrange a viewing appointment for this property or require further information.

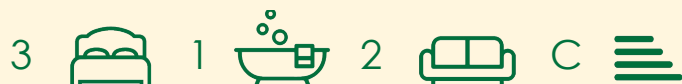

# Floor Plan

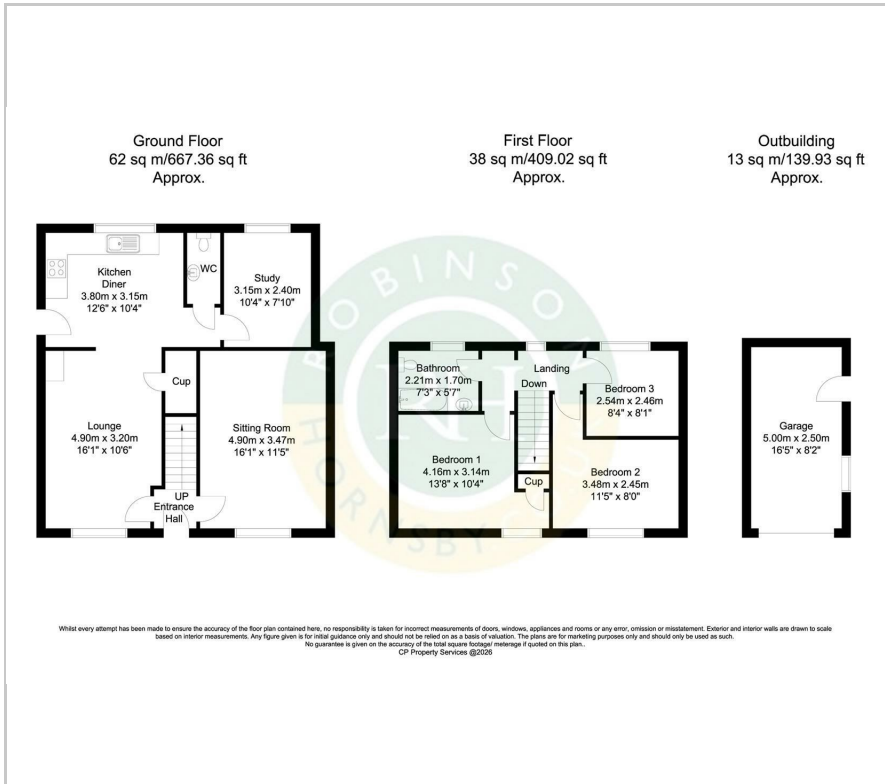

# Area Map



# Energy Efficiency Graph

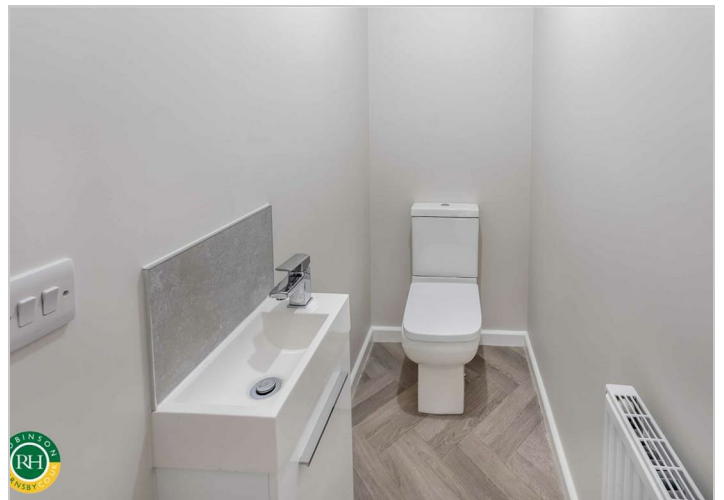
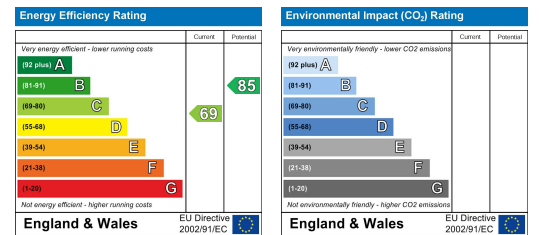

These particulars, whilst believed to be accurate are set out as a general outline only for guidance and do not constitute any part of an offer or contract. Intending purchasers should not rely on them as statements of representation of fact, but must satisfy themselves by inspection or otherwise as to their accuracy. No person in this firm's employment has the authority to make or give any representation or warranty in respect of the property.