



SUTHERLAND AVENUE, W9

£725,000

An exceptionally well presented and generously proportioned two bedroom garden flat, benefiting from its own private entrance. The bay fronted reception room leads through to a modern kitchen, while the

Two bedrooms
Period conversion
Excellent condition

Private rear garden
Private entrance
Approx. 798sq ft.

STEP INSIDE SUTHERLAND AVENUE

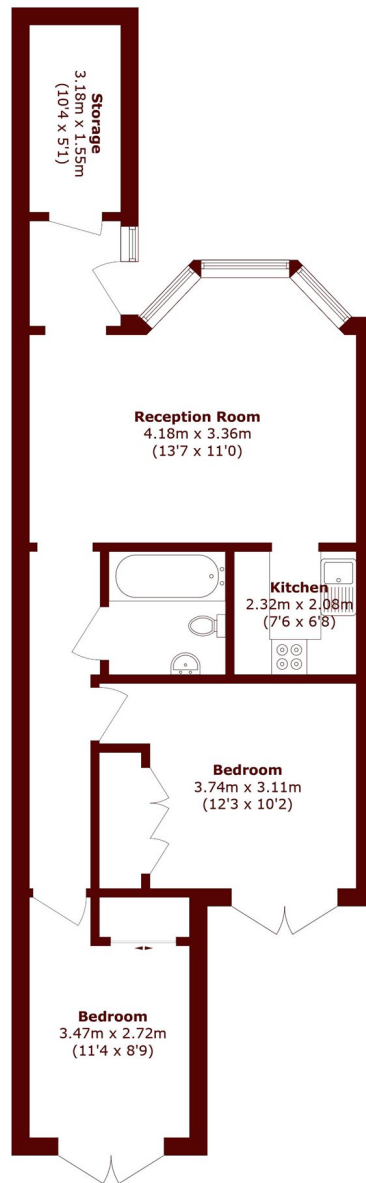

Total area (approx.): 74.2 sq. m (798.7 sq. ft)

Little Venice
020 7993 3050

Energy Rating: C We aim to make our particulars both accurate and reliable. However, they are not guaranteed; nor do they form part of an offer or contract. If you require clarification on any points then please contact us, especially if you're traveling some distance to view. Please note that appliances and heating systems have not been tested and therefore no warranties can be given as to their good working order

**MARSH &
PARSONS**