

BRUCE MATHER

INDEPENDENT ESTATE AGENT



9 Mallow Gardens, Boston, PE21 9EL

Asking Price £199,000

A three bedroom turn-key, terrace house, newly redecorated, located opposite Pilgrim Hospital, just outside Boston, Lincolnshire NO CHAIN. Upstairs comprises of three bedrooms and two bathrooms, the master having an ensuite. Downstairs the entrance hall has a kitchen, WC and a reception room with French Doors to the fenced in grassed garden. To the front there is abundant off-road parking as well as a garage to the side. Hot water and heating is via a gas combi. The property is located in a recently built cul-de-sac in Boston, where you have all your amenities on your doorstep including schools and restaurants, plus the Pilgrim Hospital just a short walk away.

Please call Bruce Mather Estate Agents on 01205 365032 to arrange a viewing.

Floor Plan

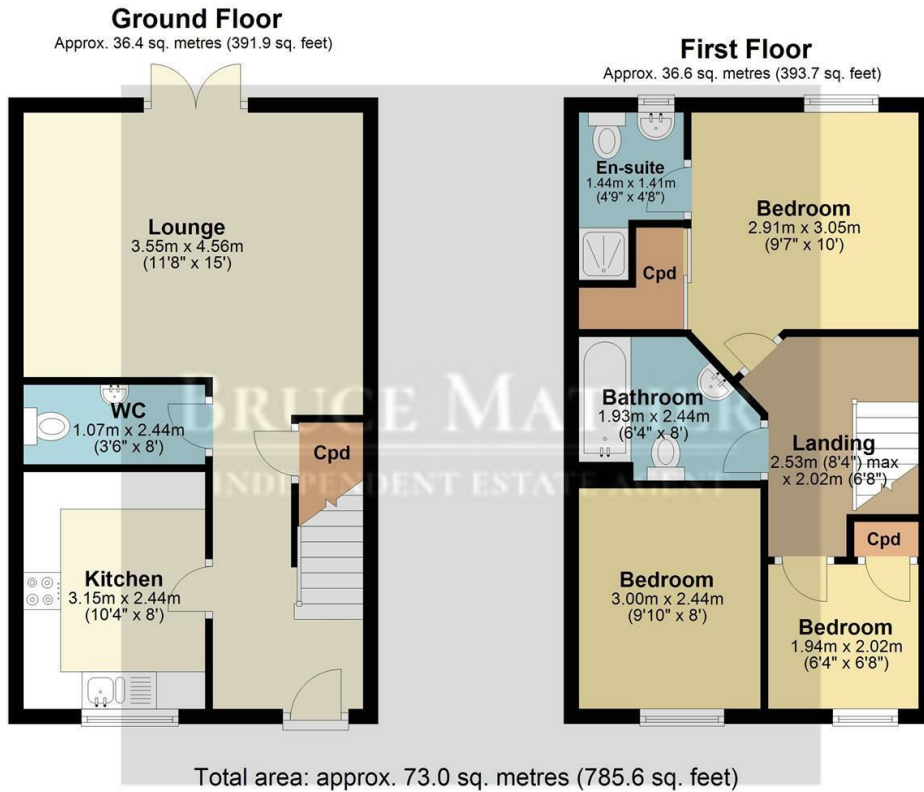

All images used are for illustrative purposes. Images are for guidance only and may not necessarily represent a true and accurate depiction of the condition of property. Floor plans are intended to give an indication of the layout only. All images, floor plans and dimensions are not intended to form part any contract.
Plan produced using PlanUp.

Website Link



Area Map

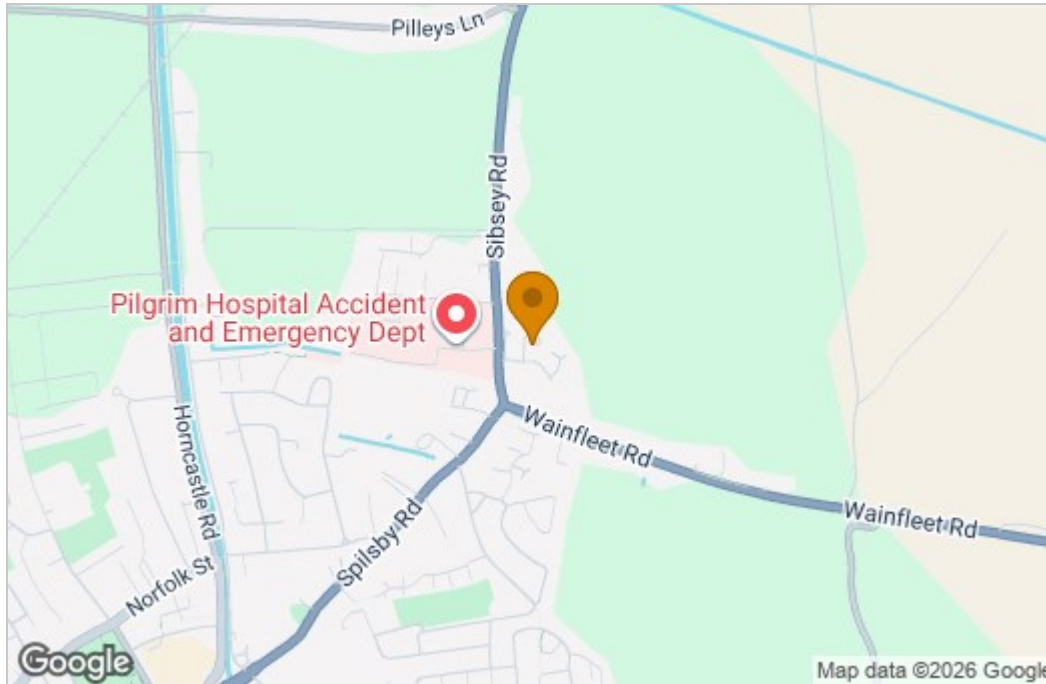

Energy Efficiency Graph

Energy Efficiency Rating		Current	Potential
Very energy efficient - lower running costs			
(92 plus) A			
(81-91) B		88	89
(69-80) C			
(55-68) D			
(39-54) E			
(21-38) F			
(1-20) G			
Not energy efficient - higher running costs			
England & Wales		EU Directive 2002/91/EC	



These particulars, whilst believed to be accurate are set out as a general outline only for guidance and do not constitute any part of an offer or contract. Intending purchasers should not rely on them as statements of representation of fact, but must satisfy themselves by inspection or otherwise as to their accuracy. No person in this firm's employment has the authority to make or give any representation or warranty in respect of the property.