



15 Thirlmere Grove, Royton, Oldham, OL2 6SZ

Offers In Region Of £224,950

 3  1  1



- No Chain
- Three Bedrooms
- Great Location
- Garage
- Semi Detached
- Large Kitchen/Dining Room
- Views Over Farmland
- EPC: D



NO CHAIN. Offered for sale is this sweet three bedroom semi detached family home.

Located in a popular part of Royton not to far from the town centre.

Accommodation comprising: Entrance hallway, lounge and a large kitchen/dining room.

To the first floor are three bedrooms and a shower room.

Externally is a lovely rear garden, detached garage to the rear and a small garden to the front.

Lovely views over open farmland.

Contact us to arrange a viewing.

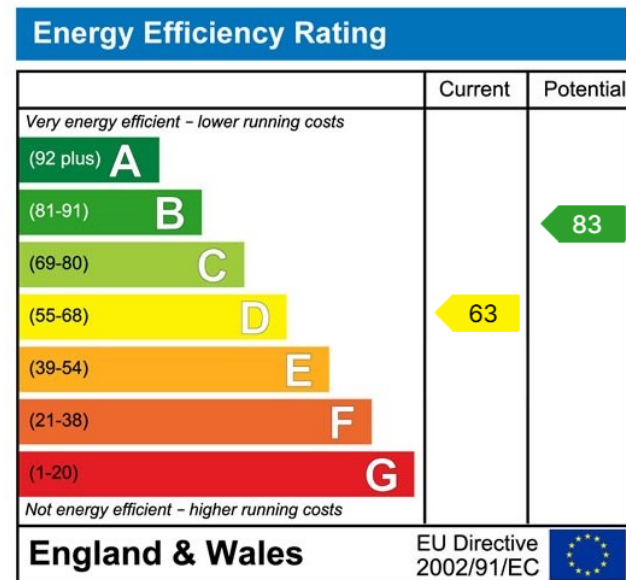
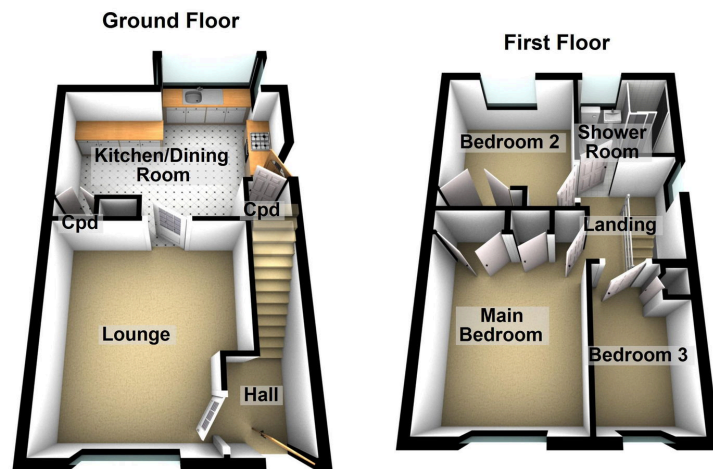

Chadderton Office

509 Middleton Road,
Chadderton, Oldham,
OL9 9SH

chadderton@kirkham-property.co.uk
t: 0161 626 5688