

Hansom Drive, Atherton, M46 0SE
Offers Over £365,000

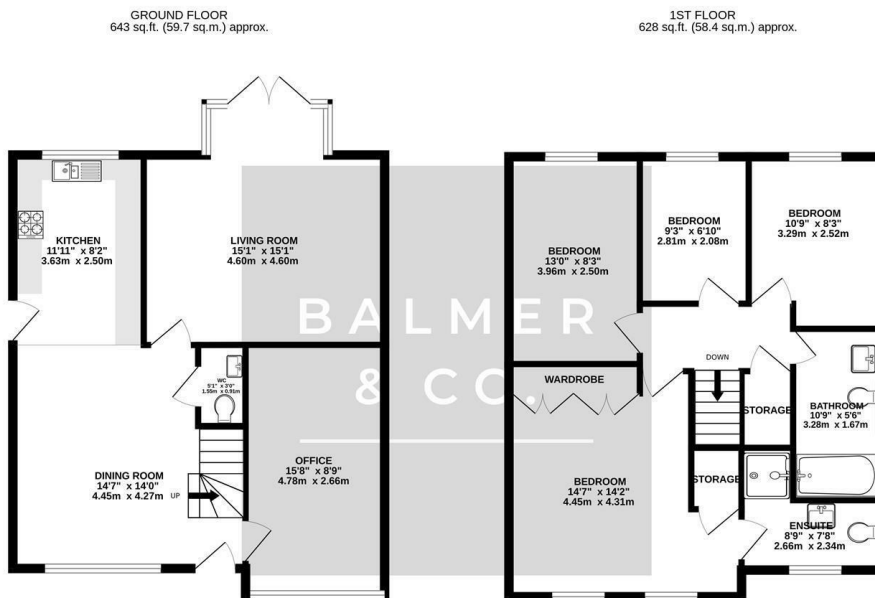

BALMER & CO in ATHERTON are delighted to offer FOR SALE this four bedroom detached family home, tucked away on Hansom Drive, a popular and well regarded location in the Howe Bridge area of Atherton. Well presented throughout and conveniently placed for access to both Atherton and Leigh town centres offering a range of amenities including shops, schools and transport links, it would make a perfect family home. The ground floor comprising in brief; living room with patio doors to the rear garden, open plan kitchen/dining room, garage conversion creating a second sitting room/office space and a downstairs wc. To the first floor is a large master bedroom with an en-suite shower room, two further double bedrooms, a single bedroom and a three piece family bathroom suite. Externally, the property has driveway parking for 3/4 vehicles to the front with an electric vehicle charger. To the rear is an elevated garden offering a fantastic level of privacy as it is not overlooked. Early viewings highly recommended, all enquiries welcome.

Floor Plan



Area Map

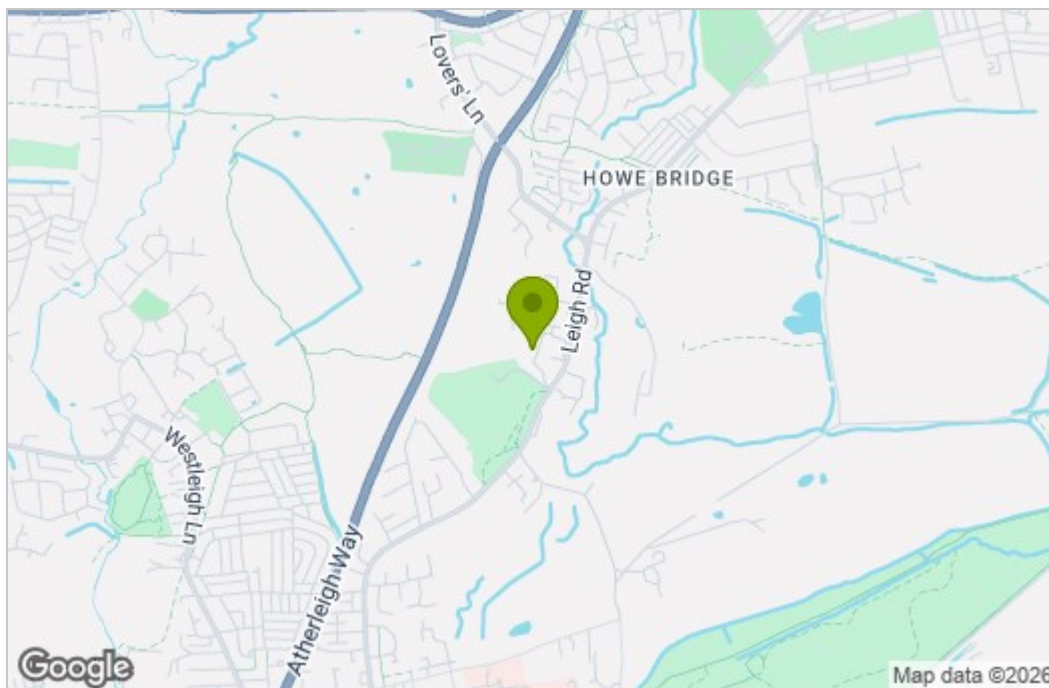

Energy Efficiency Graph

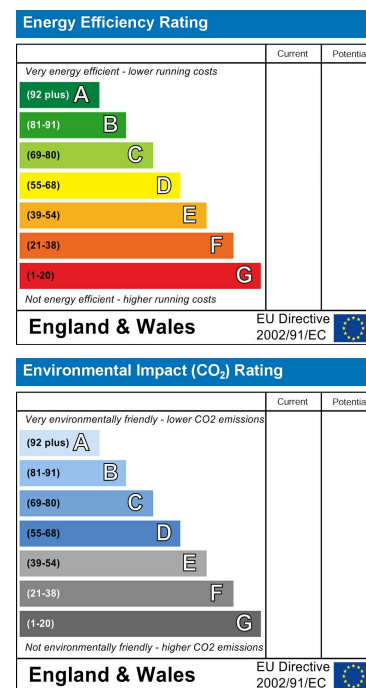

These particulars, whilst believed to be accurate are set out as a general outline only for guidance and do not constitute any part of an offer or contract. Intending purchasers should not rely on them as statements of representation of fact, but must satisfy themselves by inspection or otherwise as to their accuracy. No person in this firm's employment has the authority to make or give any representation or warranty in respect of the property.