

# THE HOME AGENCY

*'Passion for property.'*



102 The Grove, Sholing, Southampton, SO19 9LU

Asking Price £299,999

- Semi Detached
- No Forward Chain
- Open Plan Lounge/Diner
- Sought After Location
- Decked Garden
- Utility Room
- Gas Central Heating
- Modern Kitchen
- Two Double Bedrooms
- Garage

## 102 The Grove

Approximate Gross Internal Area  
872 sq ft - 81 sq m

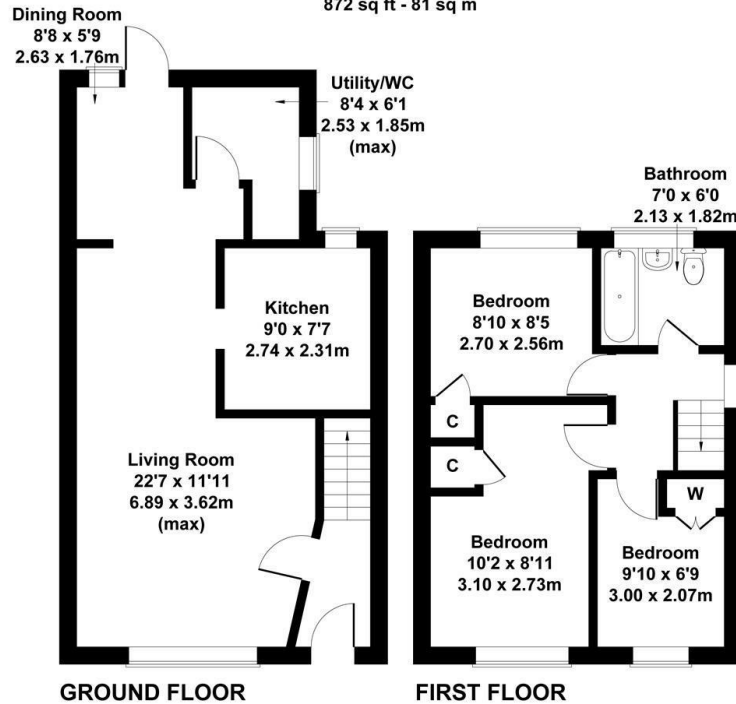

Not to Scale. Produced by The Plan Portal 2026  
For Illustrative Purposes Only.

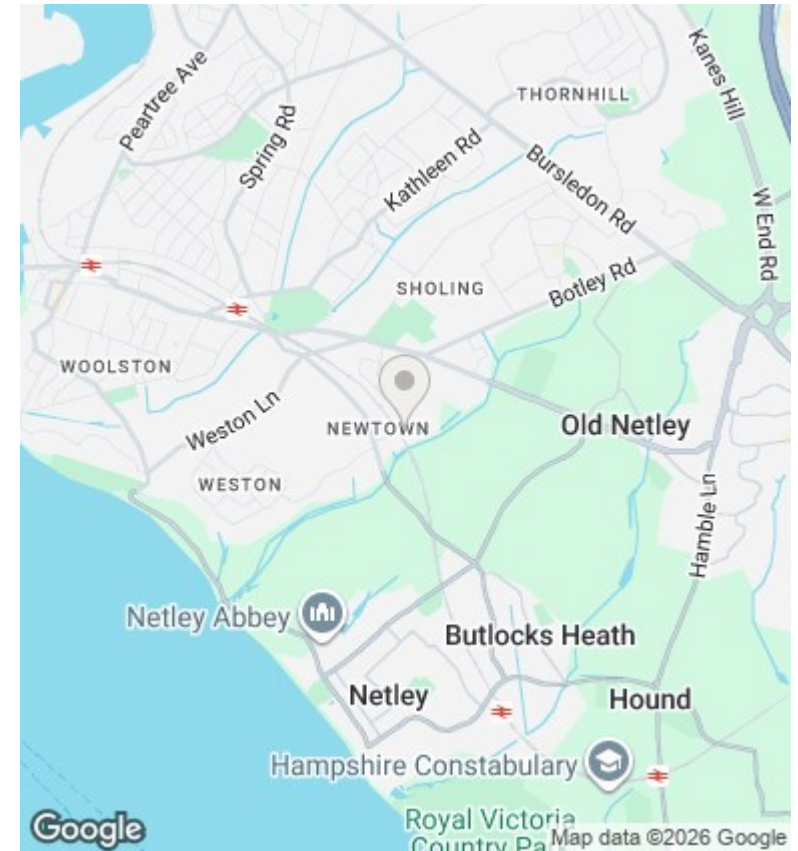

### Directions

### Viewings

Viewings by arrangement only. Call 02380 632632 to make an appointment.

### Council Tax Band

B

### EPC Rating:

D

