



Bevan Close, Anslow Burton-On-Trent



Bevan Close, Anslow Burton-On-Trent, DE13 9QW

for sale shared ownership
£86,000



Property Description

Burchell Edwards are delighted to bring to market this recently completed two-bedroom property with a separate Lounge alongside a hallway. There is a Kitchen/Diner at the rear with double doors leading out to the patio and garden, perfect for summer nights and entertaining. With two generous built in storage spaces, 2 large double bedrooms, family bathroom and a downstairs WC, this home would be perfect for First Time Buyers, Families, Professionals, as well as those looking to downsize.

Shared Ownership is a great way to get onto the property ladder when you can't afford to buy a home on the open market. Depending on what you can afford, this scheme allows you to buy a share of a new home, and pay a reduced rent on the remaining share.

This well-presented home with contemporary and bright decor throughout is situated in a popular residential area just minutes from Burton-On-Trent's vibrant town centre. Gigabit broadband is available for fast, reliable Internet ideal for either home working or social use. This location offers a peaceful practicality but with the convenience of nearby town amenities. Get your foot on the property ladder with Shared Ownership!

Viewing of this property is essential, call our branch at Burchell Edwards today!

Entrance Hallway

Composite door to front elevation, central heating radiator, concrete flooring, stairs to first floor accommodation, doors to downstairs W.C and lounge.

Guest W.C

Double glazed window to front elevation, W.C, wash hand basin, central heating radiator and vinyl flooring.

Lounge

Double glazed window to front elevation with further window under neath, concrete flooring, doors to under stairs storage and kitchen.

Kitchen/ Diner

Double glazed window and patio doors to rear elevation, a range of wall and base units with work surface over incorporating a sink with drainer unit, gas hob, electric oven, combi boiler housed in cupboard, central heating radiator and vinyl flooring.

Landing

Loft access via hatch and all doors off.

Bedroom One

Two double glazed windows to front elevation, central heating radiator and door to over stairs storage.

Bedroom Two

Double glazed window to rear elevation and central heating radiator.

Bathroom

Bath, W.C, wash hand basin, extractor and vinyl flooring,

Rear Garden

Narrow garden with pathway leading to rear gate and fencing to boundaries.

Parking

Space for two vehicles.







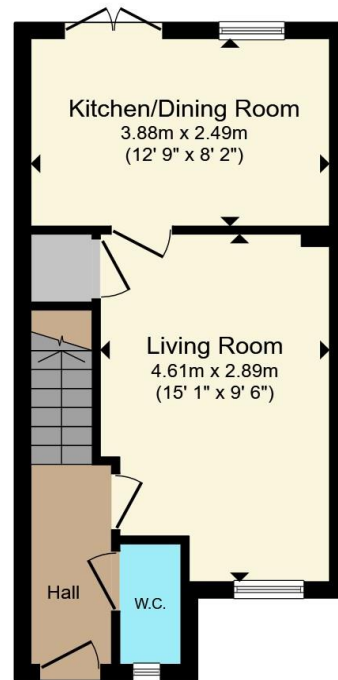

Ground Floor

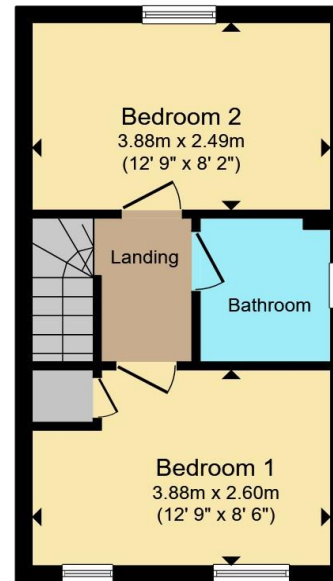

First Floor

Total floor area 58.0 m² (624 sq.ft.) approx

This floor plan is for illustrative purposes only. It is not drawn to scale. Any measurements, floor areas (including any total floor area), openings and orientation are approximate. No details are guaranteed, they cannot be relied upon for any purpose and they do not form part of any agreement. No liability is taken for any error, omission or misstatement. A party must rely upon its own inspection(s). Powered by www.propertybox.io



To view this property please contact Burchell Edwards on

T 01283 530 169
E burton@burchelledwards.co.uk

Britannia House Station Street
BURTON-ON-TRENT DE14 1AN

EPC Rating:
Exempt

Service Charge: Ask
Agent

Ground Rent:
Ask Agent

Tenure: Leasehold

view this property online burchelledwards.co.uk/Property/BUT211116

This is a Leasehold property. We are awaiting further details about the Term of the lease. For further information please contact the branch. Please note additional fees could be incurred for items such as Leasehold packs.



1. MONEY LAUNDERING REGULATIONS Intending purchasers will be asked to produce identification documentation at a later stage and we would ask for your co-operation in order that there will be no delay in agreeing the sale. 2. These particulars do not constitute part or all of an offer or contract. 3. The measurements indicated are supplied for guidance only and as such must be considered incorrect. Potential buyers are advised to recheck measurements before committing to any expense. 4. We have not tested any apparatus, equipment, fixtures, fittings or services and it is in the buyers interest to check the working condition of any appliances.

Burchell Edwards is a trading name of Connells Residential which is registered in England and Wales under company number 1489613, Registered Office is Cumbria House, 16-20 Hockliffe Street, Leighton Buzzard, Bedfordshire, LU7 1GN. VAT Registration Number is 500 2481 05.

See all our properties at www.burchelledwards.co.uk | www.rightmove.co.uk | www.zoopla.co.uk

Property Ref: BUT211116 - 0002