



**POOLE  
TOWNSEND**

# Lumley Road, Kendal

£550,000

4 2 5



- Desirable Residential Area
- No Onward Chain
- Exceptionally Versatile Accommodation
- Five Generous Reception Rooms
- Separate Utility Room
- Four Well-Proportioned Bedrooms
- Principal Bedroom With Dressing Area
- Beautifully Maintained Gardens
- Ample Off-Road Parking
- Council Tax Band: G



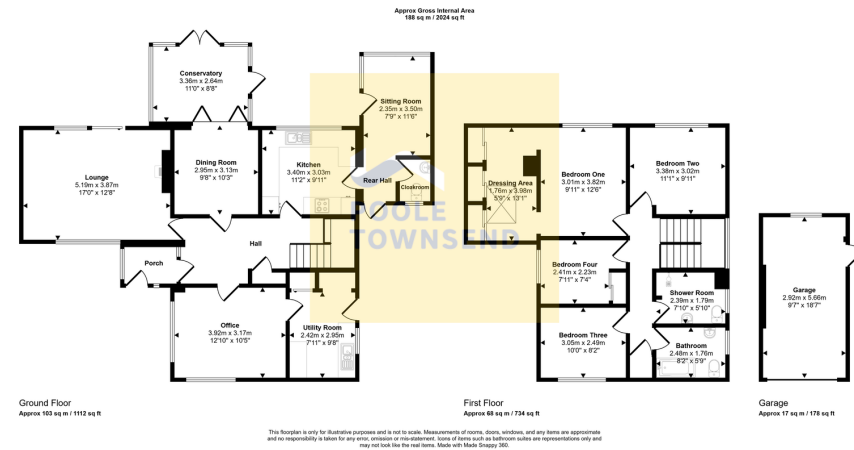

Occupying a highly sought-after position within one of Kendal's most desirable residential areas and enjoying an attractive backdrop of open fields and farmland, this deceptively spacious and versatile four-bedroom family home offers an exciting opportunity for buyers to modernise and personalise to their own tastes. Offered for sale with no onward chain, the well-maintained accommodation includes five generous reception rooms, providing flexible space for family living, entertaining, and home working. The property also benefits from a fitted kitchen with integrated appliances, a separate utility room, and a ground-floor cloakroom. To the first floor are four well-proportioned bedrooms, including a principal bedroom with dressing area, together with a family bathroom and separate shower room. Externally, the beautifully maintained gardens feature established planted borders and patio seating areas. Ample off-road parking and a single garage complete this

Visit us at  
[www.pooletownsend.co.uk](http://www.pooletownsend.co.uk)  
[enquiries@pooletownsend.co.uk](mailto:enquiries@pooletownsend.co.uk)

We are open  
 Monday – Friday 9.00 – 5.00  
 Saturday 9.00 – 1.00

Barrow 01229 811811  
 Ulverston 01229 588111  
 Grange 015395 33316  
 Kendal 01539 734455  
 Milnthorpe 015395 62044