

## £399,995

CARLTON ROAD, PORTCHESTER, PO16 8JW



- Three Bedrooms
- Entrance Porch
- Hallway
- Lounge
- Kitchen/Diner
- Conservatory
- First Floor Bath/Shower Room
- Gas Central Heating
- Double Glazing
- Off Street Parking
- 18' x 9' Detached Garage/Workshop
- Enclosed Rear Garden

### Portchester Office

92 West Street Portchester Hampshire PO16 9UQ

Tel: 02392 327 070 | E: [portchester@fenwicks-estates.co.uk](mailto:portchester@fenwicks-estates.co.uk)

[www.fenwicks-estates.co.uk](http://www.fenwicks-estates.co.uk)

Score	Energy rating	Current	Potential
92+	A		
81-91	B		
69-80	C		76 C
55-68	D	62 D	
39-54	E		
21-38	F		
1-20	G		

Property Reference : P2841

Council Tax Band: D

Floor Plans ( For illustrative purposes and not drawn exactly to scale)

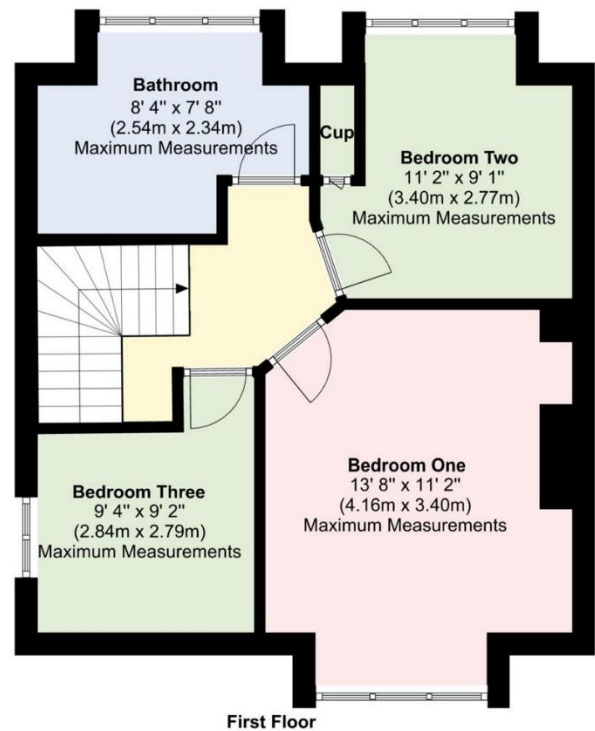
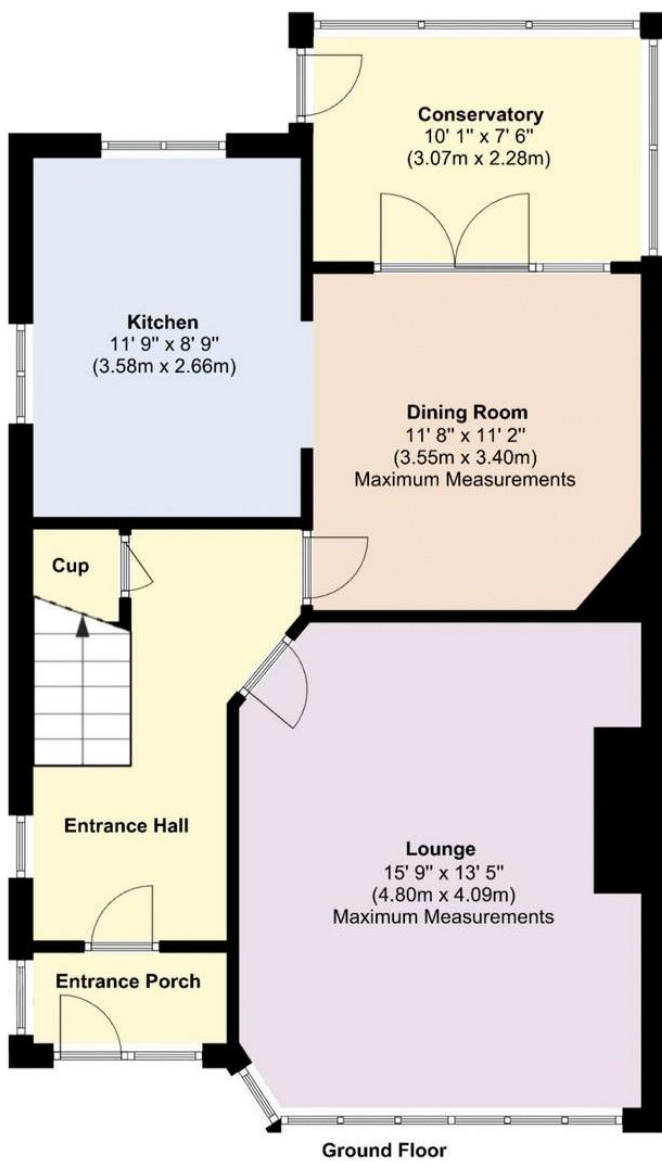

**Portchester Office**

92 West Street Portchester Hampshire PO16 9UQ  
 Tel: 02392 327 070 | E: portchester@fenwicks-estates.co.uk  
 www.fenwicks-estates.co.uk



## The Accommodation Comprises:-

UPVC part double glazed front door into:

### Entrance Porch:-

UPVC double glazed windows, tiled flooring and power socket. Further wooden internal door with lead light glazed panel lead to:

### Entrance Hall:-

UPVC double glazed window to side elevation, radiator, oak return staircase to first floor, under stairs storage cupboard and flat ceiling. Part glazed doors to:



### Lounge:-

15' 9" x 13' 5" (4.80m x 4.09m) Maximum Measurements

UPVC double glazed window to front elevation with views towards Portsmouth Harbour, radiator, TV aerial point, feature stone fireplace with wooden mantle shelf and flat ceiling.



### Dining Room:-

11' 8" x 11' 2" (3.55m x 3.40m) Maximum Measurements

Space for table and chairs, radiator, feature marble fireplace, flat ceiling and UPVC double glazed doors to conservatory. Walkway to:



## Portchester Office

92 West Street Portchester Hampshire PO16 9UQ

Tel: 02392 327 070 | E: portchester@fenwicks-estates.co.uk

www.fenwicks-estates.co.uk

## Kitchen:-

11' 9" x 8' 9" (3.58m x 2.66m)

Dual aspect room with UPVC double glazed windows to side and rear elevations overlooking the garden, fitted range of matching base and eye level units, wooden worktops, one and a half bowl sink unit with a mixer tap, glass upstands, built-in under counter fridge and freezer, range style cooker (to remain) with extractor canopy above, radiator, wall mounted gas central heating boiler, wooden flooring and flat ceiling with spotlighting inset.



## Conservatory:-

10' 1" x 7' 6" (3.07m x 2.28m)

Windows and doors overlooking and accessing the rear garden, power and light connected, space and plumbing for washing machine and slimline dishwasher, roll top worksurface and tiled flooring.



## First Floor Landing:-

UPVC double glazed to side elevation, flat ceiling and access to loft. Doors to:

### Bedroom One:-

13' 8" x 11' 2" (4.16m x 3.40m) Maximum Measurements

UPVC double glazed window to front elevation with views towards Portsmouth Harbour and beyond, radiator, flat and sloping ceiling.



## Portchester Office

92 West Street Portchester Hampshire PO16 9UQ

Tel: 02392 327 070 | E: portchester@fenwicks-estates.co.uk

www.fenwicks-estates.co.uk



**Bedroom Two:-**  
11' 2" x 9' 1" (3.40m x 2.77m) Maximum Measurements

UPVC double glazed window to rear elevation, flat and sloping ceiling with spotlighting inset, radiator and built-in storage cupboard housing hot water tank.



**Bedroom Three:-**  
9' 4" x 9' 2" (2.84m x 2.79m) Maximum Measurements

UPVC double glazed window to side elevation, flat and sloping ceiling with spotlighting inset, radiator and eaves storage recess.



**Bathroom & Shower Room:-**  
8' 4" x 7' 8" (2.54m x 2.34m) Maximum Measurements

A dual aspect room with UPVC double glazed windows to side and rear elevations, white suite comprising: panelled bath with mixer tap, separate shower cubicle with rainfall shower and handheld shower attachment, wash hand basin inset vanity unit with mixer tap, close coupled W.C, part tiled walls, flat and sloping ceiling with spotlights inset, radiator, tiled flooring and extractor.



**Outside:-**

Front garden is laid to lawn, shrub borders and brick retaining walls and driveway. Wrought iron gates lead to:

**Portchester Office**

92 West Street Portchester Hampshire PO16 9UQ

Tel: 02392 327 070 | E: portchester@fenwicks-estates.co.uk

www.fenwicks-estates.co.uk





### Garage/Workshop:

18' 0" x 9' 0" (5.48m x 2.74m)

Detached, brick built, up and over door, window and side courtesy door garden.



### Rear Garden:-

Enclosed, split level, two patio areas for entertainment purposes, lawn, shrub borders, outside power socket, shed and green house (to remain).



### Portchester Office

92 West Street Portchester Hampshire PO16 9UQ

Tel: 02392 327 070 | E: portchester@fenwicks-estates.co.uk

www.fenwicks-estates.co.uk

**Disclaimer:** These particulars are set out as a general outline in accordance with the Consumer Protection from Unfair Trading Regulations 2008 (CPR's) and Business Protection from Misleading Marketing Regulations 2008 (BPR's) only for the guidance of intending purchasers or lessees, and do not constitute any part of an offer or contract. Details are given without any responsibility, and any intending purchasers, lessees or third parties should not rely on them as statements or representations of fact, but must satisfy themselves by inspection or otherwise as to the correctness of each of them.

We have not carried out a structural survey and the services, appliances and specific fittings have not been tested. All photographs, measurements, floor plans and distances referred to are given as a guide only and should not be relied upon for the purchase of carpets or any other fixtures or fittings. Gardens, roof terraces, balconies and communal gardens as well as tenure and lease details cannot have their accuracy guaranteed for intending purchasers. Lease details, service ground rent (where applicable) are given as a guide only and should be checked and confirmed by your solicitor prior to exchange of contracts.

No person in the employment of Fenwicks Estates Ltd has any authority to make any representation or warranty whatever in relation to this property. Purchase prices, rents or other prices quoted are correct at the date of publication and, unless otherwise stated, exclusive of VAT.

**Data Protection:** We retain the copyright in all advertising material used to market this Property.

**Money Laundering Regulations 2017:** Intending purchasers will be required to produce identification documentation once an offer is accepted

Your home is at risk if you do not keep up repayments on mortgage or other secured loans.

## Portchester Office

92 West Street Portchester Hampshire PO16 9UQ

Tel: 02392 327 070 | E: portchester@fenwicks-estates.co.uk

[www.fenwicks-estates.co.uk](http://www.fenwicks-estates.co.uk)

